

Precision in Every Dimension

Products Catalogue 2023





Precision in Every Dimension

Tubular Cable Lugs

Standard Type, With Inspection Hole
for Copper Conductors

Material: E-copper
Surface: Tin Plated

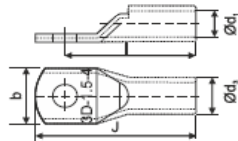

Con-Bolt	3D	d1	d3	b	J	Std Pkg	Price/
mm ² -Φ	Cat.No.						each
1.5-4	3D-2622	1.8	3.7	8	16	3000	4.25
1.5-5	3D-2623	1.8	3.7	8	16	3000	4.05
1.5-6	3D-2624	1.8	3.7	10	18	3000	4.36
2.5-4	3D-2625	2.4	4.0	8	18	3000	4.67
2.5-5	3D-2627	2.4	4.0	8	18	3000	4.47
2.5-6	3D-2628	2.4	4.0	10	20	3000	4.77
2.5-8	3D-2629	2.4	4.0	11	24	2000	5.31
4-5	3D-2630	3.1	4.8	10	20	2000	6.43
4-5	3D-2632	3.1	4.8	9	20	2000	6.40
4-6	3D-2631	3.1	4.8	10	20	2000	6.08
4-8	3D-2633	3.1	4.8	12	24	2000	7.14
6-5	3D-2634	3.8	5.5	10	23	2000	8.88
6-6	3D-2635	3.8	5.5	10	23	2000	8.53
6-8	3D-2637	3.8	5.5	12	27	1600	9.66
6-10	3D-2638	3.8	6.2	16	32	1000	11.51
10-5	3D-2642	4.5	6.2	12	25	1600	11.34
10-6	3D-2643	4.5	6.2	12	25	1600	10.50
10-8	3D-2645	4.5	6.2	12	27	1200	10.83
16-5	3D-2652	5.4	7.1	12	30	1000	15.72
16-6	3D-2653	5.4	7.1	12	30	1000	14.64
16-8	3D-2655	5.4	7.1	12	32	1000	14.74
25-6	3D-2663	6.8	8.8	13	30	600	20.93
25-8	3D-2665	6.8	8.8	13	32	600	21.41
25-8	3D-2666	6.8	8.8	16	37	600	25.15
25-10	3D-2668	6.8	8.8	16	37	600	23.91
25-12	3D-2670	6.8	8.8	18	41	400	26.43
35-6	3D-2673	8.2	10.6	15	35	400	36.31
35-6	3D-2674	8.2	10.6	15	38	400	39.45
35-8	3D-2676	8.2	10.6	15	35	400	35.06
35-8	3D-2677	8.2	10.6	15	38	400	38.20
35-10	3D-2679	8.2	10.6	15	40	400	38.30
35-10	3D-2680	8.2	10.6	18	38	400	35.19
35-10	3D-2681	8.2	10.6	18	41	400	38.19
35-12	3D-2683	8.2	10.6	20	45	300	40.29
50-6	3D-2687	10.0	12.8	18	43	250	62.19

Con-Bolt	3D	d1	d3	b	J	Std Pkg	Price/
mm ² -Φ	Cat.No.						each
50-8	3D-2689	10.0	12.8	18	43	250	57.83
50-10	3D-2691	10.0	12.8	18	43	250	55.67
50-12	3D-2695	10.0	12.8	18	47	250	60.78
70-6	3D-2697	11.2	14.7	21	50	150	102.67
70-8	3D-2698	11.2	14.7	21	50	150	96.25
70-10	3D-2699	11.2	14.7	21	50	150	93.52
70-12	3D-2700	11.2	14.7	21	50	150	89.41
70-16	3D-2705	11.2	14.7	28	57	100	103.07
95-8	3D-2708	13.5	17.4	25	55	100	137.65
95-10	3D-2709	13.5	17.4	25	55	100	128.74
95-12	3D-2712	13.5	17.4	25	55	100	125.73
95-14	3D-2713	13.5	17.4	28	61	100	144.50
95-16	3D-2715	13.5	17.4	28	61	100	138.33
120-8	3D-2716	15.0	19.4	28	60	75	189.38
120-10	3D-2717	15.0	19.4	28	60	75	177.87
120-12	3D-2719	15.0	19.4	28	60	75	172.78
120-14	3D-2721	15.0	19.4	28	64	75	189.54
120-16	3D-2722	15.0	19.4	28	64	75	183.74
150-8	3D-2726	16.5	21.2	30	69	50	257.36
150-10	3D-2727	16.5	21.2	30	69	50	253.57
150-12	3D-2729	16.5	21.2	30	69	50	237.25
150-16	3D-2733	16.5	21.2	30	69	50	236.69
150-20	3D-2734	16.5	21.2	34	79	50	266.49
185-10	3D-2736	18.5	23.5	34	78	40	342.06
185-12	3D-2737	18.5	23.5	34	78	40	336.26
185-14	3D-2738	18.5	23.5	34	78	40	330.72
185-16	3D-2741	18.5	23.5	34	78	40	310.29
240-10	3D-2747	21.0	26.5	38	92	25	506.40
240-12	3D-2748	21.0	26.5	38	92	25	499.96
240-14	3D-2749	21.0	26.5	38	92	25	493.79
240-16	3D-2750	21.0	26.5	38	92	25	486.78
240-20	3D-2751	21.0	26.5	38	92	25	470.06
300-12	3D-2754	23.5	30.0	43	101	20	732.91
300-14	3D-2755	23.5	30.0	43	101	20	725.63
300-16	3D-2756	23.5	30.0	43	101	20	717.35
300-20	3D-2757	23.5	30.0	43	101	20	697.68
400-12	3D-2760	26.8	34.8	50.1	114	10	1177.81
400-14	3D-2761	26.8	34.8	50.1	114	10	1170.32
400-16	3D-2762	26.8	34.8	50.1	114	10	1160.25
400-16	3D-2763	26.8	34.8	50.1	105	10	1061.47
500-16	3D-2769	30.0	39.0	56	124	10	1605.95
500-20	3D-2770	30.0	39.0	56	124	10	1578.94
630-16	3D-2773	35.0	45.0	65	144	6	2441.59
630-20	3D-2774	35.0	45.0	65	144	6	2388.06

"NOTE: Certain catalogue nos. may have been discontinued from production, Please consult our sales department for an alternative."



Precision in Every Dimension

Tubular Cable Lugs
Extra Long Type,
W/O Inspection Hole
Material: E-copper
Surface: Tin Plated

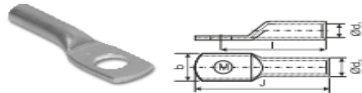

Con-Bolt	3D	d1	d3	b	J	Std Pkg	Price/
mm ² -Φ	Cat.No.						each
25-8	3D-2340	7.0	9.0	13	41	400	25.90
25-10	3D-2340A	7.0	9.0	13	41	400	25.50
35-8	3D-2341	8.0	10.6	15	48	300	48.08
35-10	3D-2341A	8.0	10.6	15	48	300	46.02
50-8	3D-2342	9.2	12.2	17	59	200	79.83
50-10	3D-2342A	9.2	12.2	17	59	200	77.41
50-12	3D-2342B	9.2	12.2	17	59	200	73.84
70-10	3D-2343	11.5	15.0	21	66	100	126.98
70-12	3D-2343A	11.5	15.0	21	66	100	122.60
95-12	3D-2344	12.8	17.0	24	74	80	189.05
95-16	3D-2344A	12.8	17.0	24	74	80	179.00
120-12	3D-2345	14.8	19.6	28	82	50	273.81
120-16	3D-2345A	14.8	19.6	28	82	50	268.36
150-12	3D-2346	16.0	21.2	30	86	40	338.93
150-16	3D-2346A	16.0	21.2	30	86	40	333.81
185-12	3D-2347	18.0	24.0	34	95	25	490.73
185-16	3D-2347A	18.0	24.0	34	95	25	487.03
185-20	3D-2347B	18.0	24.0	34	95	25	468.98
240-16	3D-2348	22.0	28.0	40	112	20	697.44
240-20	3D-2348A	22.0	28.0	40	112	20	678.84

Butt Connectors

For Copper Conductors
With & Non Insulating Sleeve
Insulation - Hard PVC
Material: E-copper
Surface: Tin Plated

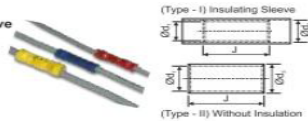

Con-Bolt	3D	d1	d3	J	Std Pkg	Price/
mm ² -Φ	Cat.No.					each
1.5-TYPE-11	3D-1845	1.6	3.2	15	5000	4.42
2.5-TYPE-11	3D-1846	2.4	4.0	15	4000	5.39
4-TYPE-11	3D-1847	3.5	5.5	15	3000	8.23
1.5-TYPE-1	3D-3762	1.6	3.2	25	1600	6.72
2.5-TYPE-1	3D-3763	2.4	4.0	25	1200	7.87
4-TYPE-1	3D-3764	3.5	5.5	27	800	11.66

Tubular Cable Lugs

Copper Light Duty W/O Inspection Hole
for Aluminum Conductors
Material: E-Copper
Surface: Tin Plate

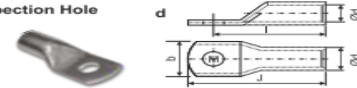

Con-Bolt	3D	d1	d3	b	J	Std Pkg	Price/
mm ² -Φ	Cat.No.						each
2.5-5	3D-2501	2.3	3.8	9	20	3000	4.11
4-6	3D-2502	3.1	4.8	11	22	2000	6.11
6-6	3D-2503	3.8	5.5	11	24	1600	7.84
10-6	3D-2504	4.5	6.2	11	24	1600	9.69
16-6	3D-2505	5.4	7.1	11	30	1000	13.55
25-6	3D-2506	7.0	9.0	13	37	400	24.18
35-6	3D-2507	8.0	10.0	15	37	400	27.76
35-8	3D-2508	8.0	10.0	15	37	400	26.43
50-6	3D-2509	9.2	11.2	16	45	250	38.94
50-8	3D-2510	9.2	11.2	16	45	250	37.53
50-10	3D-2511	9.2	11.2	16	45	250	35.41
70-8	3D-2512	11.5	13.8	20	56	150	67.95
70-10	3D-2513	11.5	13.8	20	56	150	64.86
70-12	3D-2514	11.5	13.8	20	56	150	63.56
95-10	3D-2515	12.8	15.6	23	58	100	92.26
95-12	3D-2516	12.8	15.6	23	58	100	89.20
120-10	3D-2517	14.8	17.8	26	62	75	124.78
120-12	3D-2518	14.8	17.8	26	62	75	118.82
120-16	3D-2519	14.8	17.8	26	62	75	115.41
150-10	3D-2520	16.0	19.6	28	70	50	168.36
150-12	3D-2521	16.0	19.6	28	70	50	164.57
150-16	3D-2522	16.0	19.6	28	70	50	157.96
185-12	3D-2523	18.0	22.0	32	83	40	247.29
185-16	3D-2524	18.0	22.0	32	83	40	239.92
240-16	3D-2525	22.0	26.0	38	97	25	343.58
240-20	3D-2526	22.0	26.0	38	97	25	350.13
300-16	3D-2527	24.0	28.7	42	103	20	472.38
300-20	3D-2528	24.0	28.7	42	103	20	459.76
400-20	3D-2529	28.0	33.2	49	116	15	710.47
500-20	3D-2530	30.0	36.0	53	122	10	936.69
630-20	3D-2531	35.0	41.5	61	137	10	1337.68

"NOTE: Certain catalogue nos. may have been discontinued from production, Please consult our sales department for an alternative."



Compression Type 
Aluminum Tubular Terminal Ends for Crimping to Aluminum Conductors
 Material: Aluminum
 Surface: Natural

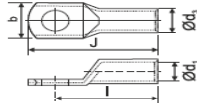

Compression Type
Aluminum Tubular In-Line Connectors for Crimping to Aluminum Conductors
 Material: Aluminum
 Surface: Natural

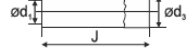

Con-Bolt mm ² -Φ	3D Cat.No.	d1	d3	b	J	Std Pkg	Price/ each
2.5-3	3D-2535	2.6	5.5	6.7	18	2000	1.93
4-4	3D-2536	2.9	5.5	7.2	18	2000	1.85
4-5	3D-2537	2.9	5.5	12.0	21	2000	2.03
6-6	3D-2538	3.5	5.5	12.0	23	1600	2.13
10-6	3D-2539	4.4	7.2	9.7	30	1000	3.82
10-8	3D-2540	4.4	7.2	15.0	30	800	3.56
16-6	3D-2541	5.4	8.3	11.4	37	600	5.29
16-8	3D-2542	5.4	8.3	11.7	37	600	5.84
16-10	3D-2543	5.4	8.3	18.0	38	400	5.03
25-6	3D-2544	7.0	9.7	13.7	44	400	7.22
25-8	3D-2545	7.0	9.7	13.7	44	400	8.06
25-10	3D-2546	7.0	9.7	14.0	44	400	6.91
25-12	3D-2547	7.0	9.7	20.0	44	300	6.62
35-6	3D-2548	8.0	10.8	15.4	46	300	8.50
35-8	3D-2549	8.0	10.8	15.4	46	300	8.50
35-10	3D-2550	8.0	10.8	15.7	46	300	8.50
50-8	3D-2551	9.3	13.0	18.3	54	200	15.25
50-10	3D-2552	9.3	13.0	18.3	54	200	15.25
50-12	3D-2553	9.3	13.0	18.5	54	200	14.06
70-8	3D-2554	11.3	15.5	21.8	60	100	23.63
70-10	3D-2555	11.3	15.5	21.8	60	100	22.32
70-12	3D-2556	11.3	15.5	21.8	60	100	21.02
95-10	3D-2557	13.2	17.4	24.8	64	80	27.27
95-12	3D-2558	13.2	17.4	24.8	64	80	27.27
95-16	3D-2559	13.2	17.4	24.8	64	80	25.64
120-10	3D-2560	14.7	19.6	28.0	73	50	40.73
120-12	3D-2561	14.7	19.6	28.0	73	50	39.46
120-16	3D-2562	14.7	19.6	28.0	73	50	39.46
150-10	3D-2563	16.4	21.5	30.8	79	40	50.92
150-12	3D-2564	16.4	21.5	30.8	79	40	48.31
150-16	3D-2565	16.4	21.5	30.8	79	40	48.31
185-10	3D-2566	18.4	24.0	34.5	84	40	63.52
185-12	3D-2567	18.4	24.0	34.5	84	40	64.83
185-16	3D-2568	18.4	24.0	34.5	84	40	63.52
240-12	3D-2569	21.0	28.0	40.0	102	30	110.52
240-16	3D-2570	21.0	28.0	40.0	102	30	107.90
300-16	3D-2571	23.8	31.0	45.0	115	20	142.91
300-20	3D-2572	23.8	31.0	45.0	115	20	140.30
400-20	3D-2573	26.8	35.5	50.8	130	15	215.85
500-20	3D-2574	29.5	41.0	57.8	140	10	361.20
630-20	3D-2575	34.85	46.0	65.8	154	5	363.54
800-BLK	3D-2576	39.0	51.0	73.3	180	20	544.39
1000-BLK	3D-2577	43.0	57.0	81.5	220	15	1000.82

Con-Bolt mm ² -Φ	3D Cat.No.	d1	d3	J	Std Pkg	Price/ each
2.5	3D-2578	2.6	5.5	16	2000	1.77
4	3D-2579	2.9	5.5	16	2000	1.69
6	3D-2580	3.5	5.5	20	1600	2.31
10	3D-2581	4.4	7.2	20	1000	2.72
16	3D-2582	5.4	8.3	26	600	3.96
25	3D-2583	7.0	9.7	34	400	5.96
35	3D-2584	8.0	10.8	39	300	7.71
50	3D-2585	9.3	13.0	44	200	13.10
70	3D-2586	11.3	15.5	53	100	21.16
95	3D-2587	13.2	17.4	58	80	26.27
120	3D-2588	14.7	19.6	63	50	36.47
150	3D-2589	16.4	21.5	67	40	44.00
185	3D-2590	18.4	24.0	72	40	57.98
240	3D-2591	21.0	28.0	86	30	97.35
300	3D-2592	23.8	31.0	96	20	124.21
400	3D-2593	26.8	35.5	110	10	198.11
500	3D-2594	29.9	41.0	111	5	290.19
630	3D-2595	34.9	46.0	134	5	400.17
800	3D-2596	39.0	51.0	153	15	552.15
1000	3D-2597	43.0	57.0	201	10	839.23

IS 8309  **ALUMINUM LUGS**
 ALUMINUM LUGS as per ISI specification can be supplied on Extra charges.

Tubular Cable Lugs
 Extra wide palm type
 With inspection Hole
 Material - E Copper
 Surface - Tin Plated

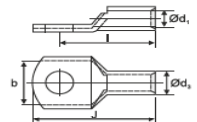

Con-Bolt mm ² -Φ	3D Cat.No.	d1	d3	b	J	Std Pkg	Price/ each
10-10	3D-2648	4.7	7.1	16	32	800	25.55
16-10	3D-2658	5.5	7.9	16	36	600	24.24
16-12	3D-2659	5.5	8.5	18	40	400	19.51

"NOTE: Certain catalogue nos. may have been discontinued from production, Please consult our sales department for an alternative."



Terminal Ends, Ring Type

Standard Type, W/O Sleeve,
Braze Seam
Material: E-Copper
Surface: Tin Plated

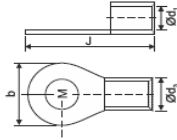

Con-Bolt mm ² -Φ	3D Cat.No.	d1	d3	b	J	Std Pkg	Price/ each
0.5to1.5-3	3D-1247	1.6	3.2	6.0	14	5000	2.42
0.5to1.5-3.5	3D-1269	1.6	3.2	6.0	14	5000	2.38
0.5to1.5-4	3D-1241	1.6	3.2	6.0	14	5000	2.32
0.5to1.5-4	3D-1258	1.6	3.2	6.8	13	5000	2.30
0.5to1.5-4	3D-1246	1.6	3.2	8.0	16	5000	2.61
0.5to1.5-4	3D-1261	1.6	3.2	7.0	14.5	5000	2.41
0.5to1.5-5	3D-1262	1.6	3.2	8.0	16	5000	2.26
0.5to1.5-5	3D-1267	1.6	3.2	10.0	18	4000	3.25
0.5to1.5-6	3D-1224	1.6	3.2	10.0	18	5000	2.90
0.5to1.5-6	3D-1268	1.6	3.2	12.0	18	4000	3.61
2.5-4	3D-1296	2.3	3.9	8.0	16	5000	2.90
2.5-5	3D-1304	2.3	3.9	8.0	16	5000	2.80
2.5-5	3D-1310	2.3	3.9	10.0	18	4000	3.58
2.5-6	3D-1342	2.3	3.9	10.0	18	4000	3.09
2.5-6	3D-1305	2.3	3.9	12.0	22	3000	4.59
2.5-8	3D-1307	2.3	3.9	12.0	22	3000	4.04
2.5-10	3D-1287	2.3	3.9	16.0	25	2000	5.44
2.5-12	3D-1438	2.3	3.9	18.0	29	1000	6.24
4to6-4	3D-1432	3.5	5.5	8.0	17	3000	4.83
4to6-5	3D-1431	3.5	5.5	8.0	17	3000	4.68
4to6-5	3D-1408	3.5	5.5	10.0	19	2000	5.79
4to6-6	3D-1415	3.5	5.5	12.0	20	2000	6.13
4to6-6	3D-1416	3.5	5.5	12.0	20	2000	5.74
4to6-8	3D-1417	3.5	5.5	12.0	20	2000	6.66
4to6-8	3D-1421	3.5	5.5	14.0	25.5	1600	7.58
4to6-10	3D-1427	3.5	5.5	16.0	30	1200	9.39
4to6-12	3D-1430	3.5	5.5	18.0	30	1000	9.35
10-5	3D-1460	4.3	6.3	10.0	20	2000	7.59
10-6	3D-1465	4.3	6.3	12.0	23	1600	8.11
10-8	3D-1466	4.3	6.3	16.0	27	1200	9.80
10-10	3D-1461	4.3	6.3	18.0	30	1000	11.62
10-12	3D-1462	4.3	6.3	22.0	34	800	13.77
16-5	3D-1516	5.6	8.0	10.0	24	1000	11.33

Con-Bolt mm ² -Φ	3D Cat.No.	d1	d3	b	J	Std Pkg	Price/ each
16-6	3D-1511	5.6	8.0	12.0	26	1000	12.99
16-8	3D-1512	5.6	8.0	16.0	30	800	14.75
16-10	3D-1514	5.6	8.0	18.0	33	600	17.16
16-10	3D-1520	5.6	8.0	22.0	35	400	20.75
16-12	3D-1515	5.6	8.0	22.0	35	400	19.18
25-6	3D-1561	7.5	11.1	12.0	31	400	28.37
25-6	3D-1557	7.5	11.1	16.0	30	400	31.27
25-6	3D-1558	7.5	11.1	16.0	33	400	33.43
25-8	3D-1556	7.5	11.1	12.0	31	400	27.73
25-8	3D-1552	7.5	11.1	16.0	30	400	29.64
25-8	3D-1554	7.5	11.1	16.0	33	400	30.94
25-10	3D-1553	7.5	11.1	16.0	30	400	27.80
25-10	3D-1559	7.5	11.1	18.0	34	400	33.34
25-10	3D-1560	7.5	11.1	22.0	42	300	43.00
25-12	3D-1555	7.5	11.1	22.0	42	300	40.83
35-6	3D-1584	9.0	12.6	16.0	31	400	36.49
35-8	3D-1581	9.0	12.6	16.0	31	400	32.98
35-8	3D-1585	9.0	12.6	18.0	36	400	39.01
35-10	3D-1582	9.0	12.6	18.0	36	300	37.51
35-10	3D-1586	9.0	12.6	22.0	42	300	47.58
35-12	3D-1583	9.0	12.6	22.0	42	300	44.10
50-8	3D-1609	10.5	14.1	18.0	43	200	56.07
50-10	3D-1607	10.5	14.1	18.0	43	200	54.71
50-10	3D-1610	10.5	14.1	22.0	43	200	56.88
50-12	3D-1608	10.5	14.1	24.0	48	200	61.22
70-10	3D-1637	12.0	16.0	22.0	47	150	77.01
70-12	3D-1636	12.0	16.0	22.0	47	150	75.07
95-10	3D-1651	13.5	18.1	22.0	46	100	99.24
95-10	3D-1652	13.5	18.1	24.0	50	100	100.94
95-12	3D-1650	13.5	18.1	24.0	50	100	104.47

"NOTE: Certain catalogue nos. may have been discontinued from production, Please consult our sales department for an alternative."



Tubular Cable Lugs

Compression Type, Aluminium Terminal ends, for Crimping to XLPE Conductors
Material : Aluminium
Surface : Natural

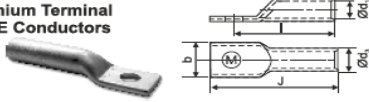

Con-Bolt	3D	d1	d3	b	J	Std Pkg	Price/each
mm ² -Φ	Cat.No.						
16-6	3D-4000	5.0	8.3	12.0	66	400	12.70
25-8	3D-4001	7.2	9.6	14.0	66	200	11.89
35-8	3D-4002	8.3	11.1	16.0	76	150	16.75
50-10	3D-4003	10.1	13.5	19.5	78	100	23.76
70-10	3D-4004	11.2	14.5	20.5	93	80	36.75
95-12	3D-4005	12.0	16.9	23.5	107	50	55.79
120-12	3D-4006	13.7	19.0	26.5	111	40	70.11
150-12	3D-4007	15.1	21.1	29.5	125	25	97.50
150-16	3D-4008	15.1	21.1	29.5	125	25	95.52
185-12	3D-4009	16.6	23.9	33.0	128	20	133.83
185-16	3D-4010	16.6	23.9	33.0	128	20	131.28
240-12	3D-4012	19.3	27.2	37.5	141	15	181.37
240-16	3D-4013	19.3	27.2	37.5	141	15	178.59
300-20	3D-4014	21.8	30.2	42.0	154	10	228.04
300-12	3D-4015	21.8	30.2	42.0	154	15	233.62
300-16	3D-4016	21.8	30.2	42.0	154	15	230.99
400-20	3D-4017	25.0	34.8	48.0	184	40	363.46
500-20	3D-4018	28.2	39.1	54.0	202	25	525.22
630-BLK	3D-4019	31.7	44.4	61.0	222	20	734.17
800-BLK	3D-4020	35.7	49.5	68.0	247	15	1018.17
1000-BLK	3D-4021	41.0	56.0	77.5	277	10	1402.16

Terminal Ends, Fork Type

Standard Type, Brazed Seam
Material: E-Copper
With PVC Sleeve
Surface: Tin Plated

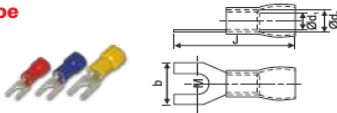

Con-Bolt	3D	d1	d3	b	J	Std Pkg	Price/each
mm ² -Φ	Cat.No.						
0.5to1.5-3	3D-3640	1.6	3.2	6.0	19	2000	3.05
0.5to1.5-3.5	3D-3641	1.6	3.2	6.0	19	2000	2.99
0.5to1.5-3.5	3D-3639	1.6	3.2	6.8	19	2000	2.74
0.5to1.5-4	3D-3647	1.6	3.2	6.5	20	2000	3.06
2.5-3.5	3D-3657	2.3	3.9	6.5	20	2000	3.18
2.5-5	3D-3664	2.3	3.9	10.0	24	1600	4.75
4to6-3.5	3D-3675	3.5	5.5	6.0	24	1000	5.55
4to6-4	3D-3679	3.6	5.6	8.0	27	1000	6.94
4to6-5	3D-3721	3.5	5.5	8.0	25	1000	5.99
0.5to1.5-3.5	3D-3685	1.6	3.2	6.8	19	2000	3.72
2.5-3.5	3D-3687	2.3	3.9	6.5	20	2000	4.30
4to6-3.5	3D-3690	3.5	5.5	6.0	24	1000	6.98

Terminal Ends, Fork Type

Standard Type, Brazed Seam
Material: E-Copper
Surface: Tin Plated

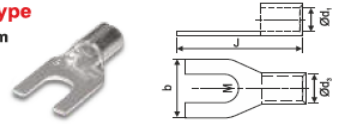

Con-Bolt	3D	d1	d3	b	J	Std Pkg	Price/each
mm ² -Φ	Cat.No.						
0.5to1.5-3	3D-1923	1.6	3.2	6.0	14	5000	2.54
0.5to1.5-3.5	3D-1699	1.6	3.2	6.8	14.5	5000	2.13
0.5to1.5-3.5	3D-1700	1.6	3.2	6.0	14	5000	2.49
0.5to1.5-4	3D-1704	1.6	3.2	6.5	15	5000	2.61
2.5-3.5	3D-1884	2.3	3.9	6.5	15	5000	2.56
4to6-3.5	3D-1907	3.5	5.5	6.0	15	3000	4.36
4to6-4	3D-1914	3.6	5.6	8.0	18	2000	5.86
4to6-5	3D-1734	3.5	5.5	8.0	17	2000	5.26
16-5	3D-1922	5.3	7.7	10.0	26	1000	12.62

Connectors, Non-Tention Type

Standard Type with Cable Stopper
Material: E-copper
Surface: Tin Plated

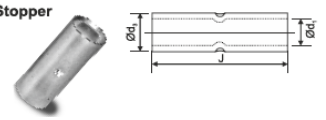

Con-Bolt	3D	d1	d3	J	Std Pkg	Price/each
mm ² -Φ	Cat.No.					
1.5	3D-2802	1.8	3.7	12	2000	3.63
2.5	3D-2804	2.4	4.0	15	2000	4.32
4	3D-2806	3.1	4.8	15	2000	5.20
6	3D-2808	3.8	5.5	15	2000	5.95
10	3D-2810	4.5	6.2	20	1600	8.83
16	3D-2812	5.4	7.1	20	1200	10.28
25	3D-2817	6.8	8.8	32	400	22.99
35	3D-2820	8.2	10.6	36	300	36.84
50	3D-2823	10.0	12.8	40	200	57.01
70	3D-2826	11.2	14.7	40	100	81.20
95	3D-2828	13.5	17.4	45	100	121.11
120	3D-2830	15.0	19.4	45	80	151.93
150	3D-2833	16.5	21.2	55	50	217.09
185	3D-2836	18.5	23.5	65	40	303.31
240	3D-2838	21.0	26.5	80	25	462.76
300	3D-2841	23.5	30.0	85	20	653.73
400	3D-2843	26.8	34.8	91	10	992.43

"NOTE: Certain catalogue nos. may have been discontinued from production, Please consult our sales department for an alternative."



Terminal Ends, Ring Type

Standard Type, With Insulating Sleeve
 Material: E-Copper With PVC Sleeve
 Surface: Tin Plated

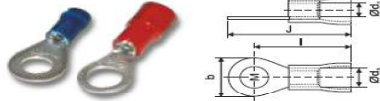

Con-Bolt	3D	d1	d3	b	J	Std Pkg	Price/ each
mm ² -Φ	Cat.No.						
0.5 to 1.5-3	3D-3078	1.6	3.2	6	19	2000	2.96
0.5 to 1.5-3.5	3D-3079	1.6	3.2	6	19	2000	2.92
0.5 to 1.5-4	3D-3080	1.6	3.2	6	19	2000	2.85
0.5 to 1.5-4	3D-3083	1.6	3.2	6.8	18	2000	2.96
0.5 to 1.5-4	3D-3085	1.6	3.2	8	21	2000	3.39
0.5 to 1.5-4	3D-3087	1.6	3.2	7	19.5	2000	2.94
0.5 to 1.5-5	3D-3086	1.6	3.2	8	21	2000	3.24
0.5 to 1.5-5	3D-3074	1.6	3.2	10	23	2000	3.87
0.5 to 1.5-6	3D-3089	1.6	3.2	10	23	2000	3.58
0.5 to 1.5-6	3D-3090	1.6	3.2	12	23	2000	4.26
2.5-4	3D-3129	2.3	3.9	8	21	2000	3.82
2.5-5	3D-3130	2.3	3.9	8	21	2000	3.67
2.5-6	3D-3132	2.3	3.9	10	23	2000	4.13
2.5-6	3D-3134	2.3	3.9	12	27	1200	5.34
2.5-8	3D-3135	2.3	3.9	12	27	1200	4.90
2.5-10	3D-3138	2.3	3.9	16	30	1000	6.30
2.5-12	3D-3140	2.3	3.9	18	34	1000	7.18
4 to 6-4	3D-3196	3.5	5.5	8	25	1000	6.26
4 to 6-5	3D-3197	3.5	5.5	8	25	1000	6.09
4to6-5	3D-3199	3.5	5.5	10	27	1000	6.94
4to6-5	3D-3204	3.5	5.5	12	30	800	8.67
4to6-6	3D-3202	3.5	5.5	12	28	800	7.41
4to6-6	3D-3205	3.5	5.5	12	30	800	7.92
4to6-8	3D-3203	3.5	5.5	12	28	800	6.89
4to6-8	3D-3207	3.5	5.5	14	33.5	800	8.94
4to6-10	3D-3210	3.5	5.5	16	38	600	10.93
4to6-12	3D-3213	3.5	5.5	18	38	600	10.88

Terminal Ends, Ring Type

Double Grip With Insulating Sleeve
 Material: E-Copper + PVC
 Surface: Tin Plated

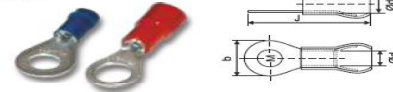

Con-Bolt	3D	d1	d3	b	J	Std Pkg	Price/ each
mm ² -Φ	Cat.No.						
0.5to1.5-3	3D-3338	1.6	3.2	6.0	19	2000	3.97
0.5to1.5-3.5	3D-3339	1.6	3.2	6.0	19	2000	3.92
0.5to1.5-4	3D-3340	1.6	3.2	6.0	19	2000	3.84
0.5to1.5-4	3D-3343	1.6	3.2	6.8	18	2000	3.83
0.5to1.5-4	3D-3345	1.6	3.2	8.0	21	2000	4.41
0.5to1.5-5	3D-3346	1.6	3.2	8.0	21	2000	4.26
0.5to1.5-6	3D-3350	1.6	3.2	10.0	23	2000	4.62
0.5to1.5-6	3D-3351	1.6	3.2	12.0	23	2000	5.33
2.5-4	3D-3385	2.3	3.9	8.0	21	2000	5.07
2.5-5	3D-3386	2.3	3.9	8.0	21	2000	4.92
2.5-5	3D-3387	2.3	3.9	10.0	23	2000	5.64
2.5-6	3D-3388	2.3	3.9	10.0	23	2000	5.40
2.5-6	3D-3390	2.3	3.9	12.0	27	1600	6.67
2.5-8	3D-3391	2.3	3.9	12.0	27	1600	6.21
2.5-10	3D-3394	2.3	3.9	16.0	30	1000	7.69
4to6-4	3D-3493	3.5	5.5	8.0	26	1000	7.77
4to6-5	3D-3494	3.5	5.5	8.0	26	1000	7.52
4to6-5	3D-3496	3.5	5.5	10.0	28	1000	8.37
4to6-6	3D-3499	3.5	5.5	12.0	29	800	8.84
4to6-6	3D-3502	3.5	5.5	12.0	31	800	9.35
4to6-8	3D-3504	3.5	5.5	14.0	34.5	800	10.37

Terminal Ends, Rectangular Pin Type

Brazed Seam,
 Material : E Copper
 Surface : Tin Plated



Con-Bolt	3D	d1	d3	b	J	Std Pkg	Price/ each
mm ² -Φ	Cat.No.						
10	3D-1041	4.3	6.7	4.3	22	1600	9.56
16	3D-1043	5.8	8.2	5.5	26	1000	14.40
25	3D-1044	7.5	11.1	7	31	400	32.84
35	3D-1045	9	12.6	8	37	400	45.37
50	3D-1046	10.5	14.1	9	42	200	59.74
70	3D-1047	12	16	10	45	100	82.74

"NOTE: Certain catalogue nos. may have been discontinued from production, Please consult our sales department for an alternative."



Precision in Every Dimension

Terminal Ends, Round Pin Type

W/O Sleeve, Brazed Seam
Material: E-Copper
Surface: Tin Plated

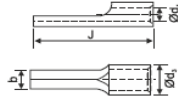

Con-Bolt	3D	d1	d3	b	J	Std Pkg	Price/each
mm²-Φ	Cat.No.						
0.5 TO 1.5	3D-1012	1.6	3.2	1.9	17	5000	2.30
2.5	3D-1021	2.3	3.9	1.9	17	5000	2.61
4	3D-1030	2.9	4.9	2.7	20	3000	5.02
6	3D-1036	3.6	5.6	2.7	20	3000	5.65

Terminal Ends,
Insulated Flat Pin Type Double Grip
With Insulating Sleeve
Material: E-Copper With PVC Sleeve
Surface: Tin Plated

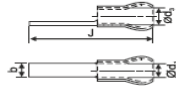

Con-Bolt	3D	d1	d3	b	J	Std Pkg	Price/each
mm²-Φ	Cat.No.						
2.5	3D-3044	2.3	3.9	3.1	22	2000	4.39

Terminal Ends, Round Pin Type

With Insulating Sleeve
Material: E-Copper With PVC Sleeve
Surface: Tin Plated

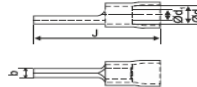

Con-Bolt	3D	d1	d3	b	J	Std Pkg	Price/each
mm²-Φ	Cat.No.						
0.5to1.5	3D-3008	1.6	3.2	1.9	22	2000	2.75
2.5	3D-3022	2.3	3.9	1.9	22	2000	3.17
4	3D-3026	2.9	4.9	2.7	28	1000	6.46

Terminal Ends, Round Pin Type

Double Grip, With Insulating Sleeve
Material: E-Copper With PVC Sleeve
Surface: Tin Plated

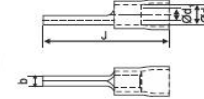

Con-Bolt	3D	d1	d3	b	J	Std Pkg	Price/each
mm²-Φ	Cat.No.						
0.5to1.5	3D-3040	1.6	3.2	1.9	22	2000	3.77
2.5	3D-3043	2.3	3.9	1.9	22	2000	4.39

Terminal Ends, Flat Pin Type

Standard Type w/o Sleeve, Brazed Seam
Material: E-Copper
Surface: Tin Plated

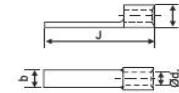

Con-Bolt	3D	d1	d3	b	J	Std Pkg	Price/each
mm²-Φ	Cat.No.						
0.5to1.5	3D-1011	1.6	3.2	3.1	17	5000	2.49
2.5	3D-1022	2.3	3.9	3.1	17	5000	2.88

Terminal Ends, Insulated Flat Pin Type

With Insulating Sleeve
Material: E-Copper With PVC Sleeve
Surface: Tin Plated

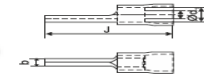

Con-Bolt	3D	d1	d3	b	J	Std Pkg	Price/each
mm²-Φ	Cat.No.						
0.5to1.5	3D-3009	1.6	3.2	3.1	22	2000	3.07
2.5	3D-3023	2.3	3.9	3.1	22	2000	3.38

"NOTE: Certain catalogue nos. may have been discontinued from production, Please consult our sales department for an alternative."



Precision in Every Dimension

Copper Split Bolt Connectors (Cold Formed)

Features

- **UL Listed** for copper stranded wires only.
- Manufactured from high **strength**, high **conductivity** copper.
- Precision tooled **Cold Formed** threads.

Application

- Suitable for **direct burial** application in earth and concrete.
- Splicing, tapping or terminating conductors in power and grounding electrical connection.

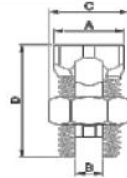

Standards

- Tested and Listed to **UL 486A, UL486B** requirements.
- **CSA C22.2 No.65** Listed
- **UL 467** Listed for **Grounding and Bonding**, this does not apply to 3D SB-1000.
- **ROHS** compliance.

CATALOG NUMBER	WIRE RANGE			Recommended Torque In-lbs (N-m)	Dimensions (inch)			
	RANGE OF EQUAL MAIN AND TAP		MIN TAP WITH ONE MAX MAIN		A	B	C	D
	MIN	MAX						
30 SB-8	16 STR/SOL	8 STR/SOL	16 SOIJSTR	80 (9)	0.38	0.15	0.50	0.85
30 SB-6	10 SOIJSTR	6 SOIJSTR	16 SOIJSTR	165 (18.6)	0.50	0.17	0.63	1.05
30 SB-4	8 SOIJSTR	4 STR	16 SOIJSTR	165 (18.6)	0.56	0.22	0.69	1.05
30 SB-2	6 SOIJSTR	2 STR	14 SOIJSTR	275 (31.1)	0.69	0.33	0.82	1.32
30 SB-3	4 STR	2 STR	8 SOL/STA	27() (31.1)	0.60	0.26	0.75	1.50
30 SB-1/0	4 STR	1/0 STR	14 SOIJSTR	385 (43.5)	0.73	0.38	0.94	1.77
30 SB-2/0	2 STR	2/0 STR	14 SOIJSTR	385 (43.5)	0.82	0.44	1.05	1.94
30 SB-3/0	2 STR	3/0 STR	8 SOIJSTR	500 (56.5)	0.82	0.48	1.05	1.94
30 SB-250	1/0 STR	250 kcmil	8 SOIJSTR	650 (73.4)	1.00	0.60	1.39	2.25
30 SB-350	4/0 STR	350 kcmil	1/0 STR	650 (73.4)	1.41	0.71	1.70	2.60
30 SB-500	250 kcmil	500 kcmil	2/0 STR	825 (93.2)	1.48	0.85	1.82	2.83
30 SB-750	350 kcmil	750 kcmil	4/0 STR	1000 (113)	1.94	1.02	2.31	3.51
30 SB-1000	500kcmil	1000 kcmil	4/0 STR	1100 (124.3)	2.19	1.17	2.56	3.90

"NOTE: Certain catalogue nos. may have been discontinued from production, Please consult our sales department for an alternative."