

STAINLESS STEEL 304-A2 HEX SCREW FULL THREAD (DIN 933 / IS 1363)

TABLE - 1A

| DIA | 10 | 12 | 16 | 20 | 25 | 30 | 35 | 40 | 45 | 50 | 55 | 60 | 65 | 70 | 75 | 80 | 85 | 90 | 100 |
|-----|-----|-----|------|------|------|------|------|-------|-------|-------|-------|-------|-------|-------|-------|-------|-------|-------|-------|
| 3 | 200 | 219 | 230 | 256 | 293 | 456 | 547 | 674 | 764 | 785 | - | - | - | - | - | - | - | - | - |
| 4 | 256 | 264 | 289 | 321 | 361 | 429 | 498 | 674 | 725 | 757 | - | 1138 | - | 1244 | - | 1527 | - | 1996 | 2445 |
| 5 | 355 | 379 | 407 | 458 | 517 | 590 | 685 | 808 | 884 | 947 | 1677 | 1878 | 2095 | 2198 | 2323 | 2517 | - | 2637 | 2896 |
| 6 | 499 | 512 | 573 | 644 | 725 | 810 | 895 | 977 | 1052 | 1139 | 1323 | 1388 | 1508 | 1583 | 1746 | 1814 | 2019 | 2063 | 2294 |
| 8 | - | - | 1176 | 1293 | 1427 | 1622 | 1746 | 1893 | 2107 | 2228 | 2423 | 2528 | 2757 | 2837 | 2968 | 3220 | 3408 | 3641 | 3973 |
| 10 | - | - | 2243 | 2357 | 2604 | 2822 | 3062 | 3305 | 3572 | 3850 | 4109 | 4362 | 4695 | 4833 | 5193 | 5350 | 5757 | 5871 | 6286 |
| 12 | - | - | - | 3562 | 3854 | 4124 | 4535 | 4896 | 5222 | 5626 | 5925 | 6276 | 6610 | 6942 | 7313 | 7639 | 8043 | 8355 | 9089 |
| 14 | - | - | - | - | 6545 | 6946 | 7463 | 7875 | 8440 | 8923 | 9566 | 9894 | 10620 | 11024 | 11564 | 12118 | 13185 | 13855 | 14259 |
| 16 | - | - | - | - | 8111 | 8391 | 9039 | 9692 | 10307 | 10995 | 11657 | 12389 | 12875 | 13230 | 13989 | 14831 | 15458 | 16094 | 17594 |
| 18 | - | - | - | - | - | - | - | 14679 | 15800 | 16416 | 17775 | 18468 | 19614 | 20314 | 21464 | 22306 | 23216 | 23949 | 25280 |
| 20 | - | - | - | - | - | - | - | 16744 | 18000 | 18912 | 19649 | 20698 | 21913 | 23172 | 24057 | 25200 | 26182 | 27243 | 29217 |
| 22 | - | - | - | - | - | - | - | 26148 | 27861 | 28678 | 30340 | 32001 | 33663 | 35324 | 36986 | 38648 | 40309 | 41971 | 45294 |
| 24 | - | - | - | - | - | - | - | - | - | 31423 | 33163 | 34880 | 36536 | 38356 | 39919 | 41614 | 43285 | 43609 | 46949 |

STAINLESS STEEL 304-A2 HEX SCREW FULL THREAD (BS - 1083)

TABLE - 1B

| BSW | 1/2" | 3/4" | 1" | 1.1/4" | 1.1/2" | 2 | 2.1/2" | 3" | 3.1/2" | 4" | 5" | 6" | 7" | 8" |
|-------|------|------|------|--------|--------|-------|--------|-------|--------|-------|-------|-------|--------|--------|
| 1/8" | 295 | 320 | 346 | 577 | 715 | 804 | - | - | - | - | - | - | - | - |
| 3/16" | 334 | 388 | 443 | 531 | 677 | 841 | 1202 | 1445 | - | - | - | - | - | - |
| 1/4" | 662 | 763 | 882 | 1001 | 1131 | 1373 | 1742 | 2017 | 2201 | 2494 | - | - | - | - |
| 5/16" | 1173 | 1342 | 1539 | 1733 | 1934 | 2319 | 2721 | 3124 | 3653 | 4256 | 5176 | - | - | - |
| 3/8" | 1834 | 2091 | 2366 | 2659 | 2953 | 3532 | 4108 | 4690 | 5262 | 5848 | 7643 | 9226 | - | - |
| 7/16" | - | - | 4351 | 4822 | 5242 | 6105 | 7011 | 7920 | 8812 | 9673 | 11520 | 13179 | - | - |
| 1/2" | - | - | 5004 | 5545 | 6028 | 7020 | 8063 | 9108 | 10134 | 11124 | 13248 | 15156 | 21618 | 25968 |
| 5/8" | - | - | 9232 | 9481 | 10246 | 11947 | 13407 | 15755 | 16523 | 18014 | 22357 | 25726 | 31417 | 35417 |
| 3/4" | - | - | - | - | - | 18833 | 20771 | 23298 | 25857 | 28391 | 31043 | 40293 | 46049 | - |
| 7/8" | - | - | - | - | - | 31356 | 35966 | 39959 | 44394 | 48736 | 57231 | 65995 | 74035 | 82665 |
| 1" | - | - | - | - | - | 45374 | 51019 | 56580 | 62072 | 68945 | 79930 | 91701 | 103472 | 115244 |

STAINLESS STEEL 304-A2 HEX NUT (DIN 934 / IS 1363)

TABLE - 1C

| SIZE | M 2 | M 2.5 | M 3 | M 4 | M 5 | M 6 | M 8 | M 10 | M 12 | M 14 | M 16 | M 18 | M 20 | M 22 | M 24 | M 27 | M 30 | M 33 | M 36 |
|------|-----|-------|-----|-----|-----|-----|-----|------|------|------|------|------|------|-------|-------|-------|-------|-------|-------|
| 304 | 160 | 196 | 95 | 121 | 147 | 258 | 524 | 1157 | 1755 | 2816 | 3483 | 6924 | 6924 | 11693 | 11693 | 21330 | 31837 | 36902 | 51036 |

STAINLESS STEEL 304-A2 HEX NUT (BS 1083)
TABLE - 1D

| BSW | 1/8" | 5/32" | 3/16" | 1/4" | 5/16" | 3/8" | 7/16" | 1/2" | 5/8" | 3/4" | 7/8" | 1" |
|-----|------|-------|-------|------|-------|------|-------|------|------|------|-------|-------|
| 304 | 164 | 174 | 195 | 400 | 572 | 956 | 2053 | 2465 | 4620 | 8899 | 11880 | 18300 |

Stainless steel fasteners : Rates in rupees per 100 pcs

STAINLESS STEEL 304-A2 LONG LENGTH HEX SCREW (DIN 933 / IS 1363)

TABLE - 2A

| DIA | 110 | 120 | 125 | 130 | 140 | 150 | 160 | 170 | 175 | 180 | 190 | 200 |
|-----|-------|-------|-------|-------|-------|-------|-------|-------|-------|-------|-------|-------|
| 8 | 4414 | 4738 | 4902 | 5139 | 5566 | 5908 | 11150 | 13160 | - | - | - | 15360 |
| 10 | 7104 | 7771 | 8086 | 8311 | 8832 | 9728 | 11762 | 13870 | 14181 | 14650 | 16050 | 16775 |
| 12 | 10030 | 10867 | 11399 | 11971 | 12631 | 13588 | 14466 | 18629 | 20710 | 22792 | 24958 | 27125 |
| 14 | 17446 | 18778 | 19443 | 20109 | 21440 | 22771 | 24102 | 25434 | 26765 | 28096 | 29427 | 30758 |
| 16 | 19158 | 20645 | 21327 | 21973 | 23302 | 25051 | 26815 | 30133 | 31498 | 32863 | 34320 | 35778 |
| 18 | 30552 | 32695 | 33766 | 34837 | 36980 | 39122 | 41265 | 47259 | 48397 | 50673 | 54088 | 57503 |
| 20 | 33093 | 35168 | 36245 | 37521 | 39761 | 42119 | 44033 | 47583 | 49974 | 52364 | 57600 | 62836 |
| 22 | 48617 | 51940 | 53602 | 55263 | 58586 | 61909 | 67271 | 70698 | 72411 | 74125 | 77552 | 80979 |
| 24 | 52605 | 56112 | 57893 | 59792 | 63248 | 66718 | 71190 | 74534 | 76372 | 78209 | 81819 | 85428 |

STAINLESS STEEL 304-A2 PLAIN WASHER (DIN 125 / IS 2016)
TABLE - 2B
STAINLESS STEEL 304-A2 SPRING WASHER (DIN 127 / IS 3063)

| THICK | 1.2MM | 1.6MM | 2MM | 2.5MM | 3MM | IS |
|--------------|-------|-------|------|-------|------|-------|
| M3 (1/8") | 100 | - | - | - | - | 100 |
| M4 (5/32") | 113 | - | - | - | - | 113 |
| M5 (3/16") | 136 | 181 | - | - | - | 136 |
| M6 (1/4") | 172 | 294 | 366 | 420 | 451 | 294 |
| M8 (5/16") | 294 | 407 | 474 | 677 | 776 | 407 |
| M10 (3/8") | 361 | 564 | 732 | 903 | 1300 | 732 |
| M12 (1/2") | 443 | 713 | 1016 | 1467 | 1805 | 1467 |
| M14 (9/16") | 912 | 1160 | 1548 | 1738 | 2266 | 2266 |
| M16 (5/8") | 979 | 1457 | 1851 | 2233 | 2649 | 2649 |
| M18 | 1300 | 1805 | 2482 | 2789 | 3353 | 3353 |
| M20 (3/4") | 1300 | 1805 | 2482 | 2717 | 3439 | 3439 |
| M22 (7/8") | - | - | - | - | 5077 | 5077 |
| M24 (1") | - | - | - | - | 5925 | 7671 |
| M27 (1.1/8") | - | - | - | - | 6656 | 8461 |
| M30 (1.1/4") | - | - | - | - | 7671 | 9476 |
| M33 (1.3/8") | - | - | - | - | 8461 | 10154 |
| M36 (1.1/2") | - | - | - | - | 9476 | 14102 |

| BSW | SQUARE | FLAT |
|--------------|--------|-------|
| M3 (1/8") | 100 | 185 |
| M4 (5/32") | 113 | 203 |
| M5 (3/16") | 140 | 226 |
| M6 (1/4") | 181 | 361 |
| M8 (5/16") | 280 | 451 |
| M10 (3/8") | 425 | 699 |
| M12 (1/2") | 677 | 1264 |
| M14 (9/16") | 961 | 1634 |
| M16 (5/8") | 1241 | 2089 |
| M18 | 1751 | 2676 |
| M20 (3/4") | 2031 | 2875 |
| M22 (7/8") | 2653 | 4513 |
| M24 (1") | 3777 | 5469 |
| M27 (1.1/8") | 4513 | 6544 |
| M30 (1.1/4") | 5190 | 7897 |
| M33 (1.3/8") | 6204 | 9025 |
| M36 (1.1/2") | 6544 | 10717 |

STAINLESS STEEL 304-A2 THREADED ROD 1 MTR LENGTH (DIN 975)
TABLE - 2D

| SIZE | M 3 | M 4 | M 5 | M 6 | M 8 | M 10 | M 12 | M 14 | M 16 | M 18 | M 20 | M 22 | M 24 |
|------|-------|-------|-------|-------|-------|-------|-------|--------|--------|--------|--------|--------|--------|
| 304 | 15360 | 15360 | 15845 | 18073 | 30692 | 48033 | 70122 | 101214 | 128089 | 171111 | 200139 | 264444 | 313185 |

STAINLESS STEEL 304-A2 THREADED ROD 1 MTR LENGTH (BS 1083 / ANSI B18.2.1)
TABLE - 2E

| DIA | 3/16" | 1/4" | 5/16" | 3/8" | 1/2" | 5/8" | 3/4" | 7/8" | 1" |
|------|-------|-------|-------|-------|-------|--------|--------|--------|--------|
| RATE | 16102 | 20056 | 31733 | 45426 | 84130 | 129250 | 188324 | 259722 | 351491 |

Stainless steel fasteners : Rates in rupees per 100 pcs

**STAINLESS STEEL 304-A2 CHEESE HEAD (DIN 84) /
ROUND HEAD SLOTTED SCREW (DIN 85)**

TABLE - 3A

| DIA | 4 | 6 | 8 | 10 | 12 | 16 | 20 | 25 | 30 | 35 | 40 | 50 | 60 | 70 | 80 | 90 | 100 |
|-----|-----|-----|-----|-----|-----|------|------|------|------|------|------|------|------|-------|-------|-------|-------|
| 2 | 195 | 204 | 209 | 218 | 232 | 245 | 258 | - | - | - | - | - | - | - | - | - | - |
| 2.5 | 218 | 199 | 213 | 240 | 254 | 267 | 276 | - | - | - | - | - | - | - | - | - | - |
| 3 | - | 225 | 218 | 234 | 256 | 293 | 339 | 437 | 653 | 847 | 821 | 1188 | - | - | - | - | - |
| 4 | - | 311 | 318 | 335 | 363 | 440 | 515 | 615 | 721 | 797 | 939 | 1182 | - | - | - | - | - |
| 5 | - | 472 | 488 | 518 | 578 | 679 | 779 | 921 | 1029 | 1165 | 1297 | 1529 | - | - | - | - | - |
| 6 | - | - | - | 812 | 856 | 1004 | 1109 | 1326 | 1489 | 1711 | 1905 | 2280 | 2729 | 3104 | 3523 | 3654 | 4119 |
| 8 | - | - | - | - | - | 1554 | 1704 | 2035 | 2205 | 2472 | 2841 | 3249 | 5287 | 5878 | 6438 | 7214 | 8091 |
| 10 | - | - | - | - | - | 3089 | 3354 | 3655 | 3876 | 4211 | 4585 | 5402 | 9477 | 10994 | 12174 | 13524 | 14401 |

**STAINLESS STEEL 304-A2 CHEESE HEAD /
ROUND HEAD SLOTTED SCREW (BS 450)**

TABLE - 3B

| BSW | 1/4" | 3/8" | 1/2" | 3/4" | 1" | 1.1/4" | 1.1/2" | 2" | 2.1/2" | 3" |
|-------|------|------|------|------|------|--------|--------|------|--------|-------|
| 1/8" | 244 | 266 | 295 | 358 | 458 | 732 | 932 | 1407 | - | - |
| 5/32" | 322 | 363 | 405 | 504 | 590 | 690 | 937 | 1189 | - | - |
| 3/16" | 400 | 491 | 567 | 697 | 853 | 1007 | 1167 | 1463 | - | - |
| 1/4" | - | 943 | 1016 | 1242 | 1469 | 1752 | 1970 | 2519 | 3154 | 3688 |
| 5/16" | - | - | 2382 | 2735 | 3110 | 3534 | 3995 | 5171 | 6219 | 7385 |
| 3/8" | - | - | 3844 | 4193 | 4684 | 5827 | 6388 | 7848 | 9346 | 11621 |

**STAINLESS STEEL 304-A2 COUNTERSUNK (CSK)
SLOTTED HEAD SCREW (DIN 963)**

TABLE - 3C

| DIA | 4 | 6 | 8 | 10 | 12 | 16 | 20 | 25 | 30 | 35 | 40 | 50 | 60 | 70 | 80 | 90 | 100 |
|-----|-----|-----|-----|-----|------|------|------|------|------|------|-------|-------|-------|-------|------|----|-----|
| 2 | 240 | 218 | 232 | 240 | 250 | 258 | 273 | - | - | - | - | - | - | - | - | - | - |
| 2.5 | 250 | 213 | 235 | 245 | 258 | 267 | 276 | - | - | - | - | - | - | - | - | - | - |
| 3 | - | 194 | 188 | 201 | 241 | 263 | 348 | 409 | 622 | - | - | 1521 | - | - | - | - | - |
| 4 | - | 256 | 258 | 296 | 310 | 381 | 459 | 537 | 660 | 720 | 887 | 1218 | - | - | - | - | - |
| 5 | - | 348 | 380 | 411 | 457 | 554 | 670 | 785 | 921 | 1067 | 1189 | 1392 | - | - | - | - | - |
| 6 | - | - | - | 631 | 676 | 747 | 910 | 1053 | 1242 | 1425 | 1609 | 2000 | 2456 | 2847 | 3140 | - | - |
| 8 | - | - | - | - | 1488 | 1756 | 2100 | 2435 | 2783 | 3151 | 3827 | 4373 | 4983 | 5792 | - | - | - |
| 10 | - | - | - | - | - | 2895 | 3457 | 3967 | 4559 | 5102 | 6123 | 7143 | 8929 | 10205 | - | - | - |
| 12 | - | - | - | - | - | 6283 | 6668 | 7421 | 7939 | 9168 | 10994 | 12438 | 13089 | 15473 | - | - | - |

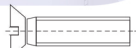
**STAINLESS STEEL 304-A2 COUNTERSUNK (CSK)
SLOTTED HEAD SCREW (BS 240)**

TABLE - 3D

| BSW | 1/4" | 3/8" | 1/2" | 3/4" | 1" | 1.1/4" | 1.1/2" | 2" | 2.1/2" | 3" | 3.1/2" | 4" |
|-------|------|------|------|------|------|--------|--------|-------|--------|-------|--------|-------|
| 1/8" | 222 | 246 | 284 | 335 | 446 | 723 | 921 | 1398 | - | - | - | - |
| 5/32" | 276 | 323 | 371 | 468 | 580 | 671 | 899 | 1165 | - | - | - | - |
| 3/16" | - | 392 | 446 | 578 | 776 | 976 | 1129 | 1408 | - | - | - | - |
| 1/4" | - | 714 | 871 | 1042 | 1247 | 1526 | 1726 | 2285 | 3000 | 3534 | - | - |
| 5/16" | - | - | 2070 | 2451 | 2784 | 3357 | 3795 | 4857 | 5909 | 7014 | - | - |
| 3/8" | - | - | 3651 | 3588 | 4057 | 5029 | 5482 | 6876 | 8191 | 10584 | - | - |
| 1/2" | - | - | - | - | 7791 | 9539 | 10877 | 13375 | 15882 | 17982 | 20854 | 23831 |

Stainless steel fasteners : Rates in rupees per 100 pcs

STAINLESS STEEL 304-A2 PAN PHILIPS M/C AS PER (DIN 7985)

TABLE - 4A

| DIA | 4 | 6 | 8 | 10 | 12 | 16 | 20 | 25 | 30 | 35 | 40 | 50 | 60 | 70 | 80 | 90 | 100 |
|-----|-----|-----|-----|-----|-----|------|------|------|------|------|------|------|------|------|------|------|-------|
| 2 | 147 | 141 | 140 | 147 | 153 | 181 | 213 | - | - | - | - | - | - | - | - | - | - |
| 2.5 | 153 | 147 | 155 | 170 | 181 | 207 | 245 | 341 | - | - | - | - | - | - | - | - | - |
| 3 | - | 159 | 156 | 167 | 183 | 212 | 235 | 311 | 449 | 576 | 563 | 800 | - | - | - | - | - |
| 4 | - | 227 | 235 | 247 | 269 | 325 | 376 | 451 | 527 | 581 | 680 | 847 | - | - | - | - | - |
| 5 | - | 350 | 365 | 389 | 434 | 508 | 580 | 685 | 763 | 863 | 961 | 1131 | - | - | - | - | - |
| 6 | - | - | - | 597 | 631 | 743 | 819 | 980 | 1094 | 1257 | 1396 | 1668 | 1987 | 2260 | 2555 | 2699 | 3029 |
| 8 | - | - | - | - | - | 1819 | 2063 | 2195 | 2483 | 2715 | 3060 | 3627 | 3802 | 4239 | 4656 | 5240 | 5853 |
| 10 | - | - | - | - | - | - | 3212 | 3606 | 4058 | 4510 | 4917 | 5748 | 6741 | 7744 | 8558 | 9496 | 10096 |

STAINLESS STEEL 304-A2 PAN PHILIPS M/C

TABLE - 4B

| BSW | 1/4" | 3/8" | 1/2" | 3/4" | 1" | 1.1/4" | 1.1/2" | 2" | 2.1/2" | 3" | | |
|-------|------|------|------|------|------|--------|--------|------|--------|------|--|--|
| 1/8" | 163 | 181 | 201 | 247 | 315 | 491 | 621 | 927 | - | - | | |
| 5/32" | 222 | 252 | 283 | 356 | 417 | 489 | 654 | 826 | - | - | | |
| 3/16" | 288 | 349 | 404 | 499 | 609 | 718 | 832 | 1042 | - | - | | |
| 1/4" | - | 684 | 743 | 912 | 1082 | 1284 | 1449 | 1843 | 2295 | 2682 | | |
| 5/16" | - | - | 1661 | 1926 | 2202 | 2510 | 2841 | 3660 | 4404 | 5214 | | |
| 3/8" | - | - | 2674 | 2962 | 3335 | 4102 | 4522 | 5560 | 6638 | 8141 | | |

STAINLESS STEEL 304-A2 CSK PHILIPS M/C AS PER (DIN 965)

TABLE - 4C

| DIA | 4 | 6 | 8 | 10 | 12 | 16 | 20 | 25 | 30 | 35 | 40 | 50 | 60 | 70 | 80 | 90 | 100 |
|-----|-----|-----|-----|-----|-----|------|------|------|------|------|------|------|------|------|-------|-------|-------|
| 2 | 147 | 139 | 139 | 146 | 149 | 177 | 213 | - | - | - | - | - | - | - | - | - | - |
| 2.5 | 149 | 146 | 154 | 168 | 177 | 212 | 243 | 282 | - | - | - | - | - | - | - | - | - |
| 3 | - | 135 | 132 | 143 | 171 | 188 | 250 | 289 | 425 | 551 | - | - | - | - | - | - | - |
| 4 | - | 183 | 186 | 216 | 225 | 279 | 334 | 391 | 479 | 521 | 639 | 877 | - | - | - | - | - |
| 5 | - | 253 | 280 | 304 | 337 | 412 | 495 | 579 | 680 | 785 | 875 | 1024 | - | - | - | - | - |
| 6 | - | - | - | 463 | 498 | 554 | 675 | 829 | 907 | 1054 | 1179 | 1472 | 1809 | 2092 | 2307 | - | - |
| 8 | - | - | - | - | - | 1440 | 1637 | 1856 | 2109 | 2354 | 2652 | 3258 | 3785 | 4314 | 4969 | - | - |
| 10 | - | - | - | - | - | - | 2559 | 2905 | 3351 | 3777 | 4234 | 5131 | 5879 | 7148 | 8010 | 9120 | 9838 |
| 12 | - | - | - | - | - | - | 4361 | 4656 | 5236 | 5623 | 6484 | 7777 | 8834 | 9299 | 10991 | 12262 | 13391 |

STAINLESS STEEL 304-A2 CSK PHILIPS

TABLE - 4D

| BSW | 1/4" | 3/8" | 1/2" | 3/4" | 1" | 1.1/4" | 1.1/2" | 2" | 2.1/2" | 3" | 3.1/2" | 4" |
|-------|------|------|------|------|------|--------|--------|------|--------|-------|--------|-------|
| 1/8" | 147 | 166 | 194 | 230 | 307 | 485 | 614 | 923 | - | - | - | - |
| 5/32" | 189 | 223 | 259 | 330 | 412 | 477 | 629 | 813 | - | - | - | - |
| 3/16" | 234 | 276 | 315 | 412 | 556 | 700 | 809 | 1009 | - | - | - | - |
| 1/4" | - | 506 | 630 | 756 | 909 | 1109 | 1258 | 1661 | 2183 | 2567 | - | - |
| 5/16" | - | - | 1430 | 1717 | 1962 | 2386 | 2700 | 3435 | 4186 | 4956 | - | - |
| 3/8" | - | - | 2542 | 2511 | 2866 | 3508 | 3846 | 4837 | 5779 | 7386 | - | - |
| 1/2" | - | - | - | - | 5459 | 6664 | 7601 | 9358 | 11138 | 12673 | 14649 | 16706 |

Stainless steel fasteners : Rates in rupees per 100 pcs

STAINLESS STEEL 304-A2 ALLEN CAP SCREW (DIN 912)

TABLE - 5A

| DIA | 6 | 8 | 10 | 12 | 16 | 20 | 25 | 30 | 35 | 40 | 45 | 50 | 60 | 70 | 75 | 80 | 90 | 100 |
|-----|-----|-----|-----|------|------|------|-------|-------|-------|-------|-------|-------|-------|-------|-------|-------|-------|-------|
| 3 | 381 | 372 | 382 | 392 | 439 | 487 | 563 | 730 | - | - | - | - | - | - | - | - | - | - |
| 4 | 477 | 454 | 425 | 438 | 505 | 568 | 613 | 746 | 839 | 1006 | 1172 | 1339 | 1273 | 1799 | 2353 | 2697 | 3197 | 3789 |
| 5 | - | 522 | 571 | 606 | 680 | 757 | 861 | 990 | 1129 | 1315 | 1456 | 1596 | 2340 | 2900 | 3211 | 3559 | 4019 | 4612 |
| 6 | - | - | 785 | 809 | 871 | 946 | 1076 | 1196 | 1290 | 1496 | 1665 | 1723 | 2114 | 2462 | 2728 | 3080 | 3490 | 4072 |
| 8 | - | - | - | 1879 | 1739 | 1820 | 2016 | 2310 | 2519 | 2705 | 2943 | 3121 | 3708 | 4104 | 4753 | 5017 | 5790 | 6235 |
| 10 | - | - | - | - | 3420 | 3212 | 3617 | 3817 | 4243 | 4539 | 4856 | 5218 | 5886 | 6688 | 7068 | 7453 | 9170 | 10078 |
| 12 | - | - | - | - | - | 6080 | 5871 | 6019 | 6408 | 6916 | 7522 | 7939 | 8943 | 9546 | 10420 | 11216 | 12160 | 13348 |
| 14 | - | - | - | - | - | - | 10602 | 10847 | 11432 | 12021 | 12850 | 13630 | 15187 | 17109 | 19181 | 19737 | 22001 | 24217 |
| 16 | - | - | - | - | - | - | - | 13680 | 12907 | 14128 | 15302 | 15832 | 17712 | 19684 | 20888 | 21810 | 23947 | 26102 |
| 18 | - | - | - | - | - | - | - | - | - | 24833 | 25971 | 27108 | 29383 | 31658 | 33927 | 35387 | 38197 | 41683 |
| 20 | - | - | - | - | - | - | - | - | - | 26705 | 27808 | 29409 | 32706 | 35846 | 37735 | 39330 | 42507 | 46157 |
| 22 | - | - | - | - | - | - | - | - | - | - | - | 49890 | 55389 | 58908 | 63737 | 66181 | 71272 | 77584 |
| 24 | - | - | - | - | - | - | - | - | - | - | - | 60971 | 66075 | 71181 | 72653 | 76286 | 81392 | 86497 |

STAINLESS STEEL 304-A2 ALLEN CAP SCREW (BS 2470)

TABLE - 5B

| BSW | 1/2" | 3/4" | 1" | 1.1/4" | 1.1/2" | 2" | 2.1/2" | 3" | 3.1/2" | 4" |
|-------|------|------|------|--------|--------|-------|--------|-------|--------|-------|
| 3/16" | 822 | 851 | 924 | 1033 | 1198 | - | - | - | - | - |
| 1/4" | 1083 | 1183 | 1317 | 1490 | 1710 | 2079 | 2622 | 3306 | 4018 | 4526 |
| 5/16" | 1870 | 1984 | 2069 | 2427 | 2666 | 3152 | 4047 | 4781 | - | - |
| 3/8" | - | 2917 | 3107 | 3498 | 3964 | 4834 | 5837 | 6996 | 7944 | 8664 |
| 1/2" | - | - | - | 7714 | 8471 | 9497 | 10966 | 12327 | 14849 | 17328 |
| 5/8" | - | - | - | - | 15040 | 17337 | 20552 | 24189 | 28120 | 30132 |
| 3/4" | - | - | - | - | 29910 | 32940 | 40150 | 42263 | 47607 | 51690 |

STAINLESS STEEL 304-A2 ALLEN CAP SCREW LONG LENGTH (DIN 912)

TABLE - 5C

| DIA | 110 | 120 | 125 | 130 | 140 | 150 |
|-----|-------|--------|-------|--------|--------|--------|
| 8 | 7425 | 8522 | 9561 | 10390 | 12258 | 14126 |
| 10 | 12230 | 13248 | 14034 | 14723 | 16839 | 18954 |
| 12 | 14919 | 16796 | 17822 | 18094 | 19325 | 20074 |
| 14 | 27000 | 28920 | 29880 | 31611 | 33579 | 35547 |
| 16 | 33407 | 36128 | 37899 | 38934 | 41698 | 44461 |
| 18 | 45169 | 48655 | 50370 | 52140 | 55626 | 59112 |
| 20 | 50575 | 53295 | 54655 | 56684 | 58713 | 63263 |
| 22 | 81997 | 86508 | 87974 | 90119 | 93695 | 99205 |
| 24 | 94995 | 100289 | 99163 | 101781 | 106914 | 112024 |

STAINLESS STEEL 304-A2 LOCK NUT (DIN 439)

TABLE - 5D

| SIZE | M 5 | M 6 | M 8 | M 10 | M 12 | M 14 | M 16 | M 18 | M 20 | M 22 | M 24 | M 27 | M 30 | M 33 | M 36 |
|------|-----|-----|-----|------|------|------|------|------|------|------|------|-------|-------|-------|-------|
| 304 | 151 | 206 | 396 | 808 | 1187 | 2200 | 2389 | 5256 | 5256 | 9406 | 9406 | 18466 | 26477 | 34790 | 45536 |

Stainless steel fasteners : Rates in rupees per 100 pcs

STAINLESS STEEL 304-A2 ALLEN CSK CAP SCREW (DIN 7991)

TABLE - 6A

| DIA | 8 | 10 | 12 | 16 | 20 | 25 | 30 | 35 | 40 | 50 | 60 | 70 | 80 | 90 | 100 |
|-----|-----|-----|-----|------|------|------|------|------|-------|-------|-------|-------|-------|-------|-------|
| 3 | 136 | 148 | 170 | 203 | 275 | 367 | - | - | - | - | - | - | - | - | - |
| 4 | 214 | 228 | 251 | 304 | 329 | 420 | 474 | 522 | 602 | - | - | - | - | - | - |
| 5 | 295 | 332 | 360 | 401 | 468 | 561 | 663 | 750 | 837 | 1066 | - | - | - | - | - |
| 6 | - | 469 | 515 | 586 | 689 | 815 | 957 | 1085 | 1314 | 1469 | 1728 | 2195 | 2806 | 3223 | 3868 |
| 8 | - | - | - | 1387 | 1451 | 1636 | 1841 | 2035 | 2236 | 2814 | 3454 | 3833 | 4182 | 4627 | 5242 |
| 10 | - | - | - | - | 2582 | 2940 | 3256 | 3455 | 3924 | 4650 | 5242 | 6025 | 6590 | 7392 | 8283 |
| 12 | - | - | - | - | - | 5889 | 6339 | 7000 | 7242 | 8398 | 9466 | 10638 | 11491 | 12767 | 14148 |
| 16 | - | - | - | - | - | - | - | - | 11999 | 14364 | 16727 | 18909 | 21273 | 24000 | 26727 |
| 20 | - | - | - | - | - | - | - | - | 20029 | 28079 | 30436 | 36130 | 39272 | 44378 | 49679 |

STAINLESS STEEL 304-A2 ALLEN CSK SCREW BSW THREAD AS PER (BS 2470)

TABLE - 6B

| DIA | 1/2" | 3/4" | 1" | 1.1/4" | 1.1/2" | 2" | 2.1/2" | 3" |
|-------|------|------|------|--------|--------|-------|--------|-------|
| 3/16" | 704 | 836 | 924 | 1012 | 1188 | 1320 | - | - |
| 1/4" | 880 | 880 | 1012 | 1100 | 1276 | 1452 | 1804 | - |
| 5/16" | - | 2024 | 2200 | 2332 | 2684 | 3036 | 3564 | 4268 |
| 3/8" | - | 3344 | 3344 | 3520 | 4048 | 4576 | 5280 | 6336 |
| 1/2" | - | - | 7216 | 7920 | 10560 | 14080 | 16720 | 17600 |

STAINLESS STEEL 304-A2 ALLEN GRUB SCREW (DIN 916)

TABLE - 6C

| DIA | 3 | 4 | 5 | 6 | 8 | 10 | 12 | 16 | 20 | 25 | 30 | 35 | 40 | 45 | 50 | 55 | 60 | 65 |
|-----|-----|-----|-----|-----|------|------|------|------|------|------|-------|-------|-------|-------|-------|-------|-------|-------|
| 3 | 142 | 128 | 132 | 142 | 164 | 195 | 267 | 534 | 711 | - | - | - | - | - | - | - | - | - |
| 4 | 192 | 151 | 159 | 174 | 210 | 237 | 285 | 385 | 502 | 686 | 916 | - | - | - | - | - | - | - |
| 5 | 256 | 184 | 192 | 219 | 275 | 331 | 385 | 530 | 686 | 988 | 1234 | 1554 | 1968 | - | - | - | - | - |
| 6 | - | 290 | 255 | 265 | 335 | 414 | 502 | 687 | 880 | 1172 | 1471 | 1761 | 2202 | 2819 | 3523 | - | - | - |
| 8 | - | - | - | 485 | 573 | 706 | 880 | 1233 | 1586 | 2115 | 2642 | 3039 | 3479 | 4097 | 4845 | 5639 | 6092 | - |
| 10 | - | - | - | 846 | 846 | 1018 | 1255 | 1780 | 2329 | 3050 | 3768 | 4574 | 5505 | 6352 | 7201 | 8046 | 9317 | - |
| 12 | - | - | - | - | 1524 | 1566 | 2551 | 2625 | 3430 | 4447 | 5463 | 6606 | 7623 | 8892 | 10164 | 11435 | 13127 | 16939 |
| 16 | - | - | - | - | - | - | 6098 | 6775 | 7877 | 8892 | 10587 | 12281 | 13976 | 15247 | 16939 | 18634 | 20751 | - |

STAINLESS STEEL 304-A2 BUTTON HEAD CAP SCREW (ISO 7380)

TABLE - 6D

| DIA | 8 | 10 | 12 | 16 | 20 | 25 | 30 | 35 | 40 | 50 | 60 |
|-----|-----|-----|-----|------|------|------|------|------|------|-------|-------|
| 3 | 162 | 165 | 187 | 235 | 282 | 319 | - | - | - | - | - |
| 4 | 214 | 213 | 251 | 297 | 348 | 411 | 504 | 584 | 702 | - | - |
| 5 | 313 | 375 | 387 | 470 | 533 | 609 | 702 | 815 | 901 | - | - |
| 6 | - | 461 | 489 | 580 | 685 | 820 | 951 | 1099 | 1238 | 1665 | - |
| 8 | - | - | - | 1272 | 1385 | 1639 | 1911 | 2116 | 2443 | 2801 | 3228 |
| 10 | - | - | - | - | 2633 | 2925 | 3425 | 3794 | 3969 | 4530 | 5410 |
| 12 | - | - | - | - | 5782 | 6363 | 6908 | 7672 | 8953 | 10328 | 11860 |

Stainless steel fastners : Rates in rupees per 100 pcs

STAINLESS STEEL 304-A2 PAN PHILIPS (DIN 7981) TABLE - 7A
PAN SLOTTED (DIN 7971) SELF TAPPING SCREW

| DIA | 4 | 6 | 8 | 10 | 12 | 14 |
|-----|-----|-----|-----|-----|------|------|
| 6.5 | 135 | 176 | - | - | - | - |
| 9.5 | 148 | 188 | 261 | - | - | - |
| 13 | 157 | 206 | 295 | 394 | 607 | - |
| 16 | 178 | 239 | 324 | 425 | 674 | 884 |
| 19 | 227 | 284 | 352 | 477 | 752 | 968 |
| 25 | - | 344 | 431 | 581 | 884 | 1179 |
| 32 | - | 403 | 527 | 688 | 1074 | 1408 |
| 38 | - | - | 623 | 802 | 1237 | 1568 |
| 50 | - | - | 802 | 990 | 1568 | 1812 |

STAINLESS STEEL 304-A2 CSK PHILIPS (DIN 7982) TABLE - 7B
CSK SLOTTED (DIN 7972) SELF TAPPING SCREW

| DIA | 4 | 6 | 8 | 10 | 12 | 14 |
|-----|-----|-----|-----|-----|------|------|
| 6.5 | 114 | 140 | - | - | - | - |
| 9.5 | 131 | 163 | 215 | - | - | - |
| 13 | 148 | 182 | 247 | 310 | 463 | - |
| 16 | 168 | 211 | 274 | 342 | 534 | 652 |
| 19 | - | 249 | 313 | 408 | 604 | 759 |
| 25 | - | 316 | 395 | 511 | 754 | 950 |
| 32 | - | 375 | 484 | 599 | 937 | 1212 |
| 38 | - | - | 568 | 729 | 1084 | 1391 |
| 50 | - | - | 785 | 940 | 1510 | 1760 |

STAINLESS STEEL 304-A2 DOM NUT (DIN 1587)

TABLE - 7C

| SIZE | M 3 | M 4 | M 5 | M 6 | M 8 | M 10 | M 12 | M 16 | M 20 | M 24 |
|------|-----|-----|-----|-----|------|------|------|-------|-------|-------|
| 304 | 393 | 393 | 476 | 770 | 1470 | 3123 | 4933 | 13527 | 25674 | 55262 |

STAINLESS STEEL 304-A2 NYLOCK NUT (DIN 982 / DIN 985)

TABLE - 7D

| SIZE | M 3 | M 4 | M 5 | M 6 | M 8 | M 10 | M 12 | M 16 | M 20 | M 24 | M 30 |
|------|-----|-----|-----|-----|-----|------|------|------|-------|-------|-------|
| 304 | 263 | 266 | 346 | 541 | 977 | 1841 | 2829 | 6208 | 16056 | 49421 | 89640 |

STAINLESS STEEL 304-A2 SQUARE NUT (DIN 557) TABLE - 7E

| DIA | M5 | M6 | M8 | M10 | M12 |
|------|-----|-----|-----|------|------|
| 304Q | 396 | 396 | 856 | 1880 | 2864 |

STAINLESS STEEL 304-A2 HEX NUT (H=D)

| SIZE | M6x6 | M8x8 | M10x10 | M12x12 | M16x16 | M18x18 | M20x20 | M22x22 | M24x24 |
|------|------|------|--------|--------|--------|--------|--------|--------|--------|
| 304Q | 362 | 725 | 1596 | 2328 | 4767 | 8129 | 10267 | 14685 | 16500 |

TABLE - 7F
STAINLESS STEEL 304-A2 FLANGE NUT (DIN 6923) TABLE - 7G

| DIA | M5 | M6 | M8 | M10 | M12 |
|------|-----|-----|------|------|------|
| 304Q | 390 | 456 | 1011 | 1740 | 2944 |

STAINLESS STEEL 304-A2 WELD NUT (DIN 929) TABLE - 7H

| DIA | M5 | M6 | M8 | M10 | M12 |
|------|-----|-----|------|------|------|
| 304Q | 390 | 456 | 1011 | 1740 | 2944 |

STAINLESS STEEL 304-A2 HEAVY HEX NUT (ANSI B18.2.2)

| DIA | 5/16" UNC | 3/8" UNC | 1/2" UNC | 5/8" UNC | 3/4" UNC | 7/8" UNC | | |
|------|-----------|----------|----------|----------|----------|----------|--|--|
| 304Q | 1610 | 2257 | 3447 | 6944 | 11770 | 17233 | | |

TABLE - 7I
STAINLESS STEEL 304-A2 WING NUT (DIN 315) LIGHT

| SIZE | M 3 | M 4 | M 5 | M 6 | M 8 | M 10 | M 12 |
|------|------|------|------|------|------|------|------|
| 304 | 1398 | 1400 | 1520 | 1935 | 3001 | 3782 | 8352 |

TABLE - 7J
STAINLESS STEEL 304-A2 WING NUT (HEAVY)

| DIA | M5 | M6 | M8 | M10 | M12 | M16 | M20 | M24 |
|-------|-------|------|-------|-------|-------|-------|-------|--------|
| HEAVY | 6417 | 6845 | 11123 | 14032 | 23529 | 35935 | 72726 | 106266 |
| DIA | 3/16" | 1/4" | 5/16" | 3/8" | 1/2" | 5/8" | 3/4" | 1" |
| HEAVY | 6417 | 6845 | 11123 | 14032 | 23529 | 35935 | 72726 | 106266 |

TABLE - 7K

Stainless steel fasteners : Rates in rupees per 100 pcs

STAINLESS STEEL 316-A4 HEX SCREW (DIN 933 / IS 1363)

TABLE - 8A

| DIA | 10 | 12 | 16 | 20 | 25 | 30 | 35 | 40 | 45 | 50 | 55 | 60 | 65 | 70 | 75 | 80 | 85 | 90 | 100 |
|-----|-----|-----|------|------|-------|-------|-------|-------|-------|-------|-------|-------|-------|-------|-------|-------|-------|-------|-------|
| 6 | 718 | 731 | 825 | 931 | 1038 | 1159 | 1281 | 1398 | 1556 | 1688 | 1858 | 1956 | 2165 | 2279 | 2462 | 2565 | 2892 | 2960 | 3246 |
| 8 | - | - | 1686 | 1882 | 2084 | 2294 | 2504 | 2728 | 2994 | 3199 | 3446 | 3633 | 3918 | 4070 | 4343 | 4587 | 4976 | 5123 | 5515 |
| 10 | - | - | 3158 | 3458 | 3776 | 4113 | 4467 | 4803 | 5118 | 5482 | 5826 | 6186 | 6659 | 6871 | 7397 | 7611 | 8178 | 8325 | 8890 |
| 12 | - | - | - | 5219 | 5627 | 6130 | 6641 | 7152 | 7467 | 8170 | 8469 | 9177 | 9451 | 10192 | 10732 | 11304 | 11649 | 12393 | 13437 |
| 14 | - | - | - | - | 8739 | 9304 | 9994 | 10546 | 11297 | 11951 | 12809 | 13271 | 14220 | 14774 | 15520 | 16256 | 17685 | 18592 | 19124 |
| 16 | - | - | - | - | 11384 | 11939 | 12800 | 13737 | 14593 | 15575 | 16496 | 17540 | 18232 | 19194 | 20047 | 21394 | 22356 | 23310 | 24951 |
| 18 | - | - | - | - | - | - | - | 20659 | 22081 | 23504 | 24927 | 26350 | 27772 | 29195 | 30618 | 32041 | 33464 | 34886 | 37732 |
| 20 | - | - | - | - | - | - | - | 23980 | 25779 | 27084 | 28140 | 29643 | 31247 | 33034 | 34453 | 36090 | 37496 | 39016 | 41843 |
| 22 | - | - | - | - | - | - | - | 34071 | 36304 | 38536 | 40769 | 42502 | 44709 | 46915 | 49122 | 51329 | 53536 | 55742 | 60156 |
| 24 | - | - | - | - | - | - | - | - | - | 42502 | 44856 | 47179 | 49418 | 51880 | 53993 | 56286 | 58547 | 58986 | 63503 |

STAINLESS STEEL 316-A4 HEX SCREW (BS - 1083)

TABLE - 8B

| BSW | 1/2" | 3/4" | 1" | 1.1/4" | 1.1/2" | 2" | 2.1/2" | 3" | 3.1/2" | 4" | 5" | 6" | 7" | 8" |
|-------|------|------|-------|--------|--------|-------|--------|-------|--------|-------|--------|--------|--------|--------|
| 1/4" | 923 | 1073 | 1242 | 1439 | 1590 | 1930 | 2399 | 2773 | 3055 | 3469 | - | - | - | - |
| 5/16" | 1637 | 1885 | 2163 | 2438 | 2720 | 3265 | 3828 | 4392 | 5084 | 6144 | - | - | - | - |
| 3/8" | 2545 | 2916 | 3305 | 3712 | 4120 | 4927 | 5731 | 6541 | 7342 | 8155 | 10396 | 12445 | - | - |
| 1/2" | - | - | 7001 | 7748 | 8434 | 9837 | 11289 | 12744 | 14180 | 15580 | 18422 | 20980 | - | - |
| 5/8" | - | - | 12792 | 13269 | 14337 | 16759 | 18859 | 22048 | 23121 | 25191 | 31084 | 35710 | - | - |
| 3/4" | - | - | - | - | 28303 | 31216 | 35014 | 38860 | 42668 | 46653 | 54428 | 62204 | - | - |
| 7/8" | - | - | - | - | - | 41652 | 47775 | 53080 | 58971 | 64739 | 76024 | 87665 | 98345 | 109808 |
| 1" | - | - | - | - | - | 58526 | 65807 | 72980 | 80064 | 88929 | 103098 | 118281 | 133464 | 148648 |

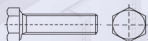
STAINLESS STEEL 316-A4 LONG LENGTH HEX SCREW (DIN 933 / IS 1363)

TABLE - 8C

| DIA | 110 | 120 | 125 | 130 | 140 | 150 | 160 | 170 | 175 | 180 | 190 | 200 |
|-----|-------|-------|-------|-------|-------|-------|-------|-------|--------|--------|--------|--------|
| 8 | 6082 | 6520 | 6729 | 7029 | 7576 | 8049 | - | - | - | - | - | - |
| 10 | 9898 | 10723 | 11113 | 11448 | 12061 | 12752 | 14005 | 16180 | 16416 | 17605 | 18437 | 19268 |
| 12 | 14074 | 15213 | 15899 | 16610 | 17556 | 18803 | 19934 | 26743 | 27863 | 28984 | 31592 | 34200 |
| 14 | 22353 | 24058 | 24911 | 25764 | 27470 | 29175 | 30881 | 32586 | 34292 | 35998 | 37703 | 39409 |
| 16 | 27258 | 29241 | 30195 | 31129 | 32875 | 35324 | 37615 | 41517 | 43207 | 44897 | 46817 | 48738 |
| 18 | 40577 | 43423 | 44846 | 46268 | 49114 | 51960 | 54805 | 59073 | 60493 | 63342 | 67610 | 71878 |
| 20 | 45950 | 48832 | 50327 | 52099 | 55209 | 58482 | 61140 | 64330 | 65793 | 67255 | 72299 | 77343 |
| 22 | 64569 | 68983 | 71189 | 73396 | 77810 | 82223 | 86637 | 91050 | 93257 | 95464 | 99877 | 104291 |
| 24 | 70087 | 74760 | 77133 | 79662 | 84267 | 88892 | 93450 | 97840 | 100251 | 102663 | 107401 | 112140 |

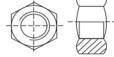
Stainless steel fasteners : Rates in rupees per 100 pcs

STAINLESS STEEL 316-A4 HEX NUT (DIN 934 / IS 1363)

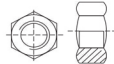
TABLE - 9A

| SIZE | M 2 | M 2.5 | M 3 | M 4 | M 5 | M 6 | M 8 | M 10 | M 12 | M 14 | M 16 | M 18 | M 20 | M 22 | M 24 | M 27 | M 30 | M 33 | M 36 |
|------|-----|-------|-----|-----|-----|-----|-----|------|------|------|------|------|------|-------|-------|-------|-------|-------|-------|
| 316 | 333 | 329 | 149 | 197 | 250 | 387 | 783 | 1637 | 2552 | 4344 | 5105 | 9717 | 9717 | 16256 | 16256 | 30232 | 38074 | 48081 | 65778 |

STAINLESS STEEL 316-A4 HEX NUT (BS 1083)

TABLE - 9B

| DIA | 1/8" | 5/32" | 3/16" | 1/4" | 5/16" | 3/8" | 7/16" | 1/2" | 5/8" | 3/4" | 7/8" | 1" |
|------|------|-------|-------|------|-------|------|-------|------|------|-------|-------|-------|
| 316Q | 275 | 301 | 303 | 595 | 860 | 1412 | 3269 | 3738 | 6713 | 12114 | 15048 | 23180 |

STAINLESS STEEL 316-A4 LOCK NUT (DIN 439)

TABLE - 9C

| DIA | M5 | M6 | M8 | M10 | M12 | M14 | M16 | M18 | M20 | M22 | M24 |
|------|-----|-----|-----|------|------|------|------|------|------|-------|-------|
| 316Q | 269 | 371 | 756 | 1279 | 2500 | 4022 | 5008 | 9842 | 9842 | 16607 | 16607 |

STAINLESS STEEL 316-A4 DOM NUT

TABLE - 9D

| DIA | M5 | M6 | M8 | M10 | M12 | M16 | M20 | M24 |
|------|-----|------|------|------|------|-------|-------|-------|
| 316Q | 745 | 1194 | 2573 | 4495 | 7103 | 19238 | 35406 | 75396 |

STAINLESS STEEL 316-A4 HEX NYLOCK NUT (DIN 982 / DIN 985)
TABLE - 9E

| DIA | M3 | M4 | M5 | M6 | M8 | M10 | M12 | M16 | M20 | M24 |
|------|-----|-----|-----|-----|------|------|------|------|-------|-------|
| 316Q | 380 | 386 | 501 | 785 | 1417 | 2669 | 4102 | 9002 | 19771 | 67119 |

STAINLESS STEEL 316-A4 HEAVY HEX NUT (ANSI B18.2.2)
TABLE - 9F

| DIA | 5/16" UNC | 3/8" UNC | 1/2" UNC | 5/8" UNC | 3/4" UNC | 7/8" UNC |
|------|-----------|----------|----------|----------|----------|----------|
| 316Q | 2110 | 2801 | 4840 | 9556 | 16317 | 23205 |

STAINLESS STEEL 316-A4 HEIGHT DIA NUT (DIN 5587)
TABLE - 9G

| SIZE | M6 X 6 | M8 X 8 | M10 X 10 | M12 X 12 | M16 X 16 | M18 X 18 | M20 X 20 | M22 X 22 | M24 X 24 |
|------|--------|--------|----------|----------|----------|----------|----------|----------|----------|
| 316Q | 496 | 1019 | 2239 | 3278 | 6757 | 13363 | 14067 | 21347 | 22471 |

STAINLESS STEEL 316-A4 THREADED ROD 1 MTR LENGTH (DIN 975)
TABLE - 9H

| SIZE | M 6 | M 8 | M 10 | M 12 | M 14 | M 16 | M 18 | M 20 | M 22 | M 24 |
|------|-------|-------|-------|-------|--------|--------|--------|--------|--------|--------|
| 316 | 24770 | 42758 | 66917 | 97689 | 150304 | 178444 | 254100 | 278819 | 363611 | 430629 |

STAINLESS STEEL 316-A4 THREADED ROD 1 MTR LENGTH (BS 1083 / ANSI B18.2.1)
TABLE - 9I

| DIA | 1/4" | 5/16" | 3/8" | 1/2" | 5/8" | 3/4" | 7/8" | 1" |
|------|-------|-------|-------|--------|--------|--------|--------|--------|
| 316Q | 28852 | 44200 | 64422 | 119311 | 183300 | 267078 | 368333 | 498478 |

Stainless steel fasteners : Rates in rupees per 100 pcs

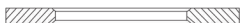
**STAINLESS STEEL 316-A4 PLAIN WASHER
(DIN 125 / IS 2016)**
TABLE - 10A

| THICK | 1.2MM | 1.6MM | 2MM | 2.5MM | 3MM | IS |
|--------------|-------|-------|------|-------|-------|-------|
| M3 (1/8") | 203 | - | - | - | - | 203 |
| M4 (5/32") | 217 | - | - | - | - | 217 |
| M5 (3/16") | 226 | 248 | - | - | - | 226 |
| M6 (1/4") | 280 | 334 | - | - | - | 334 |
| M8 (5/16") | 461 | 523 | 663 | 789 | 812 | 523 |
| M10 (3/8") | 655 | 880 | 1038 | 1354 | 1454 | 1038 |
| M12 (1/2") | 984 | 1070 | 1183 | 1692 | 1918 | 1692 |
| M14 (9/16") | 1670 | 1670 | 2076 | 2197 | 2762 | 2762 |
| M16 (5/8") | 1805 | 1805 | 2256 | 2649 | 3100 | 3100 |
| M18 | - | - | - | - | 3948 | 3948 |
| M20 (3/4") | - | - | - | - | 4513 | 4513 |
| M22 (7/8") | - | - | - | - | 5415 | 5415 |
| M24 (1") | - | - | - | - | 6769 | 8123 |
| M27 (1.1/8") | - | - | - | - | 7333 | 9025 |
| M30 (1.1/4") | - | - | - | - | 8461 | 10154 |
| M33 (1.3/8") | - | - | - | - | 9589 | 13538 |
| M36 (1.1/2") | - | - | - | - | 10041 | 15794 |

STAINLESS STEEL 316-A4 SPRING WASHER (DIN 127 / IS 3063)

| BSW | SQUARE | FLAT |
|--------------|--------|-------|
| M3 (1/8") | 203 | 248 |
| M4 (5/32") | 217 | 262 |
| M5 (3/16") | 248 | 284 |
| M6 (1/4") | 374 | 425 |
| M8 (5/16") | 542 | 735 |
| M10 (3/8") | 677 | 903 |
| M12 (1/2") | 1016 | 1580 |
| M14 (9/16") | 1413 | 1864 |
| M16 (5/8") | 1580 | 2653 |
| M18 | 2369 | 3669 |
| M20 (3/4") | 2537 | 3777 |
| M22 (7/8") | 3723 | 5190 |
| M24 (1") | 5235 | 7446 |
| M27 (1.1/8") | 6137 | 7897 |
| M30 (1.1/4") | 7382 | 9025 |
| M33 (1.3/8") | 8461 | 11846 |
| M36 (1.1/2") | 11168 | 15229 |

STAINLESS STEEL 316-A4 ALLEN CAP SCREW (DIN 912)

TABLE - 10C

| DIA | 6 | 8 | 10 | 12 | 16 | 20 | 25 | 30 | 35 | 40 | 45 | 50 | 60 | 70 | 75 | 80 | 90 | 100 |
|-----|-----|-----|-----|------|------|------|------|------|-------|-------|-------|-------|-------|-------|-------|-------|-------|-------|
| 3 | 411 | 425 | 434 | 442 | 506 | 560 | 658 | - | - | - | - | - | - | - | - | - | - | - |
| 4 | 551 | 552 | 489 | 528 | 593 | 664 | 736 | 916 | 1041 | 1210 | - | - | - | - | - | - | - | - |
| 5 | - | - | 681 | 718 | 814 | 906 | 1036 | 1184 | 1374 | 1586 | 1754 | 1921 | - | - | - | - | - | - |
| 6 | - | - | 986 | 1014 | 1126 | 1223 | 1342 | 1508 | 1642 | 1901 | 2097 | 2229 | 2711 | 3030 | 3333 | 3669 | 4250 | 5062 |
| 8 | - | - | - | 2336 | 2253 | 2372 | 2610 | 3000 | 3220 | 3467 | 3813 | 3996 | 4602 | 5309 | 5963 | 6362 | 7244 | 7771 |
| 10 | - | - | - | - | - | 4114 | 4660 | 4917 | 5349 | 5874 | 6259 | 6739 | 7604 | 8671 | 9124 | 9661 | 11945 | 13161 |
| 12 | - | - | - | - | - | - | 7449 | 7726 | 8281 | 8959 | 9772 | 10242 | 11572 | 12343 | 13428 | 14447 | 15651 | 17033 |
| 16 | - | - | - | - | - | - | - | - | 17138 | 18807 | 20365 | 21081 | 23673 | 25974 | 27569 | 30296 | 33364 | 36178 |
| 20 | - | - | - | - | - | - | - | - | - | 39125 | 40860 | 43506 | 48142 | 53097 | 55382 | 57831 | 62712 | 67617 |

TERMS & CONDITIONS :

1. This cancels our previous price list.
2. The all above prices are nett. Ex. Factory.
3. GST Tax as applicable extra.
4. Transport charges extra as applicable.
5. Prices may differ subjet to quantity order.
6. TC charges extra as applicable.

Stainless steel fastners : Rates in rupees per 100 pcs