



Sundram Fasteners Limited

RETAIL PRICE LIST

NO.SF/SOCKET/02/2022

SOCKET PRODUCTS-STANDARD APPLICATION

Effective 1st November 2022

SOCKET PRODUCTS

Marketing Office	Registered Office
Padi, Chennai 600050	98A, Dr.Radhakrishnan Salai, 7th Floor, Auras Corporate Centre, Mylapore, Chennai 600 004

Factories			
Padi Unit	Pondicherry Unit	Krishnapuram Unit	Uttarkhand Unit
Padi, Chennai 600050 GST No.: 33AAACS8779D1Z7	Korkadu, Villianur (via) Pondicherry 605110 GST No.: 34AAACS8779D1Z5	Krishnapuram, Aruppukottai Road, Aviyur 626 160 (TN) GST No.: 33AAACS8779D1Z7	Plot No. 60, Sector 11 Integrated Industrial Estate Sidcul, Pantnagar Rudrapur - 263153 Dist. Udham Singh Nagar Uttarakhand GST NO. 05AAACS8779D1Z6
WEF & INFRA UNIT			
135/3,136/1 - Mandagapattu Road, Mitta Mandagapattu Village Villupuram Dist. 605106 (TN) GST No: 33AAACS8779D1Z7			
CIN No. L359999TN1962PLC004943 GST No: 33AAACS8779D1Z7 www.sundram.com Email: marketing@fasteners.sfl.co.in			



intertek



GENERAL CONDITIONS FOR SALE

(RELATED TO PRICE LIST NO.SF/SOCKET/02/2022)

All quotations, purchase orders or requests are subject to the following terms and conditions of sale. Any qualifications to these conditions made by the Buyer will not apply unless expressly accepted in writing by Sundram Fasteners Limited (hereinafter, called as "SFL"). These General Terms and Conditions of Sale shall not be applicable where SFL and Buyer had entered into Product Sale/Purchase/Supply Agreement. In the event of any dispute, ambiguity in interpretation or claim between SFL and the Buyer the Product Sale/Purchase/Supply Agreement and its specific terms shall apply first. To the extent that the individual Product Sale/Purchase/Supply Agreement and its specific terms are silent, the General Terms and Conditions herein shall apply. If the General Terms and Conditions of Sale are silent, the general rules of the governing law shall apply and prevail.

1. ORDER AND ACCEPTANCE

All orders placed by the Buyer shall be subject to SFL's acceptance. SFL shall be at liberty to accept or refuse any order in full or in part without assigning any reasons whatsoever. Orders once accepted by SFL shall not be cancelled by the Buyer unless consented to or by SFL in writing. None of these terms and conditions may be added to, modified, superseded or otherwise altered, except by a written instrument signed by an authorized signatory of SFL. SFL's failure to object to any of the terms and conditions which may be contained in any document of Buyer shall not be construed as a waiver of these conditions or as acceptance of any such terms and conditions.

2. PRICES AND PAYMENT

- 2.1 Prices prevailing on the date of dispatch of Goods will become applicable irrespective of the fact that Purchase order/delivery order/advance payment for the same been accepted/issued by SFL.
- 2.2 SFL reserves the right to revise the prices of Goods without any further advance notice to the Buyer or without assigning any reasons thereof.
- 2.3 SFL shall not be responsible for costs, charge, expenses, losses etc., if any, incurred by the Buyer.
- 2.4 The Prices are exclusive of GST as applicable on the Goods supplied. SFL shall collect TCS as applicable on the Goods supplied to Buyer.
- 2.5 Any taxes, cess or duties levied by Central, State, Municipal, Local or any other authority, in effect or hereinafter imposed, on the sale, transportation or delivery of the Products delivered hereunder shall be paid by Buyer, and, if directly paid by SFL, reimbursed to SFL by Buyer with retrospective or prospective effect.
- 2.6 The Cheque/Drafts/Pay Orders not accepted unless otherwise specifically agreed in writing. The Cheque/Drafts/Pay orders should be drawn by the Buyer in favour of Sundram Fasteners Limited. SFL shall not be liable to loss or theft of Cheque/Drafts/Pay orders etc., in transit.
- 2.7 Payment terms are net thirty (30) days from the date of the invoice or as mutually agreed in writing.
- 2.8 Any payments not made within due date shall be subject to a late payment charge for the period of delay beyond due date, penal interest at 18 % per annum.
- 2.9 SFL reserves its right to appropriate and adjust any sums due to the Buyer against any dues recoverable from the Buyer including delayed payment charges, if any.
- 2.10 All stipulations as to time of payment of the purchase price of Goods are the essence of the Contract.

3. LOSS OR DAMAGE

Unless otherwise agreed, the risk in the Goods shall pass from SFL to the Buyer the moment they are delivered by SFL to the Buyer or to a Carrier or any other party including Warehouse operated/identified for the purpose (whether named by the Buyer or not) including risk associated with any Goods subsequently returned to SFL. SFL accepts no liability for loss or damage to Goods once handed over to the Buyer or Carrier any other party including Warehouse operated/identified for the purpose instructed/chosen by Buyer.

4. PACKING AND TRANSPORTATION

- 4.1 Unless otherwise specified by the Buyer, SFL will select the most economical method and route of shipment. In the event that the Buyer is unable or unwilling to take delivery of all or any part of the Goods, SFL shall place them into storage with all costs, including storage, insurance, demurrage, and transportation at the Buyer's expense.
- 4.2 Packing will be in accordance with SFL/Industry standard practice and Prices quoted are for packing in cartons. SFL retains ownership of any re-usable packaging.

5. DELIVERY AND ACCEPTANCE

- 5.1 The delivery dates are tentative and no responsibility is accepted by SFL for delay in delivery or failure to deliver as per delivery schedule due to circumstances beyond SFL's control. Delivery/Despatch may be made in one lot or several lots and if made in several lots payment should be made in terms of the payment clause.
- 5.2 Goods supplied shall be deemed to have been supplied as per the Buyer's specifications unless the Buyer, within 48 hours from the receipt of the Goods give SFL a written notice of any claim, that the Goods are not of stated description or specification to enable SFL to investigate and take appropriate action.
- 5.3 SFL will not be responsible for any shortage/damages notices after delivery has been taken by the Buyer and not reported on the back side of "Lorry Receipt" of Transporter.
- 5.4 The Buyer shall provide SFL with the appropriate tax forms/declarations along with payment and shall indemnify SFL against any losses, charges, expenses for non-submissions of the forms.
- 5.5 The Goods shall be dispatched at such times and in such convenient lots and quantities as SFL shall decide. SFL shall be entitled to cancel an order in whole or in part even if it has been partly executed. Each lot dispatched against a single order shall be considered as a separate contract and failure of dispatch of any one lot or of the balance lots shall not violate the contract as to other lots. The order shall be deemed to have been completed on the date of dispatch in respect of the products actually dispatched in part/full.
- 5.6 SFL shall not be responsible for delays in dispatch of the Goods for any reason whatsoever and the conditions of dispatch and delivery timing of the same. SFL shall not be liable to make good the loss, if any suffered by the Buyer for delay in dispatch or delivery of the Goods.
- 5.7 If the Buyer failed to take delivery of the Goods at the rate, date and time specified herein when the delivery becomes due, then SFL will have the option to cancel the delivery and to claim damages, if any.
- 5.8 Claims by Buyer for shortages or errors in delivery must be made within five (5) days after the delivery of the Goods. Goods are sold subject to the standard manufacturing practices of SFL. Goods purchased on the basis of weight are subject to customary quantity variations recognized by practice in the industry.
- 5.9 If Buyer requests deferral of deliveries, SFL's agreement to defer delivery shall not excuse Buyer from its obligation to pay for the Goods at the same times and in the same quantities as the original delivery schedule, including interest due pursuant to these terms and conditions. In addition to adhering to the original payment schedule, Buyer shall pay such storage charges as SFL may assess for storing the Goods awaiting delivery. If Buyer requests deferral prior to commencement of production, SFL may require progress payments in connection with expenses for materials and services incurred by SFL in anticipation of production.
- 5.10 In no case shall delay or non-delivery of the whole or part of the order be a valid ground for the Buyer to reject or withhold payment for the Goods.

6. WARRANTY

- 6.1 All Goods sold subject to the conditions that SFL's liabilities are limited to the replacement of Goods proved to have been defective in material and/or workmanship, when they are sent back to SFL, but SFL will not be responsible for failure of Goods supplied which have been subject to improper use and/or any process or processes.
- 6.2 SFL accepts no responsibility for any contingent or resulting liabilities or loss arising through any defective Goods.
- 6.3 Any claim for replacement will arise only if the Goods are returned within 30 days from the date of Supply.



- 6.4 All other warranties, express or implied, including but not limited to the implied warranties of merchantability and fitness for a particular purpose, are hereby disclaimed.
- 6.5 Any claims for failure of Goods to conform to specifications, shortages, or any other cause shall be deemed waived and released by Buyer unless such claim is made in writing within thirty (30) days from the date of receipt of Goods.
- 6.6 SFL's decision on the cause for any such defects is final and binding.
- 6.7 SFL will not be responsible for failure of Goods supplied which are manufactured to the print, design, technical specification of the Buyer or sample/prototype approved by Buyer and/or any process or processes prescribed by Buyer.

7. LIMITATION OF LIABILITY

SFL's liability to Buyer, whether in contract, in tort, under any warranty, in negligence or otherwise, shall not exceed in any case the return of the amount of the purchase price paid by Buyer and under no circumstances SFL be liable for special, in direct or consequential damages. The price stated for the Goods is consideration for limiting SFL's liability. No action, regardless of form, arising out of the transactions under the invoice may be brought by Buyer more than one (1) year after the date of the invoice. Without limitation of the foregoing, in no event will SFL be responsible or liable for (a) penalties or penalty clauses of any description, or (b) indemnification of Buyer or others for costs, damages or expenses arising out of or related to the Goods.

8. INDEMNIFICATION

Buyer shall save and hold SFL harmless from any claims, demands, liabilities, costs, expenses or judgments arising in whole or in part, directly or indirectly, out of breach of obligations, non-compliance any statute/act/rules, negligence, any act or omission, lack of care by Buyer or Buyer's customers, agents, employees or invitees involving the handling, use, possession or resale of the Goods supplied by SFL whether used alone or in combination with other Products. This indemnification shall include all costs, attorney's fees and other expenses paid or incurred by or imposed upon SFL in connection with the defense of any such claim.

9. FORCE MAJEURE

SFL shall not be liable in any way for any damage, loss, cost or expense arising out of or in connection with any delay, restriction, interference or failure in performing any obligation towards supply or delivery of Goods caused by any circumstance beyond its reasonable control, including, without limitation, acts of God, laws and regulations, administrative measures, orders or decrees of any court, earthquake, flood, fire, explosion, war, terrorism, riot, sabotage, accident, epidemic, strike, lockout, slowdown, labour disturbances, geo-political events, business exigencies, difficulty in obtaining necessary labour or raw materials, lack of or failure of transportation, breakdown of plant or essential machinery, emergency repair or maintenance, breakdown or shortage of utilities, delay in delivery or defects in Goods supplied by suppliers or subcontractors ("Force Majeure"). Any failure in performing any obligations shall not entitle the Buyer to cancel the Order.

10. INTELLECTUAL PROPERTY RIGHTS

- 10.1 The sale of Goods to Buyer shall not, by implication or otherwise, convey any license or intellectual property right relating to the Goods to Buyer.
- 10.2 When Goods are manufactured to Buyer's drawings and/or specifications, the responsibility to ensure that these do not result in infringement of any patent or trademark will lie entirely with the Buyer concerned and the Buyer will be solely responsible for the consequence in case of any such infringement.
- 10.3 SFL owns and retains all right, title and interest in and to any patents, copyrights, mask works, trade secrets, trademarks and other intellectual property rights in and to the Goods. The Buyer is not permitted to use any SFL's trademark, logo or trade name in its letter head, business cards, printed materials, business communication letters or in connection with any Goods, other than with respect to resale of Goods pre-marked or packaged by or on behalf of SFL without prior written consent of SFL.
- 10.4 SFL shall not be liable for any loss or damage for infringement of Intellectual Property Rights.

11. CONFIDENTIALITY

All information disclosed by SFL which is either expressly identified as confidential or by its nature is implicitly confidential will be kept in strict confidence by the Buyer and not used by the Buyer.

12. APPLICABLE LAW, JURISDICTION & ARBITRATION

- 12.1 Any dispute which may arise from and for any Goods supplied to Buyer shall be governed by the Indian laws and subject to the exclusive jurisdiction of the Courts at Chennai.
- 12.2 Any dispute in connection with or arising between the parties fail to amicably resolve shall be referred to arbitration of a sole arbitrator to be appointed jointly by the parties in accordance with the Indian Arbitration and Conciliation Act, 1996 or statutory modification or enactment thereof. The award of the arbitrator shall be final and binding on the Parties. The place of arbitration shall be Chennai, India, and the language of arbitration proceedings shall be English. Each party irrevocably and unconditionally submits to the jurisdiction of the Courts in Chennai, India, alone to determine any question that may arise other than a matter as provided for hereinabove.

13. MISCELLANEOUS

- 13.1 All notices or documents addressed to the Buyer shall be deemed to have been validly served if delivered at/or sent by post to their last known address. SFL will not be responsible for any demurrage etc., on consignment due to public holidays, postal delays, etc. or any other reasons beyond SFL's control.
- 13.2 In case the Buyer fails to make payment on or before Due Date, the Buyer shall be fully responsible for all the consequential losses to SFL including loss of Goods, interest, freight, taxes, duties and any other charges required to be borne by SFL.
- 13.3 If the Buyer fails to make the payment when it becomes due or if there is any breach by the Buyer of any terms and conditions, SFL may without prejudice to the other rights or remedies cancel this order forthwith or refuse to make further deliveries; in which SFL shall not be held responsible in anyway.
- 13.4 SFL shall have lien on the Goods delivered/supplied to the Buyer as to the unpaid purchase price of Goods (whether in possession or not in possession) and SFL shall be entitled to exercise the lien to recover the unpaid purchase price by taking back the Goods and shall be entitled to sell the same to any other Buyer and adjust the sum so realised against the unpaid purchase price without prejudice to SFL's other rights and remedies to recover the outstanding dues and/or other dues.
- 13.5 SFL reserves its right to appropriate and adjust any sums due to the Buyer against any dues recoverable from the Buyer including delayed payment charges, if any.
- 13.6 The rights and liabilities are not assignable by Buyer in whole or part without prior written consent of SFL.
- 13.7 Any provision hereof prohibited by law shall be ineffective to the extent of such prohibition and without invalidating the remaining provision hereof.
- 13.8 No waiver by SFL of a breach of any provision hereof shall constitute a waiver of any other breach of such provision or any other provision.
- 13.9 Buyer shall be responsible for compliances of law as applicable.
- 13.10 The price mentioned in the Invoice supersedes the list circulated and all the previous price lists and any other price communication.
- 13.11 The prices are for Zinc phosphate, Trivalent (Chrome free) Finish.
- 13.12 The Buyer will adhere to the minimum ordering quantities, i.e. standard packing.
- 13.13 Revision in price if any will be intimated from time to time in the form of Sales Bulletins.

Please quote correct SFL Part Number and Description of items while ordering. For any grievance, claim or clarification please write to - vasudevan.r2@sfl.co.in (Email-ID) and also contact the SFL's Marketing Dept.



SFL Retail Claim Policy 2022-23

1st Apr 2022

This Claim Policy document provides the guidelines on reporting the discrepancy claims by SFL Retail Customers for the goods dispatched from SFL Plants across India

Claim Types – The below are the various types of problems for which a customer can register a formal complaint

- ñ Consignment not received (A)
- ñ Partial Consignment received (B)
- ñ Secondary Carton Shortage (C)
- ñ Open Box Receipt (D)
- ñ Quantity Shortage (E)
- ñ Invoice / LR Not received (F)
- ñ Wrong Consignment Received (H)

CLAIM LODGING PROCESS:

Process for Lodging Discrepancy Complaints – The complaints can be lodged in the prescribed complaint format provided by SFL. The claim sheet can be either scanned or emailed as an excel sheet to the earmarked SFL Claim Desk and the respective Marketing personnel at SFL.

SFL Claim Desk claimsfld@sfl.co.in

Timeline for Registering Complaints – All complaints need to be lodged in the prescribed complaint format within 15 days from receipt of material since all consignments are door delivered at customer end by SFL, which is mandatory as per GST Norms. If any claims are lodged after the stipulated days specified above claims will not be processed.

CLAIM SETTLEMENT PROCESS:

Short/Excess Receipt complaints:

- ñ The first step in order to start the claims process is to register a complaint in the format provided. (refer annexure A)
- ñ Customer should compulsorily provide their Unique Claim reference number for every claim reported to SFL
- ñ ****Customer should compulsorily provide the photos of the DA labels pasted on the Master Cartons/ MRP Labels pasted on the Primary Cartons without which claims will not be processed**
- ñ Within 7 working days, SFL will respond back to the customer on whether the claim has been accepted or rejected with valid proof
- ñ For Claims accepted, SFL will register the claim as appropriate shortage and to raise an invoice on the excess receipt materials if any reported by the customer and the **Claim registration**



- number (CMR/MRN No.) and excess claim order acknowledgement will be notified to the customer
- ñ ****In case of Wrong / Excess receipt reported by the customer, customer has the option to notify the acceptance of wrong / excess receipt parts.**
 - ñ ****Customer has the option to return the wrong/excess received parts, by notifying the return in SFL Claim Format**
 - ñ ****Customer need to return materials only to the concerned SFL Plant from where supplies were received by them**
 - ñ ****Materials to be despatched on Door Delivery mode only on “To Pay” basis through the same SFL Transporter through whom they had received the supplies**
 - ñ ****Debit Note/Invoice raised by them on the respective SFL Plant should accompany the materials**
 - ñ ****Materials should strictly accompany with valid e way bills as per GST Norms which is mandatory**
 - ñ ****Customer should share the Debit Note/Invoice copy raised on SFL by duly sharing the same in soft form to SFL Claims Desk along with the duly filled in Claim Form**
 - ñ ****In the absence of valid Debit Note/Invoice on SFL, SFL will not entertain the settlement of credit notes for the short supplied materials**
 - ñ An unique complaint reference number (MRN No.) will be communicated to the customer within 3 working days upon receipt of the materials into SFL Plant along with the copies of the debit note/invoice copy of the returned material if any raised on SFL
 - ñ SFL will communicate the Credit Note Details and excess claim invoice details (in case of excess reported) within 15 working days to the customer

Material Returns:

- ñ ****Any materials returned by the customer should be notified to SFL Area Executive/Manager & HO and obtain their approval and then register the same in the complaint format provided. (refer annexure A)**
- ñ ****In the absence of non approval from the SFL Area Executive/Manager & HO, SFL will not entertain any claim settlements against the material returns**
- ñ SFL will respond to the customer duly authorizing the material returns only in case of valid reason for material return provided by the customer
- ñ ****Customer need to return materials only to the concerned SFL Plant from where supplies were received by them**
- ñ ****Materials to be despatched on Door Delivery mode only on “To Pay” basis through the same SFL Transporter through whom they had received the supplies**
- ñ ****Debit Note/Invoice raised by them on the respective SFL Plant should accompany the materials**
- ñ ****Materials should strictly accompany with valid e way bills as per GST Norms which is mandatory**



- ñ ****Customer should share the Debit Note/Invoice copy raised on SFL by duly sharing the same in soft form to SFL Claims Desk along with the duly filled in Claim Form**
- ñ ****In the absence of valid Debit Note/Invoice on SFL, SFL will not entertain the settlement of credit notes for the short supplied materials**
- ñ An unique complaint reference number (MRN No.) will be communicated to the customer within 3 working days upon receipt of the materials into SFL Plant along with the copies of the debit note/invoice copy of the returned material if any raised on SFL
- ñ SFL will communicate the Credit Note Details and excess claim invoice details (in case of excess reported) within 15 working days to the customer

Documentation Requirements for Type of Complaints:

Customer need to provide different types of documentation required for each claim type to facilitate smooth registration and settlement of the claims

- ñ Consignment not received (A) – Complaint through Mail reporting non receipt of consignments against specific invoice/LR is sufficient
- ñ ****Partial Consignment received (B) – While taking consignment delivery customer should write the number of boxes received on the LR Copy duly signed and stamped by the customer.**
- ñ ****Secondary Carton Shortage (C) – Complaint sufficient. Customer to indicate if the cartons were received in open / damaged condition. It is mandatory to provide the photo of the carton boxes received in open/damaged condition**
- ñ ****Open Box Receipt (D) Customer should write open boxes and number of short boxes on front of the LR Copy. It is mandatory to provide the photo of the carton boxes received in open/damaged condition**
- ñ ****Secondary Carton inner quantity Shortage (E) – It is mandatory to provide the photo of the Primary/Secondary carton boxes received which has short materials**
- ñ Invoice / LR Not received (F) – Complaint Sufficient
- ñ *****Wrong Consignment Received (H) – Complaint Required. Customer should compulsorily either refuse accepting the wrongly received consignments at the time of delivery being attempted by the transporter or can notify SFL Claims Desk on Wrong Consignment receipt by providing a photo of the labels pasted on the Master cartons for which SFL will organize pick up of wrongly delivered consignment. In any case customer should not absorb/inward the wrongly delivered consignment and should inform SFL by lodging complaint with SFL Claims Desk**



R.Vasudevan

DGM – Marketing

Sundram Fasteners Limited

MTH Road - Padi,

Chennai 600 050

Tamilnadu, India.

E Mail: vasudevan.r2@sfl.co.in

Mobile: 98407 06124

Phone: +91-44-26258460 Extn: 435

1st November 2022

Dear Customer,

Our price list number **NO.SF/SOCKET/02/2022 effective 1st November 2022** is given in this booklet.

While care is taken to ensure correctness of this price list, we would be pleased if you could communicate your suggestions and improvements of the same.

We are proceeding with limited print hence physical circulation will be restricted with limited copies, while e-price list will be made available.

We welcome your suggestions to upgrade the content of this price list and request you to send in the same to vasudevan.r2@sfl.co.in

Finally, we reserve the right to change any part of this price list without prior notice.

Thanking you and assuring you of our best attention always.

Yours truly,

R.Vasudevan

Deputy General Manager - Marketing



OUR DISTRIBUTORS AND THEIR BRANCHES

DISTRIBUTORS	Branches at:
<p>India Motor Parts & Accessories Ltd. ‘SUNDARAM TOWERS’ 45&46, Whites Road, Chennai - 600 014. Tel. : +91-44-28523996 / 28524097 Fax : +91-44-28523009</p>	<p>Agra, Agartala, Ahmedabad, Asansol, Aurangabad, Bangalore, Baroda, Bhubaneshwar, Bhilwara, Chandigarh, Chennai, Coimbatore, Cuttack, Dankuni, Dhanbad, Erode, Ernakulam, Gandhidham, Gorakhpur, Guwahati, Hissar, Hubli, Hyderabad, Indore, Jaipur, Jammu, Jodhpur, Jalandhar, Jamshedpur, Kannur, Kanpur, Kolkata, Kozhikode, Kota, Kolhapur, Kottayam, Kadapa, Karimnagar, Kumbakonam, Kurnool, Lucknow, Ludhiana, Madurai, Malda, Mangalore, Morigate (Delhi), Muzaffarpur, Mysuru, Nagpur, New Mumbai, Nanded, Patna, Pune, Purnea, Rajkot, Ranchi, Raipur, Redhills, Sambalpur, Salem, Sasaram, Shimoga, Silchar, Silliguri, Surat, Tinsukia, Tirunelveli, Tirupathi, Trichy, Trivandram, Thrissur, Udaipur, Varanasi, Vellore, Vijayapura, Vijayawada, Villupuram, Visakhapatnam.</p>
<p>Jullundur Motor Agency (Delhi) Ltd. 458-1/16, Sohna Road, Opp. New Court Gurgaon - 122 001. Tel. : +91-124-3099001/02/03 Fax : +91-124-5083079</p>	<p>Agra, Allahabad, Alwar, Amritsar, Asansol, Alampur, Baddi, Bareilly, Bangalore, Bathinda, Bhilwara, Bhubaneswar, Bikaner, Chandigarh, Cuttack, Dehradun, Ghaziabad, Gorakhpur, Gurgaon, Guwahati, Haldwani, Indore, Jabalpur, Jaipur, Jammu, Jamshedpur, Jodhpur, Jalandhar, Kanpur, Kashmir Gate (Delhi), Kolkata, Kota, Lucknow, Ludhiana, Muzaffarpur, Mysore, Mangalore, Ranchi, Patiala, Pathankot, Patna, Raipur, Rourkela, Saharanpur, Silchar, Siliguri, Tinsukia, Udaipur, Varanasi, Yeswantpur.</p>
<p>JMA Marketing Limited 2E/5 Jhandewalan Extension, New Delhi 110 055. Tel. : +91-11-23532985/41501425</p>	<p>Ahmedabad, Aurangabad, Baroda, Belgaum, Bellary, Bhiwandi, Chakan, Hubli, Kolhapur, Latur, Mumbai, Nagpur, Nasik, Pune, Rajkot, Shimoga, Surat, Solapur, Turbhe (Navi Mumbai), Nigdi.</p>
<p>Madras Auto Service A Division of T.S.Santhanam & Family Pvt. Ltd Plot No.6, S.P. (Developed Plot) Industrial Estate, Guindy, Chennai - 600 032 Phone: 91-44-69069815</p>	<p>Adimali, Allahabad, Ahmednagar, Aurangabad, Bangalore, Hosakote (Bangalore) Bareilly, Belagavi, Ballari, Bikaner, Cuddalore, Chandigarh, Chennai, Delhi, Dhulia, Coimbatore, Ernakulam, Erode, Margoa-Goa, Guntur, Gorakhpur, Gwalior, Hosur, Hubli, Hyderabad, Hissar, Indore, Jaipur, Jodhpur, Jammu, Jabalpur, Kanpur, Kannur, Kottayam, Kolhapur, Kurnool, Kukatpally, Kozhikode, Kumbakonam, Latur, Ludhiana, Lucknow, Mangalore, Madurai, Mysuru, Nagpur, Namakkal, Nellore, New Mumbai, Pollachi, Pune, Raipur, Rajahmundry, Redhills, Salem, Sikar, Shimoga, Trichy, Thrissur, Tirupathi, Tirunelveli, Trivandrum, Tumkur, Udaipur, Urapakkam, Varanasi, Vellore, Vijayawada, Visakhapatnam, Warangal.</p>
<p>Partap Singh & Sons 516/517, Parekh Market, JSS Road., Opera House, Mumbai - 400 004. Tel. : +91-22-43005002 Fax : +91-22-43005003</p>	<p>Agra, Ahmedabad, Ahmednagar, Amritsar, Aurangabad, Baroda, Bathinda, Bikaner, Bhiwandi, Bhopal, Chandigarh, Dehradun, Chakan, Ludhiana, Morigate (Delhi), Dhulia, Ponda - Goa, Gurgaon, Gandhidham, Indore, Kalamboli, Jaipur, Jammu, Jodhpur, Jabalpur, Jalandhar, Jasai, Kanpur, Kolhapur, Latur, Mumbai, Nagdevi, Nagpur, Nanded, Nasik, New Mumbai, Nigdi, Neemuch, Pathankot, Pune, Raipur, Rajkot, Sangli, Shirol, Solapur, Surat, Turbhe, Udaipur, Ulhasnagar, Vadodara, Vapi, Varanasi, Wadala.</p>
<p>Sundaram Motors A Division of T.S.Santhanam & Family Pvt. Ltd Plot No.6, S.P. (Developed Plot) Industrial Estate, Guindy, Chennai - 600 032 Phone: 91-44-69069845</p>	<p>Agartala, Bangalore, Ballari, Berhampore, Belagavi, Bolangir, Bardhaman, Berhampur, Chennai, Cuttack, Davanagere, Ponda - Goa, Auto Nagar (Hyderabad), Gaya, Guntur, Hubli, Jamshedpur, Jorhat, Kalaburagi, Karimnagar, Kadapa, Kolkata, Kolhapur, Mangalore, Mysuru, Malda, Muzaffarpur, Nagpur, Nasik, Nellore, New Mumbai, Poonamallee, Patna, Pune, Purnea, Ranchi, Rajahmundry, Rajkot, Redhills, Rourkela, Secunderabad, Shimoga, Siliguri, Silchar, Solapur, Vellore, Vijayawada, Vijayapura, Visakhapatnam, Yeshwantpur.</p>
<p>The Associated Auto Parts Pvt. Ltd. 445 Dr. Bhadkamkar Marg (Lamington Road), Mumbai 400 004. Tel. : +91-22-23822354, 23822355</p>	<p>Ahmedabad, Ahmednagar, Ambikapur, Aurangabad, Chimbl Phata (Pune), Gandhidham, Indore, Jabalpur, Jalgaon, Kolhapur, Navi Mumbai, Nasik, Nanded, Nagpur, Pune, Rajkot, Raipur, Surat, Sangli, Solapur, Vadodara.</p>
<p>TVS Mobility Pvt. Ltd 8th Floor, A8 & A9, Thiru. Vi. Ka Industrial Estate Guindy, Chennai - 600 032 Phone: 91-44-22508676</p>	<p>Bhopal, Cochin, Coimbatore, Dindigul, Jabalpur, Haldwani, Indore, Kanpur, Tirunelveli, Trichy, Pudukottai, Salem, Namakal, Nagercoil, Madurai, Pondichery, Pollachi, Erode, Dharmapuri, Tirupur, Jaipur, Jodhpur, Kozhikode, Thiruvananthapuram, Kollam, Kottayam, Thrissur, Kannur, Mallapuram, Villupuram, Varanasi</p>
<p>Lucas Indian Service Limited 28, Poomagal Main Road Behind Olympia Park, Ekkattuthangal, Guindy, Chennai- 600032 Tel: +91-44-22255032 Extn 611</p>	<p>Bhubaneswar, Guwahati, Kolkata, Patna, Ranchi, Siliguri.</p>
<p>CAPL Motor Parts Private Limited Plot No. 19, Survey No. 533/ 1A & 1B Maharaja Estate, Behind Anand Hotel Sarkhej J-Sanand Road, Sarkhej Ahmedabad - 382210</p>	<p>Ahmedabad</p>



INDEX

Sl.No.	Description	Page No.
1	Socket Products Technical Data Sheet	10
METRIC SERIES		
Grade 12.9, 10.9		
2	Socket Head Cap Screws - (M3-M12)	12
3	Socket Head Cap Screws - (M14-M24)	13
4	Socket Set Screws - Knurled Cup Point (M3-M12)	14
5	Socket Set Screws - Flat, Cone, Dog, Plain Cup Point (M4-M12)	15
6	Socket Countersunk Head Cap Screw - (M3-M20)	16
7	Socket Button Head Cap Screw - (M3-M10)	17
8	Low Head Socket Head Cap Screw - (M4-M16)	18
9	Socket Head Cap Screw / Bolts (M16-24 Above 200mm length) (M27-M36)	19
INCH SERIES		
10	Socket Head Cap Screws - BSW - (3/16" - 7/16")	20
11	Socket Head Cap Screws - BSW - (1/2" - 1")	21
12	Socket Head Cap Screws - BSF/UNF - (3/16" - 7/16")	22
13	Socket Head Cap Screws - BSF/UNF - (1/2" - 1")	23
14	Socket Head Cap Screws - UNC - (3/16" - 7/16")	24
15	Socket Head Cap Screws - UNC - (1/2" - 1")	25
16	Socket Set Screws - Knurled Cup Point - BSW	26
17	Socket Countersunk Head Cap Screw - BSW - (1/4" - 5/8")	27
18	Socket Countersunk Head Cap Screw - UNC - (1/4" - 5/8")	28
19	Socket Countersunk Head Cap Screw - BSF/UNF	29
SHB / SHS - Grade 8.8		
20	Socket Head Cap Screws - (M3-M12)	30
21	Socket Head Cap Screws - (M14-M24)	31
22	Socket Head Cap Screw / Bolts (M16-24 Above 200mm length) (M27-M36)	32
23	Socket Button Head Cap Screw - (M3-M10)	33
24	Socket Countersunk Head Cap Screw - (M3-M20)	34
25	Socket Low Head Cap Screws - (M4-M16)	35
SOCKET KEYS		
26	Socket Keys - Metric Series	36-37
27	Socket Keys T Handle Hex (long)	38
28	Socket Keys - Inch Series	39-40



Socket Products

Technical Data Sheet

Socket Countersunk Head Screws

BS Inch Series

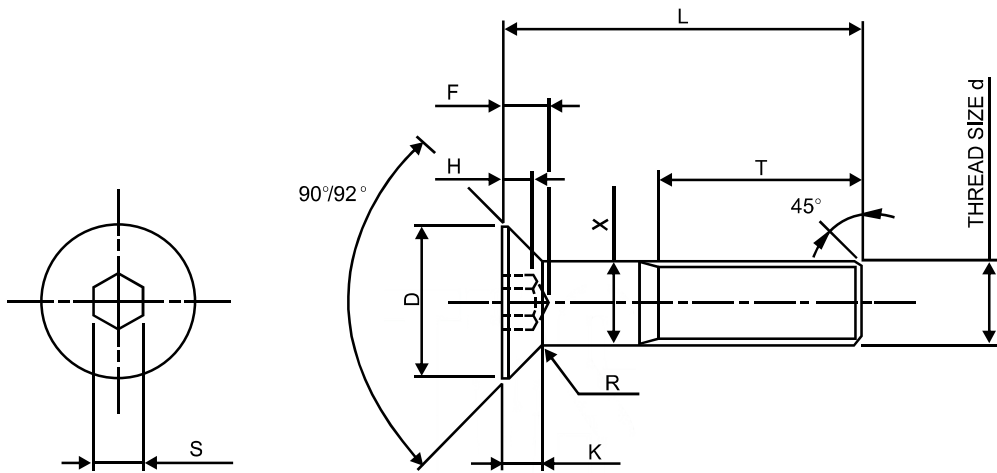

D-MAX THEORETICAL SHARP CORNERS

D-MAX THEORETICAL SHARP CORNERS

THREAD SIZE Ø	D	X	F	K	H	R	T	S
	Max	Max	Max	Ref	Min	Ref	Min	Nom
3/16	0.356	0.187	0.097	0.085	0.065	0.025	1.000	3/32
1/4	0.475	0.250	0.132	0.113	0.085	0.025	1.000	5/32
5/16	0.596	0.312	0.159	0.142	0.105	0.025	1.125	3/16
3/8	0.712	0.375	0.187	0.169	0.125	0.025	1.250	7/32
7/16	0.833	0.437	0.211	0.198	0.142	0.025	1.375	1/4
1/2	0.951	0.500	0.248	0.226	0.165	0.025	1.500	5/16
5/8	1.190	0.625	0.318	0.283	0.220	0.025	1.750	3/8

(All dimensions in inches)

- | | | |
|----|------------|-----------------------------|
| 1. | Material | : Special grade alloy steel |
| 2. | Hardness | : 36 to 45 HRc |
| 3. | Thread fit | : Medium Class as per BS:84 |



Suggested Hexagon Keys

METRIC SERIES

Sl.No	Diameter	SHCS	SHCB	CSK	BUTTON	SSS	LHCS
1	M3	2.5	2.5	2	2	1.5	
2	M4	3	3	2.5	2.5	2	2.5
3	M5	4	4	3	3	2.5	3
4	M6	5	5	4	4	3	4
5	M8	6	6	5	5	4	5
6	M10	8	8	6	6	5	7
7	M12	10	10	8	8	6	8
8	M14	12	12				10
9	M16	14	14	10	10		12
10	(M18)	14	14				12
11	M20	17	17	12			14
12	(M22)	17	17				
13	M24	19	19				
14	M27	19	19				
15	M30	22	22				
16	M33	24	24				
17	M36	27	27				

INCH SERIES

Sl.No	Diameter	SHCS	SHCB	CSK	SSS	
					BSF/BSW	UNF/UNC
1	3/16	5/32	5/32		3/32	
2	1/4	3/16	3/16	5/32	1/8	1/8
3	5/16	7/32	7/32	3/16	5/32	5/32
4	3/8	5/16	5/16	7/32	3/16	3/16
5	7/16	5/16	5/16			
6	1/2	3/8	3/8	5/16	1/4	1/4
7	5/8	1/2	1/2	5/16		
8	3/4	9/16	9/16			
9	7/8	9/16	9/16			
10	1	5/8	5/8			



Socket head Cap Screws

Metric Series M3 - M12

Recommended Retail Prices in Rupees Per 100 Pieces

Effective 1st November 2022



1. Specification : Generally conforming to IS:2269, DIN 912, ISO:4762
2. Threads : 12.9 Grade 5g6g as per ISO 261, ISO 965-2; ISO 965-3
3. Material : Special grade alloy steel
8.8 & 10.9 Low Carbon boron steel, Medium carbon boron steel, Special alloy steel
4. Mechanical Properties : 8.8, 10.9, 12.9 As per ISO 898-1
5. Note : Sizes in brackets are non-preferred standards. Shaded sizes are fully threaded.
6. Finish : Thermal/ Chemical Blackened with rust preventive oil (Black colour)

Diameter	M3	M4	M5	M6	M8	M10	M12
Length	Key	Key	Key	Key	Key	Key	Key
(mm)	2.5mm	3mm	4mm	5mm	6mm	8mm	10mm
5	1485	1300	-	-	-	-	
6	1280	1300	1510	1695	-	-	
8	950	980	1045	1170	1425	-	
10	795	775	595	675	1300	1480	
12	795	705	600	785	995	1480	
(14)	830	740	675	750	870	1370	
16	830	600	675	750	870	1370	4025
(18)	830	790	735	785	915	1255	3590
20	830	640	630	785	915	1255	3590
(22)	855	820	770	870	1020	1375	3125
25	855	660	770	870	1020	1375	3125
30	1005	960	890	985	1105	1515	3125
35		1055	980	1075	1205	1625	3205
40		1160	1055	*1165	1300	1735	3220
45		1320	1145	*1255	*1395	1875	3280
50		1635	1235	*1340	*1450	*1995	3350
55		2605	2100	*1450	*1590	*2160	*3540
60			2695	2670	*1710	*2325	*3740
65			5345	2760	1825	2505	*3935
70			6400	2865	1955	2695	*4145
75				3200	2060	2860	*4335
80				3635	3100	4415	*5185
85				3690	3575	5025	*5860
90				3690	3575	5025	*5860
95				4170	4250	5910	*6780
100				4170	4250	5910	*6780
105				4985	5295	6970	*8135
110				4985	5295	6970	8135
115				6535	6180	7055	9360
120				6535	6180	7055	9360
125				7895	7595	9705	11370
130				7895	7595	9705	11370
135				8500	8160	10850	12665
140				8500	8160	10850	12665
145					8815	12055	13975
150					8815	12055	13975
155							23020
160							23020
165							25320
170							25320
175							25320
180							25320
185							27400
190							27400
195							27400
200							27400



Socket head Cap Screws

Metric Series M14 - M24

Recommended Retail Prices in Rupees Per 100 Pieces

Effective 1st November 2022



1. Specification : Generally conforming to IS:2269, DIN 912, ISO:4762
2. Threads : 12.9 Grade 5g6g as per ISO 261, ISO 965-2; ISO 965-3
3. Material : Special grade alloy steel
8.8 & 10.9 Low Carbon boron steel, Medium carbon steel, Medium carbon boron steel, Special alloy steel
4. Mechanical Properties : 8.8, 10.9, 12.9 As per ISO 898-1
5. Note : Sizes in brackets are non-preferred standards. Shaded sizes are fully threaded.
6. Finish : Thermal/ Chemical Blackened with rust preventive oil (Black colour)

Diameter	M14	M16	M18	M20	M22	M24
Length	Key	Key	Key	Key	Key	Key
(mm)	12mm	14mm	14mm	17mm	17mm	19mm
5						
6						
8						
10						
12						
(14)						
16						
(18)						
20	8995	7905				
(22)	8110	7905				
25	8110	7905		19285		
30	8110	7905	21215	19285		
35	6825	6645	21490	19535		
40	6985	6810	18805	17110		20625
45	7105	6925	18940	17225		21155
50	7275	7075	19100	17360	22195	20265
55	7360	7185	19220	17470	24945	22790
60	7810	*7595	19365	17595	25650	23430
65	7915	*7710	19535	17755	28565	26085
70	8540	8320	20865	18960	27715	26570
75	9020	8800	22215	*20200	32430	28155
80	9460	9205	22650	*20595	32430	29600
85	9670	9410	23100	21005	34000	31045
90	9670	9410	23100	21005	34000	31045
95	11980	11680	24225	22025	35860	32740
100	11980	11680	24225	22025	35860	32740
105	13025	12685	26810	24360	38980	35605
110	13025	12685	26810	24360	38980	35605
115	14075	13710	29365	26715	42130	38480
120	14075	13710	29365	26715	42130	38480
125	16300	15870	31945	29045	55395	41355
130	16300	15870	31945	29045	55395	41355
135	17445	16990	34500	31365	64720	44215
140	17445	16990	34500	31365	64720	44215
145	18595	18100	37055	33695	86275	47105
150	18595	18100	37055	33695	86275	47105
155	20885	36020	45235	43185	123390	76460
160	21925	36020	45235	43185	123390	76460
165	0	40110	51670	49315	132000	81810
170	0	40110	51670	49315	132000	81810
175	0	40110	51670	49315	132000	81810
180	0	40110	51670	49315	132000	81810
185	0	44325	53870	51425	141305	87570
190	0	44325	53870	51425	141305	87570
195	0	44325	53870	51425	141305	87570
200	0	44325	53870	51425	141305	87570



Socket Set Screws

Metric Series M3 - M12

Knurled Cup Point

Recommended Retail Prices in Rupees Per 100 Pieces

Effective 1st November 2022



Diameter Length (mm)	M3	M4	M5	M6	M8	M10	M12
4	400						
5	405	405	285	510			
6	410	410	285	310	340		
8	415	415	285	340	340	390	
10	435	360	315	280	345	390	1025
12	470	470	325	360	360	430	740
16	485	485	330	390	405	485	805
20				410	430	525	840
25				495	495	625	955
30				675	700	900	1105
35					820	1035	1260
40							
45							
50							
55							
60							
65							
70							

- | | |
|--------------------------|---|
| 1. Specification | : Generally conforming to ISO 4029 (Without Knurling details) |
| 2. Threads | : 12.9 Grade 5g6g as per ISO 261, ISO 965-2; ISO 965-3 |
| 3. Material | : Special grade alloy steel |
| 4. Mechanical Properties | : Property class 45H as per ISO 898-5 |
| 5. Finish | : Thermal/ Chemical Blackened with rust preventive oil (Black colour) |



Socket Set Screws

Metric Series M4 - M12
Flat Point, Cone Point, Dog Point, Plain Cup Point
Recommended Retail Prices in Rupees Per 100 Pieces
Effective 1st November 2022

Diameter Length (mm)	M4	M5	M6	M8	M10	M12
5		405				
6	580	405	450			
8	595	410	475	475	545	
10	630	435	495	495	545	1045
12	660	465	510	515	605	1045
16	690	475	550	565	690	1135
20			585	615	745	1195
25			700	700	895	1370
30			945	1000	1285	1565
35				1165	1480	1805

1. Specification	: Generally conforming to IS:6094, ISO:4026, ISO 4027, ISO 4028, ISO 4029
2. Threads	: 5g6g as per ISO 261, ISO 965-2, ISO 965-3
3. Material	: Special grade alloy steel
4. Mechanical Properties	: Property class 45H; as per ISO 898-5

FLAT	CONE	DOG	PLAIN CUP
6094	6094	6094	6094
913	914	915	916

5. Finish	: Thermal/ Chemical Blackened with rust preventive oil (Black colour)
-----------	---



Socket Countersunk Head Cap Screws

Metric Series M3 - M20

Recommended Retail Prices in Rupees Per 100 Pieces

Effective 1st November 2022



Diameter	M3	M4	M5	M6	M8	M10	M12	M16	M20
Length (mm)	Key 2mm	Key 2.5mm	Key 3mm	Key 4mm	Key 5mm	Key 6mm	Key 8mm	Key 10mm	Key 17mm
6	1235								
8	1235	680	990	1280					
10	1320	680	555	825					
12	1420	575	575	670	1070				
16	1610	770	770	835	1070	1730			
20	1800	830	830	900	1140	1425			
25	1980	965	965	1045	1315	1640	2990		
30		1165	1165	1260	1495	1880	3410	5815	
35		2400	1545	1670	1705	2150	3835	6265	
40		2575	2400	1670	1950	2460	4265	6695	7175
45		2910	2730	2955	2955	2780	4680	7150	8410
50		3415	3415	3690	3395	3120	5105	7610	8410
55					4050	3540	5535	8030	8015
60					4540	3915	5965	8490	9650
65							6710	9335	10275
70							7225	9815	10890
75							7770	10295	12135
80							8365	10815	12135
85							8990	12260	13380
90							9685	12260	13380
95							10415	14825	16030
100							11210	14825	17175
110							13000	19695	20610
120							15005	23640	25190
130								26260	27480

- | | | | |
|----|-----------------------|---|---|
| 1. | Specification | : | Generally conforming to ISO 10642 |
| 2. | Threads | : | 12.9 Grade 5g6g as per ISO 261, ISO 965-2; ISO 965-3 |
| 3. | Material | : | Special grade alloy steel |
| 4. | Mechanical Properties | : | Property class 12.9 as per IS:1367-3, ISO 898-1 |
| 5. | Note | : | All sizes are fully threaded. |
| 6. | Finish | : | Thermal/ Chemical Blackened with rust preventive oil (Black colour) |



Socket Button Head Cap Screws

Metric Series M3 - M10

Recommended Retail Prices in Rupees Per 100 Piece

Effective 1st November 2022



Diameter	M3	M4	M5	M6	M8	M10
Length	Key	Key	Key	Key	Key	Key
(mm)	2mm	2.5mm	3mm	4mm	5mm	6mm
6	1095	705	1140			
8	1295	705	1090	1325		
10	1395	705	755	915	1460	
12	1495	755	785	735	1180	
16	1690	815	850	980	1000	1900
20	1870	865	905	1055	1260	1560
25	2055	1015	1055	1230	1445	1805
30		1220	1275	1410	1655	2060
35			1455	1605	1865	2355
40			1625	1835	2120	2705
45				2235	2450	3145
50					2700	3475
60					3845	

- | | | |
|----|-----------------------|---|
| 1. | Specification | : Generally conforming to ISO :7380-1 |
| 2. | Threads | : 5g6g as per ISO 261; ISO 965-2;ISO 965-3 |
| 3. | Material | : Special grade alloy steel |
| 4. | Mechanical Properties | : Property class 12.9 as per ISO 898-1 |
| 5. | Note | : All sizes are fully threaded. |
| 6. | Finish | : Thermal/ Chemical Blackened with rust preventive oil (Black colour) |



Lowhead Socket Headcap Screws

Metric Series M4 - M16

Recommended Retail Prices in Rupees Per 100 Piece

Effective 1st November 2022

Diameter Length (MM)	M4	M5	M6	M8	M10	M12	(M14)	(M16)
5								
6	1560							
8	1180	1205	1305					
10	935	835	880	1460				
12	845	845	880	1115				
(14)	890	775	835	980				
16	890	775	835	980	1535			
(18)	945	835	880	1015	1400			
20	945	835	880	1015	1400	3760		
(22)	980	895	980	1130	1540	3275		
25	980	895	980	1130	1540	3275	8510	
30		1030	1100	1245	1690	3275	8510	6545
35			1200	1350	1830	3345	7155	6965
40				1460	1955	3375	7320	6965
45						3435	7455	7040
50						3505	7620	7400

1. Specification : Generally conforming to DIN 7984
2. Material : 8.8 & 10.9 Grade Low Carbon boron Steel, Medium Carbon Steel.
Medium carbon Boron Steel, Special Alloy steel
3. Mechanical Properties : As per DIN EN ISO 898-1
4. Tensile Load requirement : 80% of the values specified in DIN EN ISO 898-1
5. Note : Sizes in brackets are non-preferred standards.
6. Plating Finish : Thermal/Chemical Blackend with rust preventive Oil(Black Colour)
7. Thread Fit : 6g for 8.8 as per ISO 261 ; ISO 965-2
8. Supply and Forging based on mutual discussion only.



Socket Headcap Screws/Bolts

Metric Series M16-M24 *(Above 200mm length)*

Metric Series M27-M42 Grade 12.9, 10.9

Recommended Retail Prices in Rupees Per 100 Piece
Effective 1st November 2022



Diameter	(M16)	(M20)	(M22)	(M24)	(M27)	M30	(M33)	M36	M42
Length	Key	Key	Key	Key	Key	Key	Key	Key	Key
(mm)	14mm	17mm	17mm	19mm	19mm	22mm	24mm	27mm	32mm
45						55190			
50						55190			
55						55190			
60						48360			
65						48360			
70					50275	48360			
(75)					50275	48360	72670		
80					50275	50275	75670	90420	
90					55190	55190	81950	98600	
100					59000	59000	85780	101340	
110					62565	62565	90420	107075	
120					66380	66380	98600	111445	
130					67025	71030	103245	115255	
140					73750	73750	109805	127270	249630
150					78400	78400	115255	131925	275640
160					123460	123460	153215	178065	327785
(170)					136560	136560	169600	198275	327785
180					136560	136560	169600	198275	347890
(190)					148575	148575	184345	214935	347890
200					148575	148575	184345	214935	376895
(210)	46360	54590	148295	90640	185170	184345	228580	265720	376895
220	46360	57785	155265	93710	185170	184345	228580	265720	472830
(230)	48415	71065	161435	97440	205095	198275	246330	273090	492855
240	48415	92420	167605	101155	205095	198275	246330	273090	492855
(250)	50455	102120	173760	103310	234390	212200	257525	292485	525690
260	50455	111795	179915	87315	223405	212200	257525	292485	525690
(270)	52495	122115	186070	107855	238400	226125	271725	311860	558545
280	52495	132425	192235	110930	238400	226125	271725	311860	558545
(290)	54550	137160	199100	115075	253420	240045	293020	331245	591405
300	54550	141885	205965	119235	253420	240045	293020	331245	591405

- | | | |
|--------------------------|---|--|
| 1. Specification | : | Generally conforming to IS:2269, ISO:4762, DIN 912 |
| 2. Threads | : | ISO Metric, 5g6g for 12.9; 6g 8.8 & 10.9 as per ISO 261, ISO 965-2, ISO 965-3 |
| 3. Material | : | 12.9 - Special grade alloy steel |
| | : | 8.8 & 10.9 Low Carbon boron steel, Medium carbon steel, Medium carbon boron steel, Special alloy steel |
| 4. Mechanical Properties | : | Property class as per ISO 898-1 |
| 5. Note | : | Sizes in brackets are non-preferred standards. |
| 6. Finish | : | 12.9 Grade - Thermal/ Chemical Blackened with rust preventive oil (Black colour) |



Socket Head Cap Screws

Inch Series BSW (3/16" - 7/16")

Recommended Retail Prices in Rupees Per 100 Piece
Effective 1st November 2022



	Screws		Bolts			
Diameter	3/16"	1/4"	1/4"	5/16"	3/8"	7/16"
Length	Key	Key	Key	Key	Key	Key
(mm)	5/32"	3/16"	3/16"	7/32"	5/16"	5/16"
3/8	910	825	875	1115		
1/2	910	825	875	1105	1785	
5/8	850	785	840	980	1785	
3/4	910	825	875	1015	1455	4310
7/8	970	870	925	1060	1615	4310
1	1000	920	980	1135	1615	3770
1-1/4	1105	1035	1100	1235	1775	3770
1-1/2	1265	1145	1215	1370	1970	3840
1-3/4	1515	1405	1490	1635	2345	4110
2		1405	1490	1635	2345	4110
2-1/4		2810	2980	1950	2800	4715
2-1/2		2810	2980	1950	2800	4715
2-3/4		3030	3210	2305	3355	5315
3		3250	3455	2305	3355	5315
3-1/4		3895	4125	4010	5135	7205
3-1/2		3895	4125	4010	5135	7205
4		4285	4545	4745	6035	8345
4-1/2				7415	8860	10470
5				9240	10965	12835
5-1/2				11420	13180	14630
6				11420	13550	14630
6-1/2						
7						
7-1/2						
8						
8-1/2						
9						
10						

1.	Specification	:	Generally conforming to BS:2470
2.	Threads	:	BS Fine, Medium fit as per BS:84, UNF ,Class 2A as per BS 1580
3.	Material	:	Special grade alloy steel
4.	Mechanical Properties	:	As per BS:2470
5.	Note	:	Shaded sizes are fully threaded.
6.	Finish	:	Thermal/ Chemical Blackened with rust preventive oil (Black colour)



Socket Head Cap Screws

Inch Series BSW (1/2" - 1")

Recommended Retail Prices in Rupees Per 100 Piece

Effective 1st November 2022



Diameter	1 / 2"	5 / 8"	3 / 4"	7 / 8"	1"
Length	Key	Key	Key	Key	Key
(mm)	3 / 8"	1 / 2"	9 / 16"	9 / 16"	5 / 8"
3/8					
1/2	4020				
5/8					
3/4	4020	9675			
7/8	4020	8250			
1	3500	8250	21570		
1-1/4	3500	7180	21570		
1-1/2	3575	7430	18990	28550	27250
1-3/4	3805	7910	19445	29625	28280
2	3805	7910	19445	29625	28280
2-1/4	4385	8580	19860	31945	30515
2-1/2	4385	8580	19860	31945	30515
2-3/4	4935	9430	22595	35980	34340
3	4935	9430	22595	35980	34340
3-1/4	6700	10085	23495	39680	37880
3-1/2	6700	10085	23495	39680	37880
4	7755	13050	24630	41855	39945
4-1/2	9730	13845	29880	49180	46950
5	11935	15665	32495	52850	50465
5-1/2	13155	19420	35090	56550	53970
6	13615	20250	37690	60225	57485
6-1/2		42610	49440	100945	96355
7		44855	50575	104910	99805
7-1/2		46680	51750	108310	103390
8		49575	52745	111940	106840
8-1/2			55610		109900
9			59740		116840
10					

- | | | | |
|----|-----------------------|---|---|
| 1. | Specification | : | Generally conforming to BS:2470 |
| 2. | Threads | : | BS Fine, Medium fit as per BS:84, UNF ,Class 2A as per BS 1580 |
| 3. | Material | : | Special grade alloy steel |
| 4. | Mechanical Properties | : | As per BS:2470 |
| 5. | Note | : | Shaded sizes are fully threaded. |
| 6. | Finish | : | Thermal/ Chemical Blackened with rust preventive oil (Black colour) |



Socket Head Cap Screws Inch Series BSF/UNF (3/16" - 7/16")

Recommended Retail Prices in Rupees Per 100 Piece
Effective 1st November 2022



	Screws		Bolts			
Diameter	3/16"	1/4"	1/4"	5/16"	3/8"	7/16"
Length	Key	Key	Key	Key	Key	Key
(mm)	5/32"	3/16"	3/16"	7/32"	5/16"	5/16"
3/8	1105	1015	1075	1375		
1/2	1105	1015	1075	1370	2195	
5/8	1030	965	1030	1200	2195	
3/4	1105	1015	1075	1250	1780	5295
7/8	1195	1060	1130	1290	1990	5295
1	1245	1130	1200	1390	1990	4630
1-1/4	1360	1270	1350	1515	2175	4630
1-1/2	1560	1405	1490	1685	2415	4720
1-3/4	1855	1745	1850	1990	2880	5035
2		1745	1850	1990	2880	5035
2-1/4		3445	3660	2380	3425	5805
2-1/2		3445	3660	2380	3425	5805
2-3/4		3710	3935	2845	4130	6545
3		3995	4235	2845	4130	6545
3-1/4		4790	5080	4925	6320	8865
3-1/2		4790	5080	4925	6320	8865
4		5260	5580	5830	7410	10245
4-1/2				9125	10900	12860
5				11350	13475	15780
5-1/2				12710	16195	17990
6				14040	16655	17990
6-1/2						
7						
7-1/2						
8						
8-1/2						
9						
10						

1.	Specification	:	Generally conforming to BS:2470
2.	Threads	:	BS Fine, Medium fit as per BS:84 UNF, class 2A as per BS: 1580
3.	Material	:	Special grade alloy steel
4.	Mechanical Properties	:	As per BS:2470
5.	Note	:	Shaded sizes are fully threaded.
6.	Finish	:	Thermal/ Chemical Blackened with rust preventive oil (Black colour)
7.	Pitch	:	for 3/16 Dia -Only BSW/BSF



Socket Head Cap Screws Inch Series BSF/UNF (1/2" - 1")

Recommended Retail Prices in Rupees Per 100 Piece

Effective 1st November 2022



Diameter	1 / 2"	5 / 8"	3 / 4"	7 / 8"	1"
Length	Key	Key	Key	Key	Key
(mm)	3 / 8"	1 / 2"	9 / 16"	9 / 16"	5 / 8"
3/8					
1/2					
5/8					
3/4	4930				
7/8	4930	10155			
1	4295	10155	25315		
1-1/4	4295	8830	25315		
1-1/2	4390	9140	22300	33515	32005
1-3/4	4700	9725	22825	34875	33210
2	4700	9725	22825	34875	33210
2-1/4	5395	10555	23315	37515	35825
2-1/2	5395	10555	23315	37515	35825
2-3/4	6080	11595	26535	42245	40320
3	6080	11595	26535	42245	40320
3-1/4	8240	12405	27580	46580	44465
3-1/2	8245	12405	27580	46580	44465
4	9535	16045	28920	49150	46905
4-1/2	11960	17025	35085	57765	55130
5	14695	19285	38155	62060	59245
5-1/2	16175	23890	41195	66390	63385
6	16735	24920	44255	70710	67505
6-1/2		52405	58065	118540	113150
7		52930	59385	123185	117195
7-1/2		55190	60765	127200	121405
8		57410	61930	131455	125470
8-1/2		60985	65300		129065
9			70150		137215
10					

- | | | | |
|----|-----------------------|---|---|
| 1. | Specification | : | Generally conforming to BS:2470 |
| 2. | Threads | : | BS Fine, Medium fit as per BS:84 UNF, class 2A as per BS: 1580 |
| 3. | Material | : | Special grade alloy steel |
| 4. | Mechanical Properties | : | As per BS:2470 |
| 5. | Note | : | Shaded sizes are fully threaded. |
| 6. | Finish | : | Thermal/ Chemical Blackened with rust preventive oil (Black colour) |



Socket Head Cap Screws Inch Series UNC (3/16" - 7/16")

Recommended Retail Prices in Rupees Per 100 Piece
Effective 1st November 2022



	Screws		Bolts			
Diameter	3/16"	1/4"	1/4"	5/16"	3/8"	7/16"
Length	Key	Key	Key	Key	Key	Key
(mm)	5/32"	3/16"	3/16"	7/32"	5/16"	5/16"
3/8	1095	995	1055	1350		
1/2	1095	995	1055	1340	2150	
5/8	1025	945	1000	1170	2150	
3/4	1095	995	1055	1215	1750	5205
7/8	1160	1050	1115	1275	1960	5205
1	1210	1100	1170	1370	1960	4545
1-1/4	1340	1245	1315	1490	2120	4545
1-1/2	1520	1385	1470	1655	2380	4635
1-3/4	1820	1710	1815	1960	2810	4945
2		1710	1815	1960	2810	4945
2-1/4		3385	3590	2345	3375	5690
2-1/2		3385	3590	2345	3375	5690
2-3/4		3660	3880	2775	4055	6415
3		3915	4145	2775	4055	6415
3-1/4		4695	4980	4825	6195	8710
3-1/2		4695	4980	4825	6195	8710
4		5150	5460	5725	7265	10055
4-1/2				8960	10695	12615
5				11150	13220	15495
5-1/2					15885	17650
6					16355	18125
6-1/2						
7						
7-1/2						
8						
8-1/2						
9						
10						

- | | | | |
|----|-----------------------|---|---|
| 1. | Specification | : | Generally conforming to BS:2470 |
| 2. | Threads | : | UNC 2A as per BS:1580 |
| 3. | Material | : | Special grade alloy steel |
| 4. | Mechanical Properties | : | As per BS:2470 |
| 5. | Note | : | Shaded sizes are fully threaded. |
| 6. | Finish | : | Thermal/ Chemical Blackened with rust preventive oil (Black colour) |



Socket Head Cap Screws

Inch Series UNC (1/2" - 1")

Recommended Retail Prices in Rupees Per 100 Piece
Effective 1st November 2022



Diameter	1 / 2"	5 / 8"	3 / 4"	7 / 8"	1"
Length	Key	Key	Key	Key	Key
(mm)	3 / 8"	1 / 2"	9 / 16"	9 / 16"	5 / 8"
3/8					
1/2					
5/8					
3/4	4840	11690			
7/8	4840	9965			
1	4220	9965	24845		
1-1/4	4220	8655	24845		
1-1/2	4305	8970	21890	32885	31405
1-3/4	4600	9540	22410	34145	32590
2	4600	9540	22410	34145	32590
2-1/4	5285	10360	22895	36810	35155
2-1/2	5285	10360	22895	36810	35155
2-3/4	5965	11375	26030	41455	39580
3	5965	11375	26030	41455	39580
3-1/4	8085	12175	27070	45705	43650
3-1/2	8085	12175	27070	45705	43650
4	9360	15760	28380	48240	46040
4-1/2	11725	16720	34405	56680	54090
5	14410	18925	37435	60905	58150
5-1/2	15865	23445	40420	65165	62200
6	16410	24440	43440	69390	66230
6-1/2		51425	56975	116320	111035
7		52930	58275	120885	104560
7-1/2		54155	59625	124830	119140
8		56345	60765	128990	123125
8-1/2		59845	64070	128990	126640
9			68845		134650

- | | | | |
|----|-----------------------|---|---|
| 1. | Specification | : | Generally conforming to BS:2470 |
| 2. | Threads | : | UNC 2A as per BS:1580 |
| 3. | Material | : | Special grade alloy steel |
| 4. | Mechanical Properties | : | As per BS:2470 |
| 5. | Note | : | Shaded sizes are fully threaded. |
| 6. | Finish | : | Thermal/ Chemical Blackened with rust preventive oil (Black colour) |



Socket Set Screws Inch Series BSW Knurled Cup Point

Recommended Retail Prices in Rupees Per 100 Piece
Effective 1st November 2022



Diameter	3/16"	1/4"	5/16"	3/8"	1/2"
Length	Key	Key	Key	Key	Key
(Inch)	3/32"	1/8"	5/32"	5/16"	1/4"
1/4	310	310			
5/16	310	340	340		
3/8	340	345	345	390	
1/2	350	360	360	430	740
5/8	360	390	405	485	805
3/4		410	430	525	840
1		495	525	625	955
1 1/4		675	700	900	1225
1 1/2					
1 3/4					
2					
2 1/2					
3					

1.	Specification	:	Generally conforming to BS:2470
2.	Threads	:	BS Fine, Medium fit as per BS:84, UNF ,Class 2A as per BS 1580
3.	Material	:	Special grade alloy steel
4.	Mechanical Properties	:	As per BS:2470
5.	Finish	:	Thermal/ Chemical Blackened with rust preventive oil (Black colour)
6.	Note	:	All sizes are fully threaded.
7.	Finish	:	BSW
		:	BSF/UNC/UNF On Enquiry



Socket Countersunk Head Cap Screws Inch Series BSW (1/4" - 5/8")

Recommended Retail Prices in Rupees Per 100 Piece

Effective 1st November 2022

Diameter	1/4"	5/16"	3/8"	1/2"	5/8"
Length	Key	Key	Key	Key	Key
(mm)	5/32"	3/16"	7/32"	5/16"	5/16"
3/8	825				
1/2	825	1195			
5/8	900	1195	1845		
3/4	965	1140	1670	3680	
7/8	1040	1235	1800	4090	
1	1125	1315	1940	4605	
1 - 1/4	1285	1495	2220	5105	
1 - 1/2		2000	2990	5710	
2			3345	6405	8135
2 1/2				7170	9385
3					10940

- | | | |
|---|---|--|
| 1. Specification | : | (Please refer to SFL technical data sheet. Page 7) |
| 2. Threads | : | BS Whitworth, Medium Fit as per BS:84 |
| 3. Material | : | Special grade alloy steel |
| 4. Mechanical Properties | : | Hardness 36-44 Hrc |
| 5. Note | : | All size are fully threaded |
| 6. Finish | : | Thermal/Chemical Blackend with rust preventive Oil(Black Colour) |
| These are not popular items. We will take up forging. after we get sufficient orders to meet out Economic batch run quantity. | | |



Socket Countersunk Head Cap Screws

Inch Series UNC (1/4" - 5/8")

Recommended Retail Prices in Rupees Per 100 Piece

Effective 1st November 2022

Diameter	1/4"	5/16"	3/8"	1/2"	5/8"
Length	Key	Key	Key	Key	Key
(mm)	5/32"	3/16"	7/32"	5/16"	5/16"
3/8	1360				
1/2	1360	1765			
5/8	1485	1765	2330		
3/4	1600	1895	2520	4495	
7/8	1710	2030	2680	5165	
1	1830	2095	3085	5615	
1 1/4	2100	2460	3230	6290	
1 1/2		2700	3705	6955	
2			4520	7645	8135
2 1/4				7915	8260
2 1/2				8415	9385
2 3/4				8815	9590
3				9250	10940

- | | | |
|--------------------------|---|---|
| 1. Specification | : | Generally conforming to BS:2470 |
| 2. Threads | : | UNC 2A as per BS: 1580 |
| 3. Material | : | Special grade alloy steel |
| 4. Mechanical Properties | : | Hardnesss 36 HRc Min |
| 5. Note | : | All sizes are fully threaded. |
| 6. Finish | : | Thermal/ Chemical Blackened with rust preventive oil (Black colour) |
- These are not popular items. We will take up forging after we get sufficient orders to meet our Economic batch run quantity.



Socket Countersunk Head Cap Screws

Inch Series BSF/UNF

Recommended Retail Prices in Rupees Per 100 Piece

Effective 1st November 2022

Diameter	1/4"	5/16"	3/8"	1/2"
Length	Key	Key	Key	Key
(mm)	5/32"	3/16"	7/32"	5/16"
3/8	1385			
1/2	1385	1800		
5/8	1520	1800	2380	
3/4	1630	1940	2575	4580
7/8	1745	2075	2715	5265
1	1865	2130	3145	5715
1 - 1/4	2140	2500	3290	6410
1 - 1/2		2970	3780	7095
2			4520	7795
2 - 1/2				8575
3				9430

1. Specification : BSF/UNF: Generally conforming to BS: 2470
2. Threads : BS Fine, Medium fit as per BS:84 UNF, class 2A as per BS: 1580
3. Material : Special grade alloy steel
4. Mechanical Properties : Hardness 36 HRc Min
5. Note : All sizes are fully threaded.
6. Finish : Thermal/ Chemical Blackened with rust preventive oil (Black colour)
These are not popular items. We will take up forging.
after we get sufficient orders to meet our Economic batch run quantity.



Socket head Cap Screws

Grade 8.8

Metric Series M3 - M12

Recommended Retail Prices in Rupees Per 100 Pieces

Effective 1st November 2022



1. Specification : Generally conforming to IS:2269, DIN 912, ISO:4762
 2. Threads : 8.8 Grade 6g as per ISO 261, ISO 965-2; ISO 965-3
 3. Material : 8.8 Low Carbon boron steel, Medium carbon steel, Medium carbon boron steel, Special alloy steel
 4. Mechanical Properties : 8.8 As per ISO 898-1
 5. Note : Sizes in brackets are non-preferred standards. Shaded sizes are fully threaded.
 6. Finish : Thermal/ Chemical Blackened with rust preventive oil (Black colour)

Diameter	M3	M4	M5	M6	M8	M10	M12
Length	Key	Key	Key	Key	Key	Key	Key
(mm)	2.5mm	3mm	4mm	5mm	6mm	8mm	10mm
5	1570	1380					
6	1355	1380	1600	1785			
8	1005	1035	1115	1230	1500		
10	840	825	630	705	1375		
12	840	750	635	830	1055	1565	
(14)	875	775	725	805	925	1445	
16	875	635	725	805	925	1445	4255
(18)	875	835	770	830	960	1325	3790
20	875	670	660	830	960	1325	3790
(22)	910	860	810	925	1075	1450	3310
25	910	700	810	925	1075	1450	3310
30	1070	1020	940	1040	1170	1590	3310
35		1115	1025	1130	1275	1720	3395
40		1220	1120	*1225	1375	1835	3410
45		1395	1210	*1325	*1470	1980	3470
50		1730	1310	*1420	*1540	*2110	3550
55		2755	2225	*1540	*1690	*2275	*3745
60			2850	2815	*1815	*2455	*3955
65			5645	2925	1920	2660	*4165
70			6770	3035	2060	2850	*4385
75				3380	2180	3030	*4575
80				3635	3280	4670	*5485
85				3910	3785	5320	*6200
90				3910	3785	5320	*6200
95				4405	4490	6245	*7180
100				4405	4490	6245	*7180
105				5275	5605	7380	*8605
110				5275	5605	7380	8605
115				6915	6535	7465	9910
120				6535	6535	7465	9910
125				8350	8035	10270	12035
130				8350	8035	10270	12035
135				9435	8625	11480	13395
140				9435	8625	11480	13395
145					9320	12750	14785
150					9320	12750	14785
155							24345
160							24345
165							26785
170							26785
175							26785
180							26785
185							28970
190							28970
195							28970
200							28970



Socket head Cap Screws

Grade 8.8

Metric Series M14 - M24

Recommended Retail Prices in Rupees Per 100 Pieces

Effective 1st November 2022



- 1. Specification : Generally conforming to IS:2269, DIN 912, ISO:4762
- 2. Threads : 8.8 Grade 6g as per ISO 261, ISO 965-2; ISO 965-3
- 3. Material : 8.8 Low Carbon boron steel, Medium carbon steel, Medium carbon boron steel, Special alloy steel
- 4. Mechanical Properties : 8.8 As per ISO 898-1
- 5. Note : Sizes in brackets are non-preferred standards. Shaded sizes are fully threaded.
- 6. Finish : 8.8 Grade with Zinc Phosphate & oil, Zinc Plate with Trivalent White/ Iridescent passivation prices will be against enquiry

Diameter	M14	M16	M18	M20	M22	M24
Length	Key	Key	Key	Key	Key	Key
(mm)	12mm	14mm	14mm	17mm	17mm	19mm
5						
6						
8						
10						
12						
(14)						
16						
(18)						
20	9515	8355				
(22)	8580	8355				
25	8580	8355		20390		
30	8580	8355	22435	20390		
35	7215	7030	22725	20655		
40	7395	7200	19895	18090		21815
45	7525	7325	20030	18225		22370
50	7695	7480	20200	18360	23465	21430
55	7785	7585	20325	18480	26380	24095
60	8255	*8035	20475	18600	27130	24780
65	8365	*8155	20655	18780	30210	27585
70	9035	8795	22065	20060	29310	28100
75	9540	9305	23490	*21360	34300	29765
80	10000	9735	23950	*21785	34300	31310
85	10220	9945	24435	22215	35960	32835
90	10220	9945	24435	22215	35960	32835
95	12680	12345	25630	23295	37935	34625
100	12680	12345	25630	23295	37935	34625
105	13775	13415	28355	25775	41230	37660
110	13775	13415	28355	25775	41230	37660
115	14880	14495	31055	28245	44560	40700
120	14880	14495	31055	28245	44560	40700
125	17235	16790	33790	30720	58585	43740
130	17235	16790	33790	30720	58585	43740
135	18445	17970	36490	33175	68450	46765
140	18445	17970	36490	33175	68450	46765
145	19670	19150	39195	35635	91255	49820
150	19670	19150	39195	35635	91255	49820
155	22095	38095	47840	45680	130500	80870
160	23180	38095	47840	45680	130500	80870
165		42420	54650	52155	139620	86530
170		42420	54650	52155	139620	86530
175		42420	54650	52155	139620	86530
180		42420	54650	52155	139620	86530
185		46880	56985	54380	149455	92620
190		46880	56985	54380	149455	92620
195		46880	56985	54380	149455	92620
200		46880	56985	54380	149455	92620



Socket Headcap Screws/Bolts

Metric Series M16-M24 (*Above 200mm length*)

Metric Series M27-M36

Grade 8.8

Recommended Retail Prices in Rupees Per 100 Piece

Effective 1st November 2022



Diameter	(M16)	(M20)	(M22)	(M24)	(M27)	M30	(M33)	M36
Length	Key	Key	Key	Key	Key	Key	Key	Key
(mm)	14mm	17mm	17mm	19mm	19mm	22mm	24mm	27mm
45						58370		
50						58370		
55						58370		
60						51155		
65						51155		
70					53175	51155		
(75)					53175	51155	76860	
80					53175	53175	80030	95630
90					58370	58370	86680	104290
100					62415	62415	90725	107185
110					66175	66175	95630	113240
120					70210	70210	104290	117875
130					70885	75120	109210	121910
140					78015	78015	116135	134610
150					82920	82920	121910	139540
160					130580	130580	162050	188340
(170)					144440	144440	179385	209715
180					144440	144440	179385	209715
(190)					157140	157140	194985	227335
200					157140	157140	194985	227335
(210)	49040	57740	156840	95875	195850	194985	241765	281050
220	49040	61105	164230	99120	195850	194985	241765	281050
(230)	51200	75155	170745	103060	216925	209715	260545	288840
240	51200	97750	177265	106985	216925	209715	260545	288840
(250)	53360	108000	183775	109265	247915	224445	272380	309360
260	53360	118240	190300	92345	236290	224445	272380	309360
(270)	55535	129165	196805	114080	252170	239175	287400	329860
280	55535	140065	203325	117330	252170	239175	287400	329860
(290)	57695	145075	210585	121705	268050	253895	309930	350360
300	57695	150075	217850	126110	268050	253895	309930	350360

- | | | |
|--------------------------|---|--|
| 1. Specification | : | Generally conforming to IS:2269, ISO:4762, DIN 912 |
| 2. Threads | : | ISO Metric, 5g6g for 12.9; 6g 8.8 & 10.9 as per ISO 261, ISO 965-2, ISO 965-3 |
| 3. Material | : | 8.8 & 10.9 Low Carbon boron steel, Medium carbon steel, Medium carbon boron steel, Special alloy steel |
| | | Property class as per ISO 898-1 |
| 4. Mechanical Properties | : | Sizes in brackets are non-preferred standards. |
| 5. Note | : | 12.9 Grade - Thermal/ Chemical Blackened with rust preventive oil (Black colour) |
| 6. Finish | : | 8.8 & 10.9 Grades - Zinc Phosphate & oil/ Zinc White Trivalent / Zinc Iridescent |
| | | Trivalent Passivation prices will be enquiry |



Socket Button Head Cap Screws

Grade 8.8

Metric Series M3 - M10

Recommended Retail Prices in Rupees Per 100 Piece

Effective 1st November 2022



Diameter	M3	M4	M5	M6	M8	M10
Length	Key	Key	Key	Key	Key	Key
(mm)	2mm	2.5mm	3mm	4mm	5mm	6mm
6	1160	750	1205			
8	1375	750	1145	1405		
10	1475	750	795	960	1550	
12	1580	795	830	780	1245	
16	1780	855	895	1035	1060	2000
20	1980	920	955	1110	1335	1655
25	2170	1075	1120	1300	1530	1905
30		1290	1345	1485	1740	2180
35			1540	1700	1975	2495
40			1720	1930	2250	2860
45				2360	2595	3325
50					2855	3675

- | | | |
|----|--------------------------|---|
| 1. | Specification | : Generally conforming to ISO :7380-1 |
| 2. | Threads | : 5g6g as per ISO 261; ISO 965-2;ISO 965-3 |
| 3. | Material | : Special grade alloy steel |
| 4. | Mechanical Properties | : Property class 8.8 as per ISO 898-1 |
| 5. | Tensile Load Requirement | : 80% of the values specified in ISO 898-1 |
| 6. | Note | : All sizes are fully threaded. |
| 7. | Finish | : Thermal/ Chemical Blackened with rust preventive oil (Black colour) |



Socket Countersunk Head Cap Screws

Metric Series M3 - M20

Grade 8.8

Recommended Retail Prices in Rupees Per 100 Pieces

Effective 1st November 2022



Diameter	M3	M4	M5	M6	M8	M10	M12	M16	M20
Length (mm)	Key	Key	Key	Key	Key	Key	Key	Key	Key
	2mm	2.5mm	3mm	4mm	5mm	6mm	8mm	10mm	17mm
6	1305								
8	1305	720	1045	1355					
10	1395	720	590	870					
12	1500	680	605	700	1130				
16	1700	820	820	880	1130	1830			
20	1895	875	875	945	1205	1500			
25	2095	1025	1025	1105	1390	1740	3165		
30		1225	1225	1320	1585	1985	3605	6150	
35		2535	1635	1755	1805	2275	4055	6625	
40		2720	2535	1765	2050	2605	4500	7085	7535
45		3075	2890	3125	2305	2945	4960	7560	8830
50		3610	3610	3905	3590	3305	5400	8035	8830
55					4285	3745	5855	8500	8420
60						4140	6310	8980	10135
65							7110	9885	10795
70							7640	10385	11430
75							8225	10895	12750
80							8850	11440	12750
85							9510	12965	14055
90							10245	12965	14055
95							11015	15680	16835
100							11860	15680	18035
110									21640
120									26450
130									28855

- | | | | |
|----|-----------------------|---|--|
| 1. | Specification | : | Generally conforming to IS:2269, DIN 912, ISO:4762 |
| 2. | Threads | : | ISO Metric, 6g as per IS:4218 |
| 3. | Material | : | Low & Medium Carbon Boron steel |
| 4. | Mechanical Properties | : | Property class 8.8 as per IS:1367 |
| 5. | Note | : | Sizes in brackets are non-preferred standards. |
| 6. | Finish | : | Blackened and coated with rust preventive oil |



Low Head Socket Head Cap Screws

Metric Series M4 - M16

Grade 8.8

Recommended Retail Prices in Rupees Per 100 Pieces

Effective 1st November 2022

Diameter	M4	M5	M6	M8	M10	M12	M14	M16
5								
6	1640							
8	1245	1270	1375					
10	985	875	925	1535				
12	890	890	925	1175				
(14)	935	820	880	1030				
16	935	820	880	1030	1615			
(18)	995	875	925	1060	1475			
20	995	875	925	1060	1475	3950		
(22)	1030	940	1030	1190	1620	3435		
25	1030	940	1030	1190	1620	3435	8940	
30		1085	1160	1305	1775	3435	8940	6870
35			1265	1420	1920	3520	7525	7315
40				1535	2050	3545	7685	7315
45						3610	7830	7395
50						3685	8000	7770

- | | | | |
|----|-----------------------|---|--|
| 1. | Specification | : | Generally conforming to IS:2269, DIN 912, ISO:4762 |
| 2. | Threads | : | ISO Metric, 6g as per IS:4218 |
| 3. | Material | : | Low & Medium Carbon Boron steel |
| 4. | Mechanical Properties | : | Property class 8.8 as per IS:1367 |
| 5. | Note | : | Sizes in brackets are non-preferred standards. |
| 6. | Finish | : | Blackened and coated with rust preventive oil |



SOCKET KEYS - Metric Series

Recommended Retail Prices in Rupees Per 100 Piece

Effective 1st November 2022



Sl.No.	Part No.	Size	Description	Qty. per box	Piece per 100 nos. Rs. P.
1	070000150	1.5 mm	Hex Socket Key	100	1425
2	070000200	2.0 mm	Hex Socket Key	100	1425
3	070000250	2.5 mm	Hex Socket Key	100	1135
4	070000300	3.0 mm	Hex Socket Key	100	1135
5	070000400	4.0 mm	Hex Socket Key	100	2245
6	070000500	5.0 mm	Hex Socket Key	100	2900
7	070000600	6.0 mm	Hex Socket Key	50	3850
8	070000700	7.0 mm	Hex Socket Key	50	11525
9	070000800	8.0 mm	Hex Socket Key	25	7050
10	070000900	9.0 mm	Hex Socket Key	25	18010
11	070001000	10.0 mm	Hex Socket Key	25	11525
12	070001200	12.0 mm	Hex Socket Key	10	18010
13	070001400	14.0 mm	Hex Socket Key	10	25675
14	070001700	17.0 mm	Hex Socket Key	10	43695
15	070001900	19.0 mm	Hex Socket Key	10	60295



SOCKET KEYS - Metric Series

Recommended Retail Prices in Rupees Per 100 Piece

Effective 1st November 2022

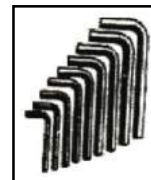

Sl.No.	Part No.	Size	Description	Qty. per box	Piece per 100 nos. Rs. P.
16	070002200	22.0 mm	Hex Socket Key	5	105380
17	070002400	24.0 mm	Hex Socket Key	5	136205
18	070002700	27.0 mm	Hex Socket Key	5	238230
19	070003200	32.0 mm	Hex Socket Key	4	418955
20	070003600	36.0 mm	Hex Socket Key	4	636755
21	071000150	1.5 mm	Hex Socket Key (Long)	25	2420
22	071000200	2.0 mm	Hex Socket Key (Long)	25	2725
23	071000250	2.5 mm	Hex Socket Key (Long)	25	2725
24	071000300	3.0 mm	Hex Socket Key (Long)	25	2725
25	071000400	4.0 mm	Hex Socket Key (Long)	10	4220
26	071000500	5.0 mm	Hex Socket Key (Long)	10	5235
27	071000600	6.0 mm	Hex Socket Key (Long)	5	6565
28	071000800	8.0 mm	Hex Socket Key (Long)	5	9095
29	071001000	10.0 mm	Hex Socket Key (Long)	5	17320
30	078000000		Hex Socket Key (Metric - Norm) Set	10	35985



SOCKET KEYS - T Handle Hex

Recommended Retail Prices in Rupees Per 100 Piece

Effective 1st November 2022



Sl.No.	Part No.	Size	Description	Qty. per box	Piece per 100 nos. Rs. P.
1	072000150	1.5 mm	T Handle Hex Socket Key (Long)	25	4825
2	072000200	2.0 mm	T Handle Hex Socket Key (Long)	25	5420
3	072000250	2.5 mm	T Handle Hex Socket Key (Long)	25	5420
4	072000300	3.0 mm	T Handle Hex Socket Key (Long)	25	5420
5	072000400	4.0 mm	T Handle Hex Socket Key (Long)	10	6320
6	072000500	5.0 mm	T Handle Hex Socket Key (Long)	10	7330
7	072000600	6.0 mm	T Handle Hex Socket Key (Long)	10	9855
8	072000800	8.0 mm	T Handle Hex Socket Key (Long)	10	13295
9	074000150	1.5 mm	T Handle Hex Socket Key (Short)	25	3635
10	074000200	2.0 mm	T Handle Hex Socket Key (Short)	25	3635
11	074000250	2.5 mm	T Handle Hex Socket Key (Short)	25	3635
12	074000300	3.0 mm	T Handle Hex Socket Key (Short)	25	3635
13	074000400	4.0 mm	T Handle Hex Socket Key (Short)	25	4220
14	074000500	5.0 mm	T Handle Hex Socket Key (Short)	25	4925
15	074000600	6.0 mm	T Handle Hex Socket Key (Short)	10	6855
16	074000800	8.0 mm	T Handle Hex Socket Key (Short)	10	10305



SOCKET KEYS - Inch Series

Recommended Retail Prices in Rupees Per 100 Piece

Effective 1st November 2022

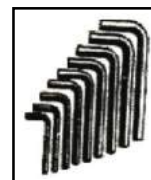

Sl.No.	Part No.	Size	Description	Qty. per box	Piece per 100 nos. Rs. P.
1	080000400	1/16 inch	Hex Socket Key	100	1470
2	080000500	5/64 inch	Hex Socket Key	100	1470
3	080000600	3/32 inch	Hex Socket Key	100	1470
4	080000800	1/8 inch	Hex Socket Key	100	1470
5	080000900	9/64 inch	Hex Socket Key	100	2610
6	080001000	5/32 inch	Hex Socket Key	100	1745
7	080001200	3/16 inch	Hex Socket Key	100	2240
8	080001400	7/32 inch	Hex Socket Key	50	3170
9	080001600	1/4 inch	Hex Socket Key	50	4430
10	080002000	5/16 inch	Hex Socket Key	25	7270
11	080002400	3/8 inch	Hex Socket Key	25	11355
12	080003200	1/2 inch	Hex Socket Key	10	21655
13	080003600	9/16 inch	Hex Socket Key	10	27810
14	080004000	5/8 inch	Hex Socket Key	10	38690
15	081000400	1/16 inch	Hex Socket Key (Long)	25	2420
16	081000500	5/64 inch	Hex Socket Key (Long)	25	2420
17	081000600	3/32 inch	Hex Socket Key (Long)	25	2420
18	081000800	1/8 inch	Hex Socket Key (Long)	25	2420
19	081001000	5/32 inch	Hex Socket Key (Long)	10	2725
20	081001200	3/16 inch	Hex Socket Key (Long)	10	3530
21	081001400	7/32 inch	Hex Socket Key (Long)	10	4530
22	081001600	1/4 inch	Hex Socket Key (Long)	5	6440



SOCKET KEYS - Inch Series

Recommended Retail Prices in Rupees Per 100 Piece

Effective 1st November 2022



Sl.No.	Part No.	Size	Description	Qty. per box	Piece per 100 nos. Rs. P.
23	082000400	1/16 inch	T Handle Hex Socket Key (Long)	25	4825
24	082000500	5/64 inch	T Handle Hex Socket Key (Long)	25	5420
25	082000600	3/32 inch	T Handle Hex Socket Key (Long)	25	5420
26	082000800	1/8 inch	T Handle Hex Socket Key (Long)	25	5420
27	082001000	5/32 inch	T Handle Hex Socket Key (Long)	10	6025
28	082001200	3/16 inch	T Handle Hex Socket Key (Long)	10	6525
29	082001400	7/32 inch	T Handle Hex Socket Key (Long)	10	7515
30	082001600	1/4 inch	T Handle Hex Socket Key (Long)	10	10030
31	084000400	1/16 inch	T Handle Hex Socket Key (Short)	25	3635
32	084000500	5/64 inch	T Handle Hex Socket Key (Short)	25	3635
33	084000600	3/32 inch	T Handle Hex Socket Key (Short)	25	3635
34	084000800	1/8 inch	T Handle Hex Socket Key (Short)	25	3635
35	084001000	5/32 inch	T Handle Hex Socket Key (Short)	25	3935
36	084001200	3/16 inch	T Handle Hex Socket Key (Short)	25	4430
37	084001400	7/32 inch	T Handle Hex Socket Key (Short)	10	5130
38	084001600	1/4 inch	T Handle Hex Socket Key (Short)	10	6740
39	084002000	5/16 inch	T Handle Hex Socket Key (Short)	10	9415
40	088000000		Hex Socket Key (Inch-Norm) Set	10	38705

Specification :

Inch Series : Generally conforming to BS:2470

Material : High grade alloy steel

Mechanical Properties :

Hardness : 50 HRc (3/8" & BELOW SIZE)

Hardness : 45 Hrc (Above 3/8"SIZE)

Finish : Blackened & Coated with rust preventive oil

Note :

- Size stamped in plastic 'T' handle for easy identification
- Metric keys will have red plastic handle
- Inch key will have blue plastic handle

Metric Series : IS 3082: ISO 2936: DIN 911

Material : Special grade alloy steel

Mechanical Properties :

Hardness : 50 HRc (1.5mm to 8mm)

: 48 HRc (9mm to 14mm)

: 45 HRc (15mm to 36mm)

Finish : Blackened & Coated with rust preventive oil



Chennai HO

C.Rajagopalan, Chennai
Executive Vice President - Marketing
9840670546 / (044)26258460 Ext.491
rajagopalan.c@sfl.co.in

R.Vasudevan, Chennai
9840706124 / (044)26258460 Ext.435
vasudevan.r2@sfl.co.in

S.Ramachandran, Chennai
Wind Energy
9500057461
ramachandran.s@sfl.co.in

K.R.Raaghav, Chennai
Wind Energy
735855285
raaghav.kr@sfl.co.in

Raja Vyshnavi, Chennai
Wind Energy
938408073
raja.vyshnavi@sfl.co.in

V.Sadagopan, Chennai
9790900117 / (044)26258460 Ext.614
sadagopan.v@sfl.co.in

S.Ganesan, Chennai
9677063522 / (044)26258460 Ext.571
ganesan.s@sfl.co.in

G.Karthik Raja, Chennai
7550022002 / (044)26258460 Ext.408
karthikraja.g@sfl.co.in

K.Viruthika, Chennai
7550079001/(044)26258460 Ext.613
viruthika.k@sfl.co.in

North Zone:

Sanjay Sachdev, Delhi
9384016498
sanjay.sachdev@sfl.co.in

Vikas Malhotra, Delhi
9871794185
vikas.malhotra@sfl.co.in

Sandeep, Delhi
9268503824
sandeep@sfl.co.in

Navin Krishna, Kanpur
9935521232
navin.krishna@sfl.co.in

Manu Kumar Sharma, Varanasi
9384020766
manukumar.sharma@sfl.co.in

Amit Kumar Roushan, Jaipur
9677113353
amitkumar.roushan@sfl.co.in

Vineet Purohit, Jalandhar
9384020771
vineet.purohit@sfl.co.in

East Zone

Debasish Paik, Kolkata
9831000184
paik.d@sfl.co.in

Dibyendu Sen, Kolkata
9831958896
sen.d@sfl.co.in

Sumit Lahiri, Kolkata
9401726521
sumit.lahiri@sfl.co.in

Akshaya Kumar Ray, Cuttack
9677114845
akshayakumar.ray@sfl.co.in

Piyush Kamal Upadhyay, Patna
9162988453
piyush.kamal@sfl.co.in

Rajat Dey, Guwahati
9864023336
rajat.dey@sfl.co.in

West Zone:

Harish Manchanda, Pune
9384020765
harish.manchanda@sfl.co.in

Rajeev Suhane, Pune
9384020768
rajeev.suhane@sfl.co.in

Sharad Jain, Jabalpur/Chattisgarh
9384020770
sharad.jain@sfl.co.in

D.Murugan, Nasik
9552574432
murugan.d@sfl.co.in

Pranshu Arora, Vadodara
9384020767
pranshu.arora@sfl.co.in

Sangram K.Save, Mumbai
9384020762
sangram.save@sfl.co.in

Kaushal Shah, Ahmedabad
9150938887
kaushal.shah@sfl.co.in

South Zone:

G.Kumaran, Bengaluru
9886423351
kumaran.g@sfl.co.in

Syed Vazeeruddin, Vijayawada
9384016499
syed.vazeeruddin@sfl.co.in

S.Selva Kumar, Chennai
7338854264/(044)26258460 Ext.615
selvakumar.s2@sfl.co.in

Elias Mathew, Ernakulam
9061061401
elias.mathew@sfl.co.in

Registered Office

98A, 7th Floor, Dr.Radhakrishnan Salai,
Mylapore, Chennai – 600 004, India.
Tel: +91-44-2847 8500
Fax: +91-44-2847 8508

Marketing Office

Padi,
Chennai – 600 050, India.
Tel : +91-44-26258460
Fax : +91-44-26257493

Factories

Padi,
Chennai – 600 050, India.
Tel : +91-44-26258460
Fax : +91-44-26257493

Korkadu, Villianur (Via)
Pondicherry – 605 110, India.
Tel :+91 -413-2666440
Fax :+91-413-2666441

Krishnapuram,
Aviyur – 626 160, India.
Tel :+91-4566-255466 / 7
Fax : +91-4566-255448

Uttarkhand
Plot No.60 Sector 11,
Integrated Industrial Estate,
Pantnagar, Rudrapur 263153.
Tel: +91-5944-250177

WEF & Infra Unit
135/3, 136/1 - Mandagapattu Road,
Mitta Mandagapattu Village,
Villupuram Dist. - 605 106, Tamilnadu.
Tel: +91-413-2697691 / 92
Fax:+91-413-2665441