

# CABLE ACCESSORIES

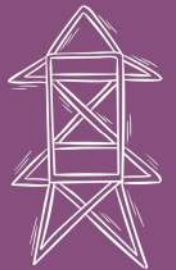

2018 - 2019  
[www.jigoindia.com](http://www.jigoindia.com)

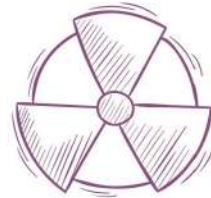

# JiGO

POWER TO PERFORM

# NYLON CABLE TIES

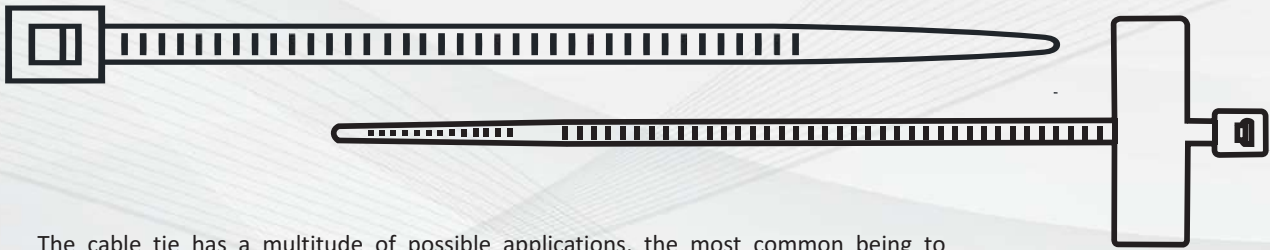

The cable tie has a multitude of possible applications, the most common being to organize cables. Computer cabling, electrical wires, home theater equipment, speaker wires, and power cables can be aesthetically improved and organized with the simple application of a cable tie. Cable ties are an extremely practical, affordable and convenient way to hold a lot of items that we use everyday together.

## SPECIFICATION

Material: Nylon 66, 94V-2 certified by UL. Heat-resisting, Acid & erosion control, insulate well and not apt to age.

Operating temperature: -35°C to 85°C

Color: Natural (or white, standard color), UV black and other colors are available as requested.



Model	Specification
JG - 100X2.5	Cable Tie of Length 100mm & Width 1.9mm
JG - 100X3	Cable Tie of Length 100mm & Width 2.5mm
JG - 150X2.5	Cable Tie of Length 150mm & Width 2.5mm
JG - 150X4	Cable Tie of Length 150mm & Width 3.2mm
JG - 200X3	Cable Tie of Length 200mm & Width 2.5mm
JG - 200X4	Cable Tie of Length 200mm & Width 3.5mm
JG - 250X4	Cable Tie of Length 250mm & Width 3.5mm
JG - 250X5	Cable Tie of Length 250mm & Width 5mm
JG - 300X4	Cable Tie of Length 300mm & Width 3.5mm
JG - 300X5	Cable Tie of Length 300mm & Width 5mm
JG - 300X7.6	Cable Tie of Length 300mm & Width 7.6mm
JG - 350X5	Cable Tie of Length 350mm & Width 5mm
JG - 400X5	Cable Tie of Length 400mm & Width 5mm
JG - 450X5	Cable Tie of Length 450mm & Width 5mm
JG - 450X8	Cable Tie of Length 450mm & Width 8mm
JG - 500X5	Cable Tie of Length 500mm & Width 5mm
JG - 500X8	Cable Tie of Length 500mm & Width 8mm
JG - 550X9	Cable Tie of Length 550mm & Width 9mm
JG - 650X9	Cable Tie of Length 650mm & Width 9mm
JG - 760X9	Cable Tie of Length 760mm & Width 9mm
JG - 920X9	Cable Tie of Length 920mm & Width 9mm
JG - 1020X9	Cable Tie of Length 1020mm & Width 9mm
JG - 100M	100 MM Marker Tie
JG - 200M	200 MM Marker Tie



# STAINLESS STEEL CABLE TIES

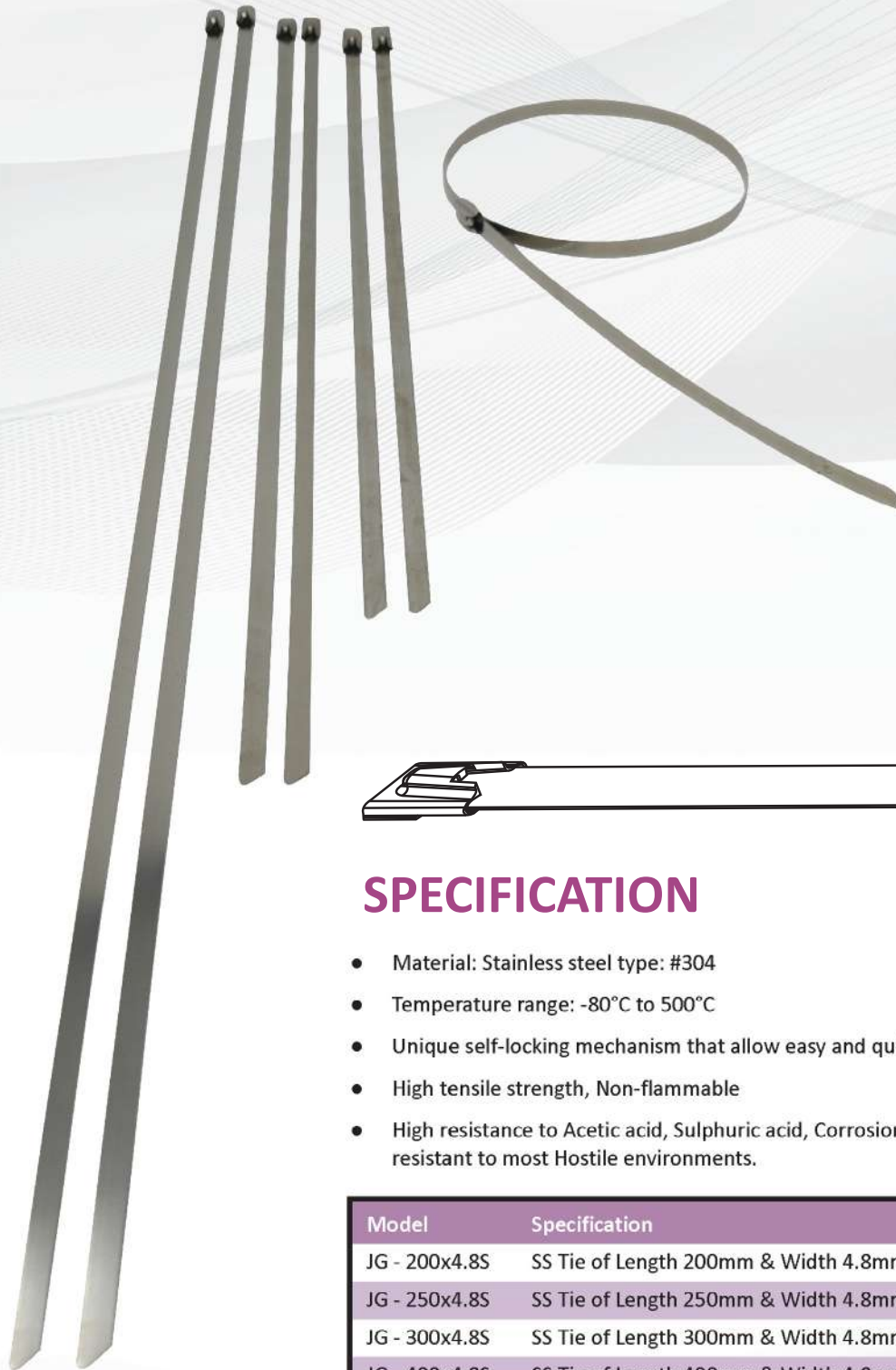

## SPECIFICATION

- Material: Stainless steel type: #304
- Temperature range: -80°C to 500°C
- Unique self-locking mechanism that allow easy and quick application.
- High tensile strength, Non-flammable
- High resistance to Acetic acid, Sulphuric acid, Corrosion, etc. General extremely resistant to most Hostile environments.

Model	Specification
JG - 200x4.8S	SS Tie of Length 200mm & Width 4.8mm
JG - 250x4.8S	SS Tie of Length 250mm & Width 4.8mm
JG - 300x4.8S	SS Tie of Length 300mm & Width 4.8mm
JG - 400x4.8S	SS Tie of Length 400mm & Width 4.8mm



# CABLE NAIL CLIP

**Plastic PE Material:** The color is white, protects your Cable Clips against non-toxic, impact and chemical resistance, moisture – proof. High Carbon Steel Nails: Sturdy and durable, shock resistance, not easy to bend, Anti oxidation, no rust, sharp nails and easily nail into the wall.

**Nail-in Fastener:** Fastening network cable, not easy to shake. (Each cable clip comes with integrated nails for mounting onto walls and various surfaces) **Wide Compatibility:** Use for indoor household, office electric wires, telephone lines, Network cables and computer cables.

Model	Specification
JG - 4MM	Plastic Circular Nail Clip of Diameter 4mm
JG - 5MM	Plastic Circular Nail Clip of Diameter 5mm
JG - 6MM	Plastic Circular Nail Clip of Diameter 6mm
JG - 7MM	Plastic Circular Nail Clip of Diameter 7mm
JG - 8MM	Plastic Circular Nail Clip of Diameter 8mm
JG - 9MM	Plastic Circular Nail Clip of Diameter 9mm
JG - 10MM	Plastic Circular Nail Clip of Diameter 10mm
JG - 12MM	Plastic Circular Nail Clip of Diameter 12mm
JG - 14MM	Plastic Circular Nail Clip of Diameter 14mm
JG - 16MM	Plastic Circular Nail Clip of Diameter 16mm
JG - 18MM	Plastic Circular Nail Clip of Diameter 18mm
JG - 20MM	Plastic Circular Nail Clip of Diameter 20mm 36GM
JG - 20MM	Plastic Circular Nail Clip of Diameter 20mm
JG - 25MM	Plastic Circular Nail Clip of Diameter 25mm 56GM
JG - 25MM	Plastic Circular Nail Clip of Diameter 25mm
JG - 20MM	Plastic Circular Nail Clip of Diameter 20mm Double nail
JG - 25MM	Plastic Circular Nail Clip of Diameter 25mm Double nail
JG - 32MM	Plastic Circular Nail Clip of Diameter 32mm Double nail
JG - 40MM	Plastic Circular Nail Clip of Diameter 40mm Double nail
JG - 50MM	Plastic Circular Nail Clip of Diameter 50mm Double nail
JG - BS (R)	BATTEN GATTY ROUND
JG - BS (S)	BATTEN GATTY SQUARE



# CABLE TERMINAL ENDS

## INSULATED CORD END TERMINALS

Item No.	F (mm)	L (mm)	W (mm)	D (mm)	C (mm)	Cable size (mm <sup>2</sup> )	Insulating tube color
JG-E0508	8	14	2.6	1.3	1	0.5	Orange/White
JG-E0510	10	16	2.6	1.3	1	0.5	Orange/White
JG-E7508	8	14.4	2.8	1.5	1.2	0.75	Grey/Light Blue
JG-E7510	10	16.4	2.8	1.5	1.2	0.75	Grey/Light Blue
JG-E1008	8	14.4	3	1.7	1.4	1	Red
JG-E1010	10	16.4	3	1.7	1.4	1	Red
JG-E1508	8	14.4	3.5	2	1.7	1.5	Red/Black
JG-E1510	10	16.4	3.5	2	1.7	1.5	Red/Black
JG-E2508	8	15.2	4	2.6	2.3	2.5	Blue
JG-E2510	10	17.2	4	2.6	2.3	2.5	Blue
JG-E4009	9	16.5	4.4	3.2	2.8	4	Grey/Orange
JG-E4012	12	19.5	4.4	3.2	2.8	4	Grey/Orange
JG-E6010	10	18.5	6.3	3.9	3.5	6	Green
JG-E6012	12	20.5	6.3	3.9	3.5	6	Green
JG-E10-12	12	22.5	7.6	4.9	4.5	10	Brown
JG-E16-12	12	23.5	8.8	6.2	5.8	16	Ivory
JG-E25-22	22	34.5	11.2	7.9	7.5	25	Yellow
JG-E35-25	25	39.5	12.7	8.7	8.3	35	Brown
JG-E50-25	25	41	15.3	10.9	10.3	50	Brown



Material  
Insulation : Nylon  
Terminal Body : Copper  
Plating : Tin



# CABLE TERMINAL ENDS

## INSULATED TWIN CORD END TERMINALS

Item No.	F (mm)	L (mm)	W (mm)	B (mm)	D (mm)	C (mm)	Cable size (mm <sup>2</sup> )	Insulating tube color
JG-TE0508	8	14.5	5	6.5	1.8	1.5	2×0.5	White
JG-TE7508	8	14.7	5.5	6.7	2.1	1.8	2×0.75	Blue
JG-TE1008	8	15.1	5.5	7.1	2.3	2	2×1.0	Red
JG-TE1508	8	15.5	6.4	7.5	2.6	2.3	2×1.5	Black
JG-TE2510	10	18.5	8	8.5	3.3	2.9	2×2.5	Grey
JG-TE4012	12	23.1	8.8	11.1	4.2	3.8	2×4	Orange
JG-TE6014	14	26.1	9.5	12.1	5.3	4.9	2×6	Green
JG-TE10-14	14	26.6	12.6	12.6	6.9	6.5	2×10	Brown
JG-TE16-14	14	31.3	19	17.3	8.7	8.3	2×16	Ivory

Material  
Insulation : Nylon  
Terminal Body : Copper  
Plating : Tin

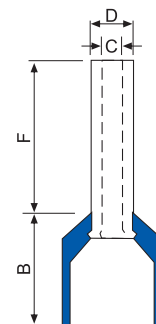
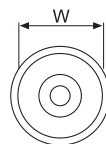

# BI-METTALIC LUGS

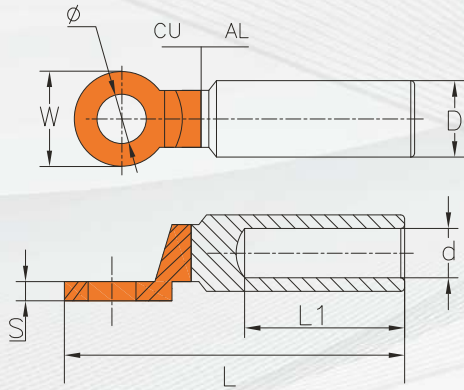

## FEATURES & TECHNICAL SPECIFICATION

- Suitable for aluminum to copper terminations
- Aluminium barrel is filled by neutral grease and covered by cap
- Friction welded
- Material: CU 99.9%, AL 99.5%

Model No.	$\phi \pm 0.3$	$D \pm 0.2$	$d \pm 0.2$	$L \pm 2$	$L1 \pm 2$	$W \pm 0.2$	$S \pm 0.2$
JG-DTL-2-16	10.5	16	6.5	80	42	20	3.0
JG-DTL-2-25	10.5	16	7.5	80	42	20	3.0
JG-DTL-2-35	10.5	16	8.5	80	42	20	3.0
JG-DTL-2-50	12.8	20	9.8	90	43	25	4.5
JG-DTL-2-70	12.8	20	11.5	90	43	25	4.5
JG-DTL-2-95	12.8	20	13.5	90	43	25	4.5
JG-DTL-2-120	12.8	25	15.0	114	60	30	5.5
JG-DTL-2-150	12.8	25	16.5	114	60	30	5.5
JG-DTL-2-185	12.8	32	18.5	118	60	35	6.0
JG-DTL-2-240	12.8	32	21.5	118	60	35	6.0
JG-DTL-2-300	12.8	34	23.5	127	72	35	6.0
JG-DTL-2-400	17.0	40	26.0	160	93	36	7.0
JG-DTL-2-630	17.0	47	32.5	180	94	50	9.0



# NYLON CABLE GLANDS

## PG THREAD CABLE GLANDS

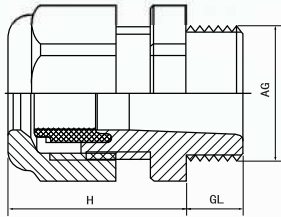

Material : Nylon(PA)  
 Sealing Element :NBR  
 Protection level : IP68  
 Ambient temperature : static-40°C-100°C, short 120°C  
 dynamic -20°C-80°C, short 120°C  
 Colour : White Grey Black

Code	Model Thread	Cable Range	GL (mm)	H (mm)	Spanner Size A & E (mm)
JG 7	PG 7	3 ~ 6.5	8	21	15
JG 9	PG 9	4 ~ 8	8	22	19
JG 11	PG 11	5 ~ 10	8	25	22
JG 13.5	PG 13.5	6 ~ 12	9	27	24
JG 16	PG 16	10 ~ 14	10	28	27
JG 18	PG 18	12 ~ 16	11	29	27
JG 21	PG 21	13 ~ 18	11	31	33
JG 25	PG 25	14 ~ 21	12	32	36
JG 27	PG 27	15 ~ 23	12	33	38
JG 29	PG 29	18 ~ 25	11	39	42
JG 36	PG 36	22 ~ 32	13	48	53
JG 42	PG 42	32 ~ 38	13	48	60
JG 48	PG 48	37 ~ 44	14	49	65
JG 63	PG 63	40 ~ 50	29	95	75

# NYLON CABLE GLANDS

## M THREAD CABLE GLANDS

Code	Model Thread	Cable Range	GL (mm)	H (mm)	Spanner Size A & E (mm)
JG - M12	M 12x1.5	3 ~ 6.5	8	21	15
JG - M16	M 16x1.5	4 ~ 8	8	22	19
JG - M20	M 20x1.5	6 ~ 12	9	27	24
JG - M25	M 25x1.5	12 ~ 16	11	29	27
JG - M32	M 32x1.5	15 ~ 23	12	33	38
JG - M40	M 40x1.5	22 ~ 32	18	45	46
JG - M50	M 50x1.5	32 ~ 38	18	47	56
JG - M63	M 63x1.5	37 ~ 44	20	47	68

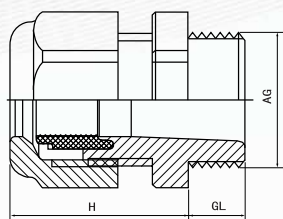

Material : Nylon(PA)  
 Sealing Element :NBR  
 Protection level : IP68  
 Ambient temperature : static-40°C-100°C, short 120°C  
 dynamic -20°C-80°C, short 120°C  
 Colour : White Grey Black

## MG THREAD CABLE GLANDS

Code	Model Thread	Cable Range	GL (mm)	Spanner Size A & E (mm)
JG - MG20	MG 20x1.5	14 ~ 8.5	15	27/27
JG - MG25	MG 25x1.5	18 ~ 12.5	15	33/33
JG - MG32	MG 32x1.5	25 ~ 18	15	41/41
JG - MG40	MG 40x1.5	32.5 ~ 24	15	50/50
JG - MG50	MG 50x1.5	41 ~ 30	20	62/62
JG - MG63	MG 63x1.5	54 ~ 40	20	75/75



Thread Specification : Metric Teeth  
 Material : Nylon PA66 (fire rating UL94V-2)  
 Sealing Element :NBR  
 Protection level : IP68  
 Ambient temperature : static-40°C-100°C, short 120°C  
 dynamic -20°C-80°C, short 120°C  
 Colour : White Grey Black



# METAL CABLE GLANDS

## PG THREAD CABLE GLANDS

Code	Model Thread	Cable Range	GL (mm)	H (mm)	Spanner Size A & E (mm)
JG - PG7 (M)	PG 7	3 ~ 6.5	5	19	14
JG - PG9 (M)	PG 9	4 ~ 8	6	20	17
JG - PG11 (M)	PG 11	5 ~ 10	6	21	20
JG - PG13.5 (M)	PG 13.5	6 ~ 12	6.5	22	22
JG - PG16 (M)	PG 16	10 ~ 14	6.5	23	24
JG - PG21 (M)	PG 21	13 ~ 18	7	25	30
JG - PG29 (M)	PG 29	18 ~ 25	8	29	40
JG - PG36 (M)	PG 36	22 ~ 32	8	35	50
JG - PG42 (M)	PG 42	32 ~ 38	9	37	57

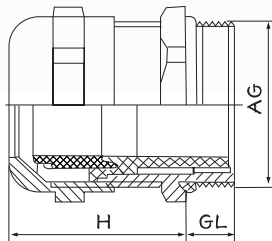

Material : Nickel-Plated Brass  
Clamping member: nylon plastic (PA)  
Seal : Nitrile Rubber (NBR)  
O-ring : Nitrile Rubber (NBR)  
Protection level : IP68  
Ambient temperature : static-40°C-100°C, short 120°C



# NYLON CABLE HOSE & GLAND

## NYLON HOSE

Code	Specification for Flexible Pipe	ID x OD (mm)	Stat. R (mm)	Gland Ref
JG - AD10	AD10 1/4 "	6.5 x 10	15	PG 7
JG - AD13	AD13 5/16 "	10 x 13	20	PG 9
JG - AD15.8	AD15.8 3/8 "	12 x 15.8	25	PG 11
JG - AD18.5	AD18.5	14.3 x 18.5	35	PG13.5
JG - AD21.2	AD21.2 1/2 "	16.5 x 21.2	40	PG 16
JG - AD28.5	AD28.5 3/4 "	23 x 28.5	45	PG 21
JG - AD34.5	AD34.5 1 "	29 x 34.5	55	PG 29
JG - AD42.5	AD42.5 1 1/4 "	36 x 42.5	65	PG 36
JG - AD54.5	AD54.5 2 "	48 x 54.5	80	PG 48

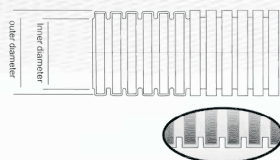

Material : Nylon  
 Colour : Black  
 Temperature: static-40°C-115°C, short 150°C  
 Structure : Wavy (Internal + External)



## NYLON HOSE GLAND

Model	Hose Specificaion	Gland Ref	GL (mm)	H (mm)	F (mm)
JG - RJ7	AD10	PG 7	10	34	17
JG - RJ9	AD13	PG 9	10	34	20
JG - RJ11	AD15.8	PG 11	10	32.5	20
JG - RJ13.5	AD18.5	PG13.5	11	40	26
JG - RJ16	AD21.2	PG 16	12	43.5	29.5
JG - RJ21	AD28.5	PG 21	13	46	37
JG - RJ29	AD34.5	PG 29	11	47	44
JG - RJ36	AD42.5	PG 36	13	50.5	51.5
JG - RJ48	AD54.5	PG 48	15	54	64

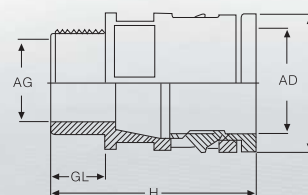

# INDUSTRIAL PLUG & SOCKET

## INDUSTRIAL PLUG



Application	Code	Normal Current	Normal Voltage	No.poles	Protection Degree
Plug	<b>JG-012</b>	16A	220-250V~	2P+E	IP44

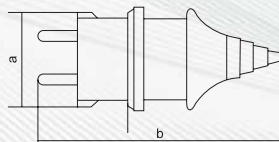

Size(mm)	a	b	Cable nominal cross section area
Type			
<b>JG-012</b>	40	96	1-2.5mm <sup>2</sup>



Application	Code	Normal Current	Earth contact Position	Normal Voltage	No.poles	Protection Degree
Plug	<b>JG-013</b>	16A	6h	220-250V~	2P+E	IP44
Plug	<b>JG-023</b>	32A	6h	220-250V~	2P+E	IP44

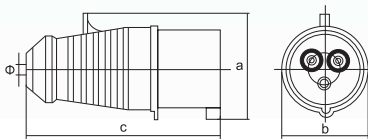

Size(mm)	a	b	c	Φ	Cable nominal cross section area
Type					
<b>JG-013</b>	59	51	122	6	1-2.5mm <sup>2</sup>
<b>JG-023</b>	75	64	136	8	2.5-6mm <sup>2</sup>



Application	Code	Normal Current	Earth contact Position	Normal Voltage	No.poles	Protection Degree
Plug	<b>JG-014</b>	16A	6h	380-415V~	3P+E	IP44
Plug	<b>JG-024</b>	32A	6h	380-415V~	3P+E	IP44

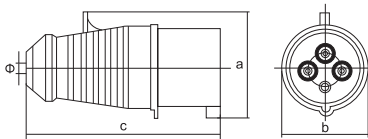

Size(mm)	a	b	c	Φ	Cable nominal cross section area
Type					
<b>JG-014</b>	65	55	122	6	1-2.5mm <sup>2</sup>
<b>JG-024</b>	75	64	136	8	2.5-6mm <sup>2</sup>



Application	Code	Normal Current	Earth contact Position	Normal Voltage	No.poles	Protection Degree
Plug	<b>JG-015</b>	16A	6h	220-380V~ 240-415V~	3P+N+E	IP44
Plug	<b>JG-025</b>	32A	6h	220-380V~ 240-415V~	3P+N+E	IP44

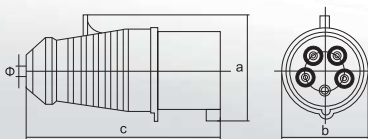

Size(mm)	a	b	c	Φ	Cable nominal cross section area
Type					
<b>JG-015</b>	72	64	130	8	1-2.5mm <sup>2</sup>
<b>JG-025</b>	84	70	143	8	2.5-6mm <sup>2</sup>



# INDUSTRIAL PLUG & SOCKET

## INDUSTRIAL PLUG

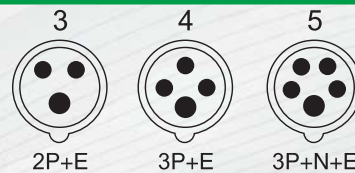

Application	Code	Normal Current	Earth contact Position	Normal Voltage	No.poles	Protection Degree
Plug	<b>JG-033</b>	63A	6h	220-250V~	2P+E	IP67
Plug	<b>JG-043</b>	125A	6h	220-250V~	2P+E	IP67

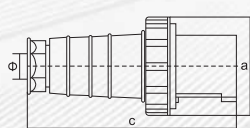

Size(mm)	a	b	c	Φ	Cable nominal cross section area
Type					
<b>JG-033/043</b>	108	108	230	16	6-16mm <sup>2</sup>



Application	Code	Normal Current	Earth contact Position	Normal Voltage	No.poles	Protection Degree
Plug	<b>JG-035</b>	63A	6h	220-380V~ 240-415V~	3P+N+E	IP67
Plug	<b>JG-045</b>	125A	6h	220-380V~ 240-415V~	3P+N+E	IP67

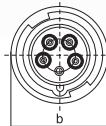
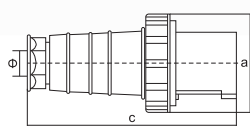

Size(mm)	a	b	c	Φ	Cable nominal cross section area
Type					
<b>JG-035/045</b>	108	108	230	16	6-16mm <sup>2</sup>



# INDUSTRIAL PLUG & SOCKET

## INDUSTRIAL WALL SOCKETS



Application	Code	Normal Current	Normal Voltage	No.poles	Protection Degree
Socket	<b>JG-112</b>	16A	220-250V~	2P+E	IP44

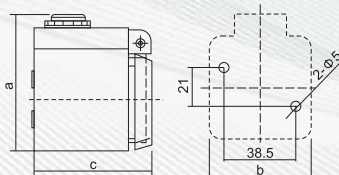

Size(mm)	a	b	c	Cable nominal cross section area
<b>JG-112</b>	70	53	67	1-2.5mm <sup>2</sup>



Application	Code	Normal Current	Earth contact Position	Normal Voltage	No.poles	Protection Degree
Socket	<b>JG-113</b>	16A	6h	220-250V~	2P+E	IP44
Socket	<b>JG-123</b>	32A	6h	220-250V~	2P+E	IP44

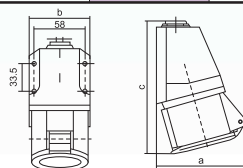

Size(mm)	a	b	c	Cable nominal cross section area
<b>JG-113</b>	90	71	135	1-2.5mm <sup>2</sup>
<b>JG-123</b>	100	71	151	2.5-6mm <sup>2</sup>



Application	Code	Normal Current	Earth contact Position	Normal Voltage	No.poles	Protection Degree
Socket	<b>JG-114</b>	16A	6h	380-415V~	3P+E	IP44
Socket	<b>JG-124</b>	32A	6h	380-415V~	3P+E	IP44

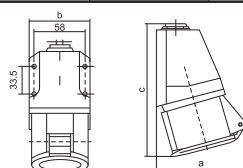

Size(mm)	a	b	c	Cable nominal cross section area
<b>JG-114</b>	92	71	140	1-2.5mm <sup>2</sup>
<b>JG-124</b>	102	71	151	2.5-6mm <sup>2</sup>



Application	Code	Normal Current	Earth contact Position	Normal Voltage	No.poles	Protection Degree
Socket	<b>JG-115</b>	16A	6h	220-380V~ 240-415V~	3P+N+E	IP44
Socket	<b>JG-125</b>	32A	6h	220-380V~ 240-415V~	3P+N+E	IP44

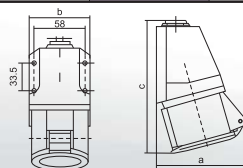

Size(mm)	a	b	c	Cable nominal cross section area
<b>JG-115</b>	100	71	131	1-2.5mm <sup>2</sup>
<b>JG-125</b>	109	71	152	2.5-6mm <sup>2</sup>

# INDUSTRIAL PLUG & SOCKET

## INDUSTRIAL WALL SOCKETS



Application	Code	Normal Current	Earth contact Position	Normal Voltage	No.poles	Protection Degree
Socket	<b>JG-133</b>	63A	6h	220-250V~	2P+E	IP67
Socket	<b>JG-143</b>	125A	6h	220-250V~	2P+E	IP67

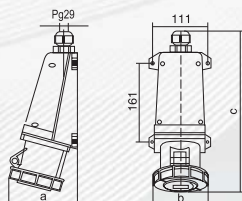

Size(mm)	a	b	c	Cable nominal cross section area
Type				
<b>JG-133/143</b>	133	108	310	6-25mm <sup>2</sup>



Application	Code	Normal Current	Earth contact Position	Normal Voltage	No.poles	Protection Degree
Socket	<b>JG-135</b>	63A	6h	220-380V~ 240-415V~	3P+N+E	IP67
Socket	<b>JG-145</b>	125A	6h	220-380V~ 240-415V~	3P+N+E	IP67

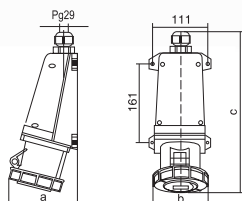

Size(mm)	a	b	c	Cable nominal cross section area
Type				
<b>JG-135/145</b>	133	108	310	6-25mm <sup>2</sup>



# INDUSTRIAL PLUG & SOCKET

## INDUSTRIAL STRAIGHT SOCKETS



Application	Code	Normal Current	Normal Voltage	No.poles	Protection Degree
Coupler	<b>JG-212</b>	16A	220-250V~	2P+E	IP44

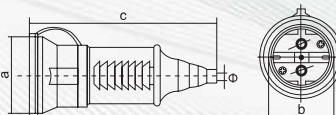

Size(mm)	a	b	c	Cable nominal cross section area
Type				
<b>JG-212</b>	72	48	123	1-2.5mm <sup>2</sup>



Application	Code	Normal Current	Earth contact Position	Normal Voltage	No.poles	Protection Degree
Coupler	<b>JG-213</b>	16A	6h	220-250V~	2P+E	IP44
Coupler	<b>JG-223</b>	32A	6h	220-250V~	2P+E	IP44

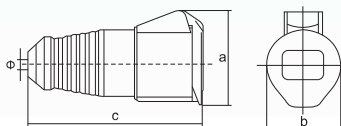

Size(mm)	a	b	c	Φ	Cable nominal cross section area
Type					
<b>JG-213</b>	72	51	132	6	1-2.5mm <sup>2</sup>
<b>JG-223</b>	92	64	146	8	2.5-6mm <sup>2</sup>



Application	Code	Normal Current	Earth contact Position	Normal Voltage	No.poles	Protection Degree
Coupler	<b>JG-214</b>	16A	6h	380-415V~	3P+E	IP44
Coupler	<b>JG-224</b>	32A	6h	380-415V~	3P+E	IP44

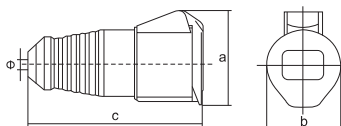

Size(mm)	a	b	c	Φ	Cable nominal cross section area
Type					
<b>JG-214</b>	78	55	132	6	1-2.5mm <sup>2</sup>
<b>JG-224</b>	92	64	146	8	2.5-6mm <sup>2</sup>



Application	Code	Normal Current	Earth contact Position	Normal Voltage	No.poles	Protection Degree
Coupler	<b>JG-215</b>	16A	6h	220-380V~ 240-415V~	3P+N+E	IP44
Coupler	<b>JG-225</b>	32A	6h	220-380V~ 240-415V~	3P+N+E	IP44

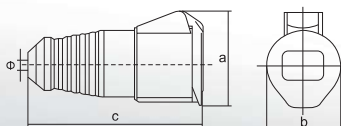

Size(mm)	a	b	c	Φ	Cable nominal cross section area
Type					
<b>JG-215</b>	92	63	139	6	1-2.5mm <sup>2</sup>
<b>JG-225</b>	101	70	154	8	2.5-6mm <sup>2</sup>

# INDUSTRIAL PLUG & SOCKET

## INDUSTRIAL STRAIGHT SOCKETS



Application	Code	Normal Current	Earth contact Position	Normal Voltage	No.poles	Protection Degree
Coupler	<b>JG-233</b>	63A	6h	220-250V~	2P+E	IP67
Coupler	<b>JG-243</b>	125A	6h	220-250V~	2P+E	IP67

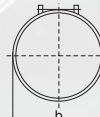
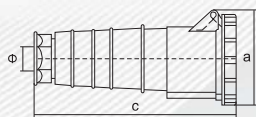

Size(mm)	a	b	c	Cable nominal cross section area
Type				
<b>JG-233/243</b>	116	108	245	6-16mm <sup>2</sup>



Application	Code	Normal Current	Earth contact Position	Normal Voltage	No.poles	Protection Degree
Coupler	<b>JG-235</b>	63A	6h	220-380V~ 240-415V~	3P+N+E	IP67
Coupler	<b>JG-245</b>	125A	6h	220-380V~ 240-415V~	3P+N+E	IP67

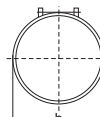
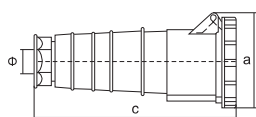

Size(mm)	a	b	c	Cable nominal cross section area
Type				
<b>JG-235/245</b>	116	108	245	6-16mm <sup>2</sup>



# INDUSTRIAL PLUG & SOCKET

## INDUSTRIAL REV PLUG



Application	Code	Normal Current	Earth contact Position	Normal Voltage	No.poles	Protection Degree
Plug	<b>JG-613</b>	16A	6h	220-250V~	2P+E	IP44
Plug	<b>JG-623</b>	32A	6h	220-250V~	2P+E	IP44

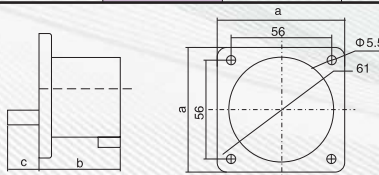

Size(mm)	a	b	c	Cable nominal cross section area
Type				
<b>JG-613</b>	70	41	24	1-2.5mm <sup>2</sup>
<b>JG-623</b>	70	50	28	2.5-6mm <sup>2</sup>



Application	Code	Normal Current	Earth contact Position	Normal Voltage	No.poles	Protection Degree
Plug	<b>JG-614</b>	16A	6h	380-415V~	3P+E	IP44

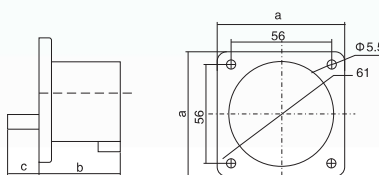

Size(mm)	a	b	c	Cable nominal cross section area
Type				
<b>JG-614</b>	70	41	24	1-2.5mm <sup>2</sup>



Application	Code	Normal Current	Earth contact Position	Normal Voltage	No.poles	Protection Degree
Plug	<b>JG-615</b>	16A	6h	220-380V~ 240-415V~	3P+N+E	IP44
Plug	<b>JG-625</b>	32A	6h	220-380V~ 240-415V~	3P+N+E	IP44

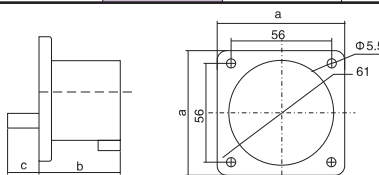

Size(mm)	a	b	c	Cable nominal cross section area
Type				
<b>JG-615</b>	70	41	24	1-2.5mm <sup>2</sup>
<b>JG-625</b>	70	51	29	2.5-6mm <sup>2</sup>

# INDUSTRIAL PLUG & SOCKET

## INDUSTRIAL PLUG IP 67



Application	Code	Normal Current	Earth contact Position	Normal Voltage	No.poles	Protection Degree
Plug	<b>JG-0132</b>	16A	6h	220-250V~	2P+E	IP67
Plug	<b>JG-0232</b>	32A	6h	220-250V~	2P+E	IP67

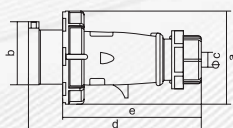

Size(mm) Type	a	b	Φc	d	e	Cable nominal cross section area
	<b>JG-0132</b>	75.5	47	7-15	139	112
<b>JG-0232</b>	99	63	10-20	175	130	2.5-6mm <sup>2</sup>



Application	Code	Normal Current	Earth contact Position	Normal Voltage	No.poles	Protection Degree
Plug	<b>JG-0152</b>	16A	6h	220-380V~ 240-415V~	3P+N+E	IP67
Plug	<b>JG-0252</b>	32A	6h	220-380V~ 240-415V~	3P+N+E	IP67

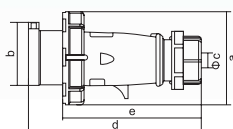

Size(mm) Type	a	b	Φc	d	e	Cable nominal cross section area
	<b>JG-0152</b>	92	60	8-16	139	95
<b>JG-0252</b>	107	70	12-22	170	124	2.5-6mm <sup>2</sup>



Application	Code	Normal Current	Earth contact Position	Normal Voltage	No.poles	Protection Degree
Plug	<b>JG-0352</b>	63A	6h	220-380V~ 240-415V~	3P+N+E	IP67

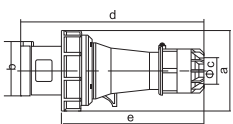

Size(mm) Type	a	b	Φc	d	e	Cable nominal cross section area
	<b>JG-0352</b>	116	75	37	251	187



# INDUSTRIAL PLUG & SOCKET

## INDUSTRIAL WALL SOCKET IP 67



Application	Code	Normal Current	Earth contact Position	Normal Voltage	No.poles	Protection Degree
Socket	<b>JG-1132</b>	16A	6h	220-250V~	2P+E	IP67
Socket	<b>JG-1232</b>	32A	6h	220-250V~	2P+E	IP67

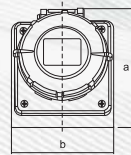
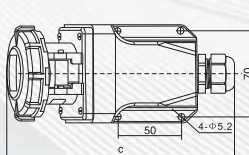

Type	Size(mm)			Cable nominal cross section area
	a	b	c	
<b>JG-1132</b>	95	75	193	1-2.5mm <sup>2</sup>
<b>JG-1232</b>	105	75	203	2.5-6mm <sup>2</sup>



Application	Code	Normal Current	Earth contact Position	Normal Voltage	No.poles	Protection Degree
Socket	<b>JG-1152</b>	16A	6h	$\frac{220-380V}{240-415V}$ ~	3P+N+E	IP67
Socket	<b>JG-1252</b>	32A	6h	$\frac{220-380V}{240-415V}$ ~	3P+N+E	IP67

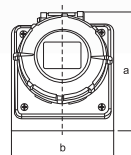
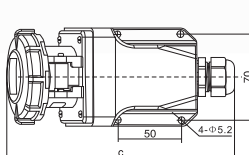

Type	Size(mm)			Cable nominal cross section area
	a	b	c	
<b>JG-1152</b>	100	75	185	1-2.5mm <sup>2</sup>
<b>JG-1252</b>	105	75	200	2.5-6mm <sup>2</sup>



Application	Code	Normal Current	Earth contact Position	Normal Voltage	No.poles	Protection Degree
Socket	<b>JG-1352</b>	63A	6h	$\frac{220-380V}{240-415V}$ ~	3P+N+E	IP67

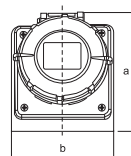
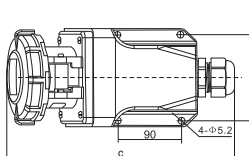

Type	Size(mm)			Cable nominal cross section area
	a	b	c	
<b>JG-1352</b>	130	105	275	10-16mm <sup>2</sup>

# INDUSTRIAL PLUG & SOCKET

## INDUSTRIAL STRAIGHT SOCKET IP 67



Application	Code	Normal Current	Earth contact Position	Normal Voltage	No.poles	Protection Degree
Coupler	<b>JG-2132</b>	16A	6h	220-250V~	2P+E	IP67
Coupler	<b>JG-2232</b>	32A	6h	220-250V~	2P+E	IP67

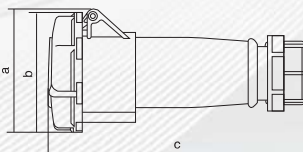

Size(mm) Type	a	b	c	Cable nominal cross section area
	<b>JG-2132</b>	79	77	
<b>JG-2232</b>	102	102	205	2.5-6mm <sup>2</sup>



Application	Code	Normal Current	Earth contact Position	Normal Voltage	No.poles	Protection Degree
Coupler	<b>JG-2152</b>	16A	6h	220-380V~ 240-415V~	3P+N+E	IP67
Coupler	<b>JG-2252</b>	32A	6h	220-380V~ 240-415V~	3P+N+E	IP67

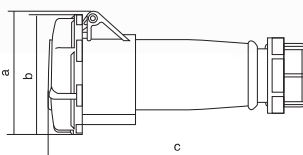

Size(mm) Type	a	b	c	Cable nominal cross section area
	<b>JG-2152</b>	97	90	
<b>JG-2252</b>	109	103	210	2.5-6mm <sup>2</sup>



Application	Code	Normal Current	Earth contact Position	Normal Voltage	No.poles	Protection Degree
Coupler	<b>JG-2352</b>	63A	6h	220-380V~ 240-415V~	3P+N+E	IP67

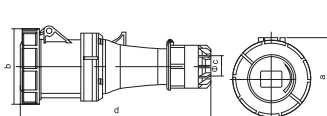

Size(mm) Type	a	b	c	d	Cable nominal cross section area
	<b>JG-2352</b>	114	117	37	



# INDUSTRIAL PLUG & SOCKET

## MULTI-FUNCTION PLUG & SOCKET CONNECTOR

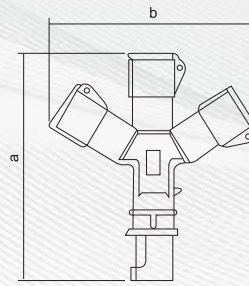
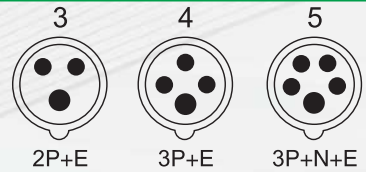

Code	Normal Current	Earth Contact Position	Normal Voltage	No.poles	Protection Degree	Size(mm)	
						a	b
<b>JG-1013</b>	16A	6h	220-240V~	2P+E	IP44	223	220
<b>JG-1023</b>	32A	6h	220-240V~	2P+E	IP44	318	305

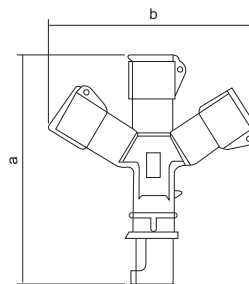

Code	Normal Current	Earth Contact Position	Normal Voltage	No.poles	Protection Degree	Size(mm)	
						a	b
<b>JG-1015</b>	16A	6h	220-380V~ 240-415V~	3P+N+E	IP44	305	295



# INDUSTRIAL PLUG & SOCKET

## ANGULAR PLUG & SOCKET



Application	Code	Normal Current	Earth contact Position	Normal Voltage	No.poles	Protection Degree
Socket	<b>JG-413</b>	16A	6h	220-250V~	2P+E	IP44

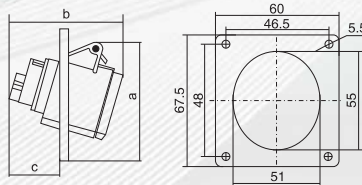

Size(mm)	a	b	c	Cable nominal cross section area
Type				
ZZ-413	74	72	45	1-2.5mm <sup>2</sup>



Application	Code	Normal Current	Earth contact Position	Normal Voltage	No.poles	Protection Degree
Socket	<b>JG-425</b>	32A	6h	220-380V~ 240-415V~	3P+N+E	IP44

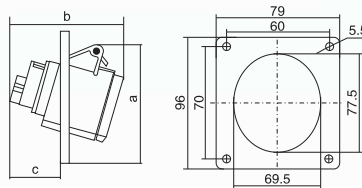

Size(mm)	a	b	c	Cable nominal cross section area
Type				
ZZ-425	102	95	51	2.5-6mm <sup>2</sup>

## 3RD GENERATION INDUSTRIAL PLUG



Application	Code	Normal Current	Earth contact Position	Normal Voltage	No.poles	Protection Degree
Plug	<b>JG-013X</b>	16A	6h	220-250V~	2P+E	IP44
Plug	<b>JG-023X</b>	32A	6h	220-250V~	2P+E	IP44

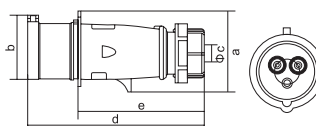

Size(mm)	a	b	Φc	d	e	Cable nominal cross section area
Type						
<b>JG-013X</b>	58	47	7-15	135	104	1-2.5mm <sup>2</sup>
<b>JG-023X</b>	80.7	63	10-20	171	130	2.5-6mm <sup>2</sup>



Application	Code	Normal Current	Earth contact Position	Normal Voltage	No.poles	Protection Degree
Plug	<b>JG-015X</b>	16A	6h	220-380V~ 240-415V~	3P+N+E	IP44
Plug	<b>JG-025X</b>	32A	6h	220-380V~ 240-415V~	3P+N+E	IP44

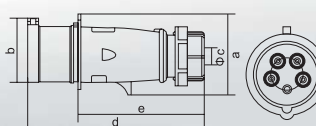

Size(mm)	a	b	Φc	d	e	Cable nominal cross section area
Type						
<b>JG-015X</b>	75	60	8-16	145	112	1-2.5mm <sup>2</sup>
<b>JG-025X</b>	89	70	12-22	178	132	2.5-6mm <sup>2</sup>



# INDUSTRIAL PLUG & SOCKET

## 3RD GENERATION INDUSTRIAL STRAIGHT SOCKET



Application	Code	Normal Current	Earth contact Position	Normal Voltage	No.poles	Protection Degree
Coupler	<b>JG-213X</b>	16A	6h	220-250V~	2P+E	IP44
Coupler	<b>JG-223X</b>	32A	6h	220-250V~	2P+E	IP44

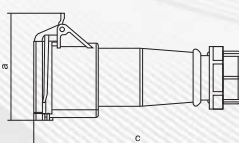

Size(mm)		a	b	c	Cable nominal cross section area
Type					
<b>JG-213X</b>		83	60	155	1-2.5mm <sup>2</sup>
<b>JG-223X</b>		102	82.5	195	2.5-6mm <sup>2</sup>



Application	Code	Normal Current	Earth contact Position	Normal Voltage	No.poles	Protection Degree
Coupler	<b>JG-215X</b>	16A	6h	$\frac{220-380V}{240-415V}$ ~	3P+N+E	IP44
Coupler	<b>JG-225X</b>	32A	6h	$\frac{220-380V}{240-415V}$ ~	3P+N+E	IP44

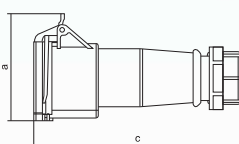

Size(mm)		a	b	c	Cable nominal cross section area
Type					
<b>JG-215X</b>		100	76	160	1-2.5mm <sup>2</sup>
<b>JG-225X</b>		110	90	200	2.5-6mm <sup>2</sup>

## 3RD GENERATION INDUSTRIAL WALL SOCKET



Appellation	Code	Normal Current	Earth contact Position	Normal Voltage	No.poles	Protection Degree
Socket	<b>JG-113X</b>	16A	6h	220-250V~	2P+E	IP44
Socket	<b>JG-123X</b>	32A	6h	220-250V~	2P+E	IP44

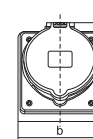
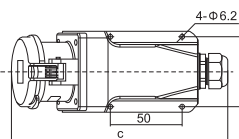

Size(mm)		a	b	c	Cable nominal cross section area
Type					
<b>JG-113X</b>		104	80	181	1-2.5mm <sup>2</sup>
<b>JG-123X</b>		114	80	192	2.5-6mm <sup>2</sup>



Appellation	Code	Normal Current	Earth contact Position	Normal Voltage	No.poles	Protection Degree
Socket	<b>JG-115X</b>	16A	6h	$\frac{220-380V}{240-415V}$ ~	3P+N+E	IP44
Socket	<b>JG-125X</b>	32A	6h	$\frac{220-380V}{240-415V}$ ~	3P+N+E	IP44

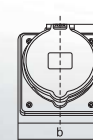
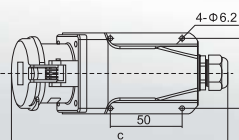

Size(mm)		a	b	c	Cable nominal cross section area
Type					
<b>JG-115X</b>		110	80	181	1-2.5mm <sup>2</sup>
<b>JG-125X</b>		114	80	192	2.5-6mm <sup>2</sup>

# JUNCTION BOX

## IP65 - ABS JUNCTION BOX

Model	Specification
JG - JB 100	ABS Junction Box - 100X100X70
JG - JB 150110	ABS Junction Box - 150X110X70
JG - JB 150	ABS Junction Box - 150X150X70
JG - JB 200	ABS Junction Box - 200X155X80
JG - JB 255	ABS Junction Box - 255X200X80
JG - JB 300	ABS Junction Box - 300X250X120
JG - JB 400	ABS Junction Box - 400X350X120



## IP67 - POLYCARBONATE JUNCTION BOX

### WITHOUT TERMINAL

Model	Specification
JG - JB 9020Z	Polycarbonate Junction Box - 88X88X53
JG - JB 9040Z	Polycarbonate Junction Box - 98X98X61
JG - JB 9060Z	Polycarbonate Junction Box - 139X119X70
JG - JB 9100Z	Polycarbonate Junction Box - 167X125X82
JG - JB 9250Z	Polycarbonate Junction Box - 200X160X98



### WITH TERMINAL

Model	Specification
JG - JB 9025Z	PC Junction Box with Terminal - 88X88X53
JG - JB 9045Z	PC Junction Box with Terminal - 98X98X61
JG - JB 9065Z	PC Junction Box with Terminal - 139X119X70
JG - JB 9105Z	PC Junction Box with Terminal - 167X125X82
JG - JB 9255Z	PC Junction Box with Terminal - 200X160X98



## WATERPROOF BOX WITH PLUG & SOCKET

Model	Specification
JG-1801	16A 3 Pin 3 Socket With 4 Modular Mcb Channel
JG-1802	16A 3 Pin 3 Socket With One Plug and 4 Modular Mcb Channel
JG-413	16A 3 Pin 4 Socket With One Plug and 12 Modular Mcb Channel
JG-ZH1601	16A 3 Pin 2 Socket and 32 A 5 Pin 1 Socket 10 Modular Mcb Channel
JG-ZH1602	16A 3 Pin 1 Socket and 32 A 5 Pin 2 Socket 10 Modular Mcb Channel
JG-ZH1603	16A 3 Pin 3 Socket ,32 A 5 Pin 1 Socket and With Emergency 10 Modular Mcb Channel
JG-DZ18-PLA	Switch and socket box with 3M cable



JG-ZH1601



JG-ZH1602



JG-413



JG-1801



JG-DZ18-PLA



JG-1802



JG-ZH1603

## MECHANICAL INTERLOCK SOCKET WITH SWITCH

Model	Specification
JG-7274	16A 3 Pin Socket
JG-7276	15A 5 Pin Socket
JG-7012	16A 3 Pin
JG-5103	16 A 3 Pin
JG-5108	32 A 5 Pin
JG-5956	63 A 3 Pin



# DISTRIBUTION BOX

## HT SERIES - DISTRIBUTION BOX

Panel is the ABS material for the engineering, high strength, never change color, the transparent material is PC.

### Cover push-type opening and closing

Face covering of the distribution box adopts the push-type opening and closing mode, the face mask can be opened by pressing lightly, the self-locking positioning hinge structure is provided when opening.

### Wiring design of the power distribution box

The guide rail support plate can be lifted to the highest movable point, it is no longer limited by the narrow space when installing the wire. To install easily, the switch of the distribution box is set up with the wire groove and wire pipe exit-holes, which are easy to use for a variety of wire grooves and wire pipes.

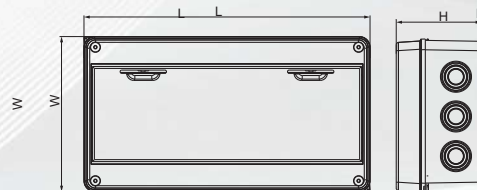

Model	Dimensions		
	L(mm)	W (mm)	H (mm)
JG-HT-2P	57	124	70
JG-HT-5P	119	159	90
JG-HT-12P	255	198	108
JG-HT-18P	363	198	108
JG-HT-24P	363	280	108

## 56CB SERIES MCB BOX

Model	Specification
JG-56CB4N	4 Way Mcb Box With Indicator
JG-56CB8N	8 Way Mcb Box With Indicator
JG-56CB4N A	4 Way Mcb Box With Indicator and 15A 3 Pin Socket
JG-56CB8N A	8 Way Mcb Box With Indicator and 32A 5 Pin Socket



# DISTRIBUTION BOX

## SH SERIES - MCB DISTRIBUTION BOX

### Features

- Humanized circuitry symbols, printed display of control circuit breaker, clear and elegant.
- The guide-rail shoe plate has round hole, it is able to regulate the cover of distribution box to level position.
- The distribution box is able to regulate the height automatically within a certain range from the outer wall.

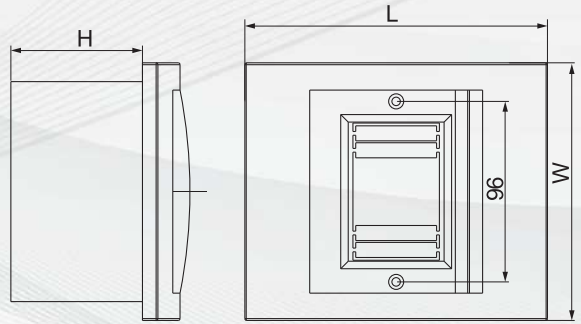

Concealed mounted

Model	Dimensions		
	L (mm)	W (mm)	H (mm)
JG-SH-2-4	137	161	82
JG-SH-4-6	208	208	95
JG-SH-7-9	261	208	95
JG-SH-10-13	334	208	95



## SH NEW SERIES - MCB DISTRIBUTION BOX

<b>Product Name</b>	Waterproof Distribution Board
<b>Cover Material</b>	Plastic(ABS,PS)
<b>Color</b>	White /Clear/Grey/Customized
<b>Application</b>	indoor
<b>Rated Voltage</b>	220V-380V

Model	Dimensions		
	L (mm)	W (mm)	H (mm)
JG-SHP4N	107	212	92
JG-SHP6N	165	200	100
JG-SHP12N	273	230	110
JG-SHP18N	381	230	110
JG-SHP24N	273	380	110



# DISTRIBUTION BOX

## WATERPROOF SWITCHES & SOCKETS

Model	Specification
JG-1WAY	1 Way Switch IP65
JG-1WAY	1 Way Socket IP65
JG-2 WAY	1 Way Switch With Socket IP65
JG-2 BELL	1 Way Bell Push



# INDUSTRIAL CABLE DRUM

Model	Specification
JG-QC2630	Industrial plastic cable reel QC2630 with 16A plug, there two socket and two plug
JG-QC2630	Industrial plastic cable reel QC2630 with 32A plug there two socket and two plug
JG-QC8630A	Industrial empty metal cable reel QC8630A with 16A plug theretwo socket and two plug
JG-QC8230A	Metal cable reel QC8230A wit25mtr H05VV-F 3*1.5sqm pure copper cable
JG-QC8250A	Metal cable reel QC8250A wit 50mtr.H05VV-F 3*1.5sqm pure copper cable
JG-QC8130A	Metal cable reel QC8130Awith 25mtr.H05VV-F 3*1.5sqm pure copper cable
JG-QC8150A	Metal cable reel QC8150A with50mt. H05VV-F 3*1.5sqm pure copper cable
JG-QC3130A-1	Metal cable reel QC3130A-1 with 25m H05VV-F 3*1.5sqm pure copper cable
JG-QC2130-S0	Plastic cable reel QC2130-S0 with 25m H05VV-F 3*1.5sqm pure copper cable
JG-QC2150-S0	Plastic cable reel QC2150-S0 with 50m H05VV-F 3*1.5sqm pure copper cable
JG-QC9130-0R	Plastic cable reel QC9130-0R with 25m H05VV-F 3*1.5sqm pure copper cable
JG-QC9150-0R	Plastic cable reel QC9150-0R with 50m H05VV-F 3*1.5sqm pure copper cable
JG-QC8640A	Industrial empty metal cable reel QC8640A with 32A there two socket and two plug



# CRIMPING TOOLS - INSULATED TERMINAL

## JG-HSC8 6-4

- Self-adjusts to the desired ferrule size
- Ferrule insertion on the side of the tool
- Multiple crimp profiles
- Burnished or chrome finish
- Specially hardened spring steel

Specification	JG-HSC8 6-4
Crimping capacity	0.25-6.0mm <sup>2</sup>
AWG	23-10AWG
Length	175mm
Weight	0.36Kg



## JG-HSC8 6-6

Specification	JG-HSC8 6-6
Crimping capacity	0.25-6.0mm <sup>2</sup>
AWG	23-10AWG
Length	175mm
Weight	0.36Kg

- Ferrule insertion on the side of the tool
- Self-adjusting adaptation to the desired end sleeve (ferrule) size, no wrong crimps caused by using the wrong die
- Fits all ferrules within the application range
- Chrome vanadium electric steel in special quality, oil-hardened



## JG-HS-06WF

Specification	JG-HS-06WF
Crimping capacity	0.25-6.0mm <sup>2</sup>
AWG	24-10AWG
Length	203mm
Weight	0.4Kg



## JG-HS-16WF

Specification	JG-HS-16WF
Crimping capacity	6.0-16.0mm <sup>2</sup>
AWG	10-6AWG
Length	203mm
Weight	0.4Kg

# CRIMPING TOOLS - NON-INSULATED TERMINAL

## JG-HS-16

Specification	JG-HS-16
Crimping capacity	1.25-16 mm <sup>2</sup>
AWG	17-5 AWG
Length	270mm
Weight	0.55Kg



## JG-HS-25

Specification	JG-HS-25
Crimping capacity	5.5-25 mm <sup>2</sup>
AWG	AWG
Length	354 mm
Weight	0.85 Kg

## JG-HS-38

Specification	JG-HS-38
Crimping capacity	5.5-38mm <sup>2</sup>
AWG	10-2AWG
Length	356mm
Weight	0.85Kg



Releasing device ensure safe operation



# CRIMPING TOOLS - FOR CABLE LUGS

- The crimping tools is used for non-welding and standard electrical connection.
- The mould of the crimping dies is made of SCM-40 hardest tool steel. It is with the characteristics of long life, accurate bore diameter and good crimping effect.



Item No.	Range of Application	Crimping Capacity		Length(mm)	Weight(kg)
		mm <sup>2</sup>	AWG		
JG-HX-50B	BS Standard type terminals	6-50	10-1	390	1.3kg
JG-HX-120B	BS Standard type terminals	10-120	8-4/0	620	4.0kg
JG-HX-150B	BS Standard type terminals	25-150	4-300MCM	620	4.0kg
JG-HX-245B	BS Standard type terminals	70-240	2/0	980	5.6kg



# CRIMPING TOOLS - FOR CABLE LUGS

## JG-YQK300

- It is applied to overhead distribution and press connection for copper terminals and sleeve of underground cable.
- Hexagonal mould is adopted to ensure tight press connection, good electric conduction and non-easy shedding.

Range of application	10-185mm <sup>2</sup> (Al Terminal) 16-300mm <sup>2</sup> (Cu Terminal)
Crimping force	8ton
Stroke	16mm
Standard	16,25,35,50,70,95,120,150,185,240,300mm <sup>2</sup>
Weight	6.4Kg
Packaging Size	755x130x230mm
Package	Plastic case



## JG-FYQ-400

Range of application	50-400mm <sup>2</sup>
Crimping force	16ton
Stroke	20mm
Standard	50,70,95,120,150,185,240,300 400mm <sup>2</sup>
Weight	9Kg
Packaging Size	355x90x155mm
Package	Steel case



# HEAVY DUTY CONNECTOR

## SPECIFICATIONS

**Model :** JG-HE-06-64

**Current :** 16A

**Voltage :** 500V

**Connector Pin Number :** 6,10, 16, 24, 32, 48, 63

**Connect a Pin Material :** Copper

**Surface Treatment :** Silver Plating

**Contact Resistance :** 1m or  $\Omega$

**Wiring Form :** Screw Link

**Wire Specification :** 0.5~4mm<sup>2</sup>

**Screw Torque:** 0.5 NM

**Wire Stripping Length :** 7-9mm

**Plug Number :** 500 or higher

**Working Temperature :** -40°C to +125°C

**Shell Materials :** Die casting aluminum alloy

**Color :** Grey

**Chain Mode :** metal roller, double buckle

**The Shell Surface:** High temperature power coating

**The Original Seal:** nitrile rubber

**Protection Grade :** IP65



# HEAVY DUTY CONNECTOR

## BOTTOM OPEN TYPE

Model	Specification
JG - HE004	4 Pin Rectangle Metal Plug & Socket Bottom Open
JG - HE006	Side Open 6 Pin Metal Plug & Socket Bottom Open
JG - HE010	Side Open 10 Pin Metal Plug & Socket Bottom Open
JG - HE016	Side Open 16 Pin Metal Plug & Socket Bottom Open
JG - HE024	Side Open 24 Pin Metal Plug & Socket Bottom Open
JG - HE032	Side Open 32 Pin Metal Plug & Socket Bottom Open
JG - HE048	Side Open 48 Pin Metal Plug & Socket Bottom Open
JG - HE064	Side Open 64 Pin Metal Plug & Socket Bottom Open



# HEAVY DUTY CONNECTOR

## BOTTOM CLOSE TYPE

Model	Specification
JG - HE006	Side Closed 6 Pin Metal Plug & Socket Bottom Closed
JG - HE010	Side Closed 10 Pin Metal Plug & Socket Bottom Closed
JG - HE016	Side Closed 16 Pin Metal Plug & Socket Bottom Closed
JG - HE024	Side Closed 24 Pin Metal Plug & Socket Bottom Closed
JG - HE032	Side Closed 32 Pin Metal Plug & Socket Bottom Closed
JG - HE048	Side Closed 48 Pin Metal Plug & Socket Bottom Closed



# HEAVY DUTY CONNECTOR

## ROUND CONNECTOR MILITARY COLOUR

Model	Specification
JG - P2002	20mm 2Pin Round Metal Connector - Military Color
JG - P2003	20mm 3Pin Round Metal Connector - Military Color
JG - P2004	20mm 4Pin Round Metal Connector - Military Color
JG - P2005	20mm 5Pin Round Metal Connector - Military Color
JG - P2007	20mm 7Pin Round Metal Connector - Military Color
JG - P2804	28mm 4Pin Round Metal Connector - Military Color
JG - P2807	28mm 7Pin Round Metal Connector - Military Color
JG - P3212	32mm 12Pin Round Metal Connector-Military Color
JG - P3214	32mm 14Pin Round Metal Connector-Military Color
JG - P4820	48mm 20Pin Round Metal Connector-Military Color
JG - P4826	48mm 26Pin Round Metal Connector-Military Color
JG - P5530	55mm 30Pin Round Metal Connector-Military Color
JG - P5535	55mm 35Pin Round Metal Connector-Military Color



## ROUND CONNECTOR STEEL COLOUR

Model	Specification
JG - TP2002	20mm 2Pin Round Metal Connector - Steel Color
JG - TP2003	20mm 3Pin Round Metal Connector - Steel Color
JG - TP2004	20mm 4Pin Round Metal Connector - Steel Color
JG - TP2007	20mm 7Pin Round Metal Connector - Steel Color
JG - TP2008	20mm 8Pin Round Metal Connector - Steel Color
JG - TP2010	20mm 10Pin Round Metal Connector - Steel Color
JG - TP2012	20mm 12Pin Round Metal Connector - Steel Color
JG - TP2808	28mm 8Pin Round Metal Connector - Steel Color
JG - TP2810	28mm 10Pin Round Metal Connector - Steel Color
JG - TP2812	28mm 12Pin Round Metal Connector - Steel Color
JG - TP2816	28mm 16Pin Round Metal Connector - Steel Color

