



REV.NO.01

Jainson
CABLE GLAND

We take great pleasure in presenting our New Millennium detailed technical Catalogue on BRASS CABLE GLANDS. The catalogue is useful to Designers, Engineers & the ultimate user.

ABOUT US:

JAINSON being at the forefront in manufacture & supply of CABLE TERMINAL ENDS, CRIMPING TOOLS, & various allied products has, as a new venture diversified into manufacturing BRASS CABLE GLANDS. The year for specialization backed by Infrastructure & the Engineering expertise the group has at its disposal, helped immensely in establishing ourselves as an better alternative in a very short span.

JAINSON Cable Glands conforms to BS 6121 & IS 12943. Cable Glands are manufactured from standard Brass material we have a well equipped In - House foundry casting facility. The rigid quality control measure ensures that we offer a world class product to the market in true sense of the word.

Jainson CABLE GLAND ACCESSORIES

Brass Earth Tags are used to ensure that earth continuity is maintained between the gland and the equipment

EARTH TAG



PVC SHROUD

PVC Shrouds are used for fitting over cable glands, where additional protection against extreme Climatic conditions & corrosion is required.

Shrouds & Earth Tags are supplied separately at extra coast & should be specified when ordering the gland.

Jainson SINGLE COMPRESSION TYPE HEAVY DUTY CABLE GLANDS

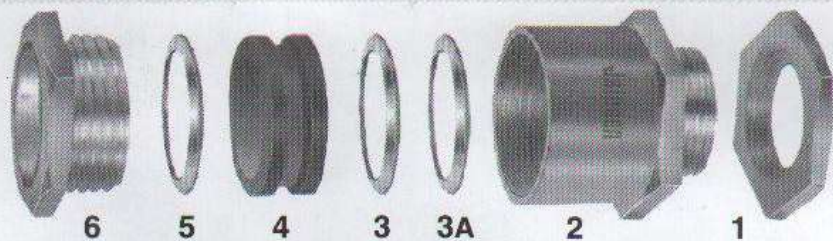

- **THREADS:** BSC(ET)
- **MATERIAL :** BRASS
- **FINISH :** NICKLE PLATED

APPLICATION : These Cable Glands can be used in extreme climatic conditions as they are weatherproof and may be used in corrosive condition when protected by a shroud.

SPECIFICATION : Gland consists of 1) Check Nut 2) Gland Body 3) Metal Washers (2Nos.) 4) Outer Seal Rubbers 5) Metal Washers (1Nos.) 6) Compression Nut. (Gland Bush)

All Metal part (metal washers are M.S.) are made of brass accurately machined for ease of assembly.

FITTING SEQUENCE :

- a) Screw item 2 into apparatus (secure with item 1 if plain hole entry.)
- b) Pass item 6,5,4 and 3 over cable before commencing to strip oversheath.
- c) Remove the outer sheath to the desired length depending on the lengths of leads required.
- d) Pass item 3 over the cable and splay out the armour wire one by one and then cut the armour wires according to the size of washer. Insert the 3A metal washer over inner sheath of cable so that bend armours are secured between the metal washer and gland body.
- e) Push the cable through item 2 and engage the item 6 with item 2 and tighten up while doing, so the grooved rubber ring will contract in radial direction and will grip the outer sheath of cable.

Jainson FLANGE TYPE CABLE GLANDS

- **THREADS:** BSC(ET)
- **MATERIAL:** BRASS
- **FINISH:** NATURAL

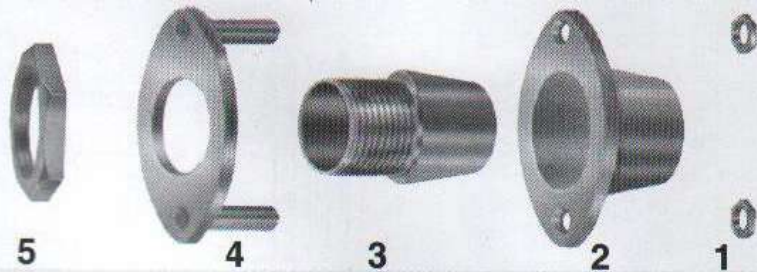

APPLICATION : Flange type glands are mainly used for armour cable which is very much easy & comfortable in fitting & gives strong grip to hold the cable.

All the Electricity Board & Reputed Firms are using this type of cable glands.

SPECIFICATION : Gland consists of 1) Small MS Nut 2) Gland Body 3) Centre Part 4) Strip with Nut and Bolt 5) Check Nut

FITTING SEQUENCE :

- a) Remove oversheath and pass item 2 cover exposed armour.
- b) Cut armour to length, lift wire ends, pass item 3 cover exposed bedding and beneath armour.
- c) Push the cable through item 4 & 5 and engage the item 1 with item 2, 3, & 4 and tighten up.
- d) Screw item 3 into apparatus (secure with item 5 if plain hole entry.)

Jainson DOUBLE COMPRESSION TYPE WEATHER PROOF CABLE GLANDS

- **THREADS:** BSC(ET)
- **MATERIAL:** BRASS
- **FINISH:** NICKLE PLATED

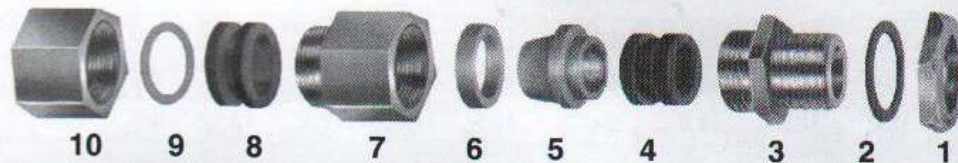

APPLICATION : For use under most climatic conditions. These are weather proof and may be used in corrosive conditions when protected by a shroud.

SPECIFICATION : Gland consists of 1) Check Nut 2) Neoprene Flat Washer 3) Gland Nipple 4) Neoprene Inner Ring 5) Armour Clamping Cone 6) Armour Clamping Ring 7) Armour Clamping Nut (Gland body) 8) Neoprene Outer Ring 9) L.D. Washer 10) Outer Seal Nut (Gland bush)

FITTING SEQUENCE :

- a) Screw item 3 into apparatus (secure with item 1 & 2 if plain hole entry.)
- b) Pass item 10, 9, 8 and 7 respectively over cable before commencing to strip oversheath.
- c) Remove oversheath and pass item 6 cover exposed armour.
- d) Cut armour to length, lift wire ends, pass item 5 cover exposed bedding and beneath armour.
- e) Pass item 4 cover exposed bedding f) Pass cable and through item 3.
- g) Engage item 7 and 3 and tighten up. h) Engage item 10 and 7 and tighten up.

HOW TO ORDER

- 1] Specify the cable make, size & the O.D. If available.
- 2] Specify JAINSON Catalogue No.
- 3] Specify the required threads.
- 4] If you have special requirements of Brass Cable Glands, which you are not able to locate in our Catalogue then kindly let us have either samples or Drawing.

Jainson SINGLE COMPRESSION SIEMENS TYPE BRASS CABLE GLAND

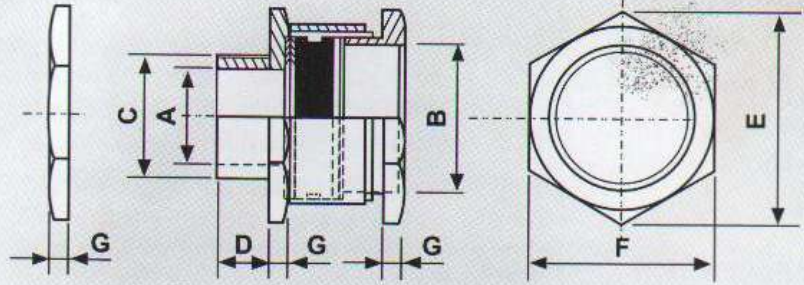

ALL DIMENSIONS ARE IN mm TOLERANCE (± 1 mm) MATERIAL : BRASS FINESH : NICKEL THREADS: BSC(ET)

SR No.	Max. O. D.	Cable Dimn. Overall Dia.		Nipple Entry Thread		Cable Gland Dimensions							Jainson Cat. No.
		Over	Under	Inch.	mm	A	B	C	D	E	F	G	
1	14.0	12.0	10.0	3/8"	10.0	12.0	12.5	15.5	7.0	20.5	18.0	2.0	JC - 3/8"
2	16.0	15.0	10.0	1/2"	12.0	13.0	16.0	15.5	7.0	23.5	20.5	2.0	JC - 1/2" L
3	16.0	15.0	10.0	1/2"	12.0	12.5	15.5	15.5	8.0	23.5	20.5	2.5	JC - 1/2" M
4	16.0	15.0	10.0	1/2"	12.0	12.5	15.5	15.5	8.5	24.0	21.5	3.0	JC - 1/2" H
5	16.0	16.0	10.0	5/8"	16.0	15.0	16.5	18.5	7.0	23.5	20.5	2.5	JC - 5/8" L
6	16.0	16.0	10.0	5/8"	16.0	14.5	15.5	18.5	8.0	23.5	20.5	2.5	JC - 5/8" M
7	16.0	16.0	10.0	5/8"	16.0	14.5	15.5	18.5	8.5	24.0	21.5	3.0	JC - 5/8" H
8	18.0	16.5	14.0	3/4"	19.0	15.5	17.5	18.5	7.5	26.0	22.5	2.5	JC - 3/4" L
9	18.0	16.5	14.0	3/4"	19.0	15.0	17.5	18.5	8.5	26.5	23.0	2.5	JC - 3/4" M
10	18.0	16.5	14.0	3/4"	19.0	15.0	17.5	18.5	9.0	27.5	24.0	3.0	JC - 3/4" H
11	20.0	17.5	16.5	7/8"	22.0	15.0	20.0	18.5	7.5	28.5	25.0	2.5	JC - 7/8" L
12	20.0	17.5	16.5	7/8"	22.0	14.5	20.0	18.5	8.5	28.5	25.0	2.5	JC - 7/8" M
13	20.0	17.5	16.5	7/8"	22.0	14.5	20.0	18.5	9.0	29.5	26.0	3.0	JC - 7/8" H
14	23.0	20.5	18.5	1"	25.0	21.5	23.5	25.0	8.0	33.0	29.0	2.5	JC - 1" L
15	23.0	20.5	18.5	1"	25.0	21.0	23.0	25.0	9.0	33.0	29.0	3.0	JC - 1" M
16	23.0	20.5	18.5	1"	25.0	21.0	23.0	25.0	10.0	34.5	30.0	3.5	JC - 1" H
17	23.0	20.5	18.5	1"	25.0	21.0	24.0	25.0	14.0	35.0	30.5	3.5	JC - 1" SP
18	30.0	27.5	22.5	1-1/8"	28.0	24.5	28.0	28.0	10.5	40.5	35.0	3.5	JC - 1-1/8"
19	30.0	27.5	22.5	1-1/8"	28.0	25.0	28.0	28.0	9.0	38.5	33.5	3.0	JC - 1-1/8" L
20	30.0	27.5	26.5	1-1/4"	32.0	27.0	32.0	31.5	11.0	46.0	40.0	3.5	JC - 1-1/4"
21	30.0	27.5	26.5	1-1/4"	32.0	27.5	32.0	31.5	9.5	43.0	37.5	3.0	JC - 1-1/4" L
22	33.0	33.0	29.5	1-3/8"	35.0	29.5	35.5	34.5	11.0	49.0	43.0	4.0	JC - 1.3/8"
23	33.0	33.0	29.5	1-3/8"	35.0	30.0	35.5	34.5	10.0	47.5	41.5	3.5	JC - 1-3/8" L
24	38.0	37.0	33.5	1-1/2"	38.0	33.0	39.5	38.0	11.5	54.0	47.0	4.5	JC - 1-1/2"
25	38.0	37.0	33.5	1-1/2"	38.0	33.5	39.5	37.5	10.5	52.0	45.5	4.0	JC - 1-1/2" L

Jainson SINGLE COMPRESSION SIEMENS TYPE BRASS CABLE GLAND

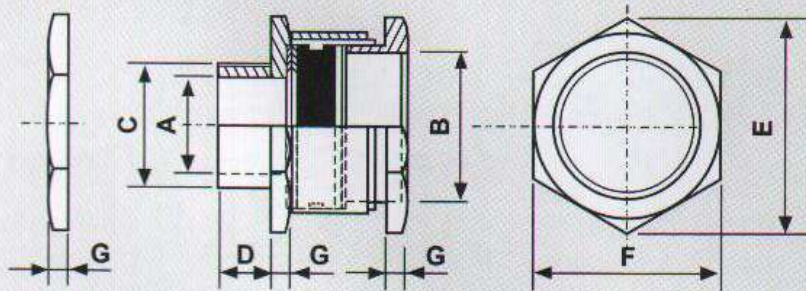

ALL DIMENSIONS ARE IN mm TOLERANCE (1mm) MATERIAL : BRASS FINESH : NICKEL THREADS: BSC(ET)

SR No.	Max. O. D.	Cable Dimn. Overall Dia.		Nipple Entry Thread	mm	Cable Gland Dimensions							Jainson Cat. No.
		Over	Under			A	B	C	D	E	F	G	
26	45.0	40.0	37.5	1-3/4"	45.0	40.0	44.5	44.5	11.5	61.0	53.0	4.5	JC - 1-3/4"
27	45.0	40.0	37.5	1-3/4"	45.0	40.5	44.5	44.0	10.5	59.5	51.5	4.0	JC - 1-3/4"L
28	49.0	48.0	43.5	2"	50.0	45.0	51.5	50.0	13.0	69.0	60.5	5.0	JC - 2"
29	49.0	48.0	43.5	2"	50.0	45.5	51.5	49.5	11.5	67.5	58.5	4.5	JC - 2"L
30	55.0	52.0	49.0	2-1/4"	57.0	51.5	58.0	57.0	13.0	78.0	68.0	5.0	JC - 2-1/4"
31	55.0	52.0	49.0	2-1/4"	57.0	52.0	58.0	56.5	11.5	76.0	66.0	4.5	JC - 2-1/4"L
32	61.0	56.0	54.5	2-1/2"	63.0	57.5	62.5	63.0	14.0	82.0	72.0	5.0	JC - 2-1/2"
33	61.0	56.0	54.5	2-1/2"	63.0	58.0	62.5	62.5	12.5	81.0	70.5	4.5	JC - 2-1/2"L
34	67.0	67.0	61.5	2-3/4"	70.0	63.5	69.0	69.0	15.0	91.0	79.0	5.5	JC - 2-3/4"
35	67.0	67.0	61.5	2-3/4"	70.0	64.0	69.0	68.5	13.5	90.0	78.0	5.0	JC - 2-3/4"L
36	73.0	73.0	66.5	3"	75.0	68.0	75.0	75.0	16.0	99.0	86.0	5.5	JC - 3"
37	73.0	73.0	66.5	3"	75.0	68.5	75.0	74.5	14.0	96.0	84.5	5.0	JC - 3"L
38	80.0	74.0	72.5	3-1/4"	82.0	75.0	81.5	82.0	16.0	105.0	92.0	6.0	JC - 3-1/4"
39	80.0	74.0	72.0	3-1/4"	82.0	75.5	82.0	81.5	14.0	104.0	90.5	5.5	JC - 3-1/4"L
40	83.0	83.0	80.5	3-1/2"	88.0	81.5	86.0	88.0	16.0	116.0	101.0	6.0	JC - 3-1/2"
41	83.0	83.0	80.5	3-1/2"	88.0	82.0	86.5	87.5	14.0	114.0	98.5	5.5	JC - 3-1/2"L
42	95.0	95.0	84.0	4"	100.0	92.0	101.0	100.0	17.0	126.0	110.0	6.5	JC - 4"
43	105.0	108.0	100.0	4-1/2"	115.0	107.0	108.0	115.0	20.0	147.0	129.0	7.5	JC - 4-1/2"L

Jainson FLANGE TYPE BRASS CABLE GLAND

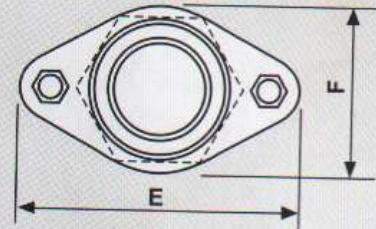
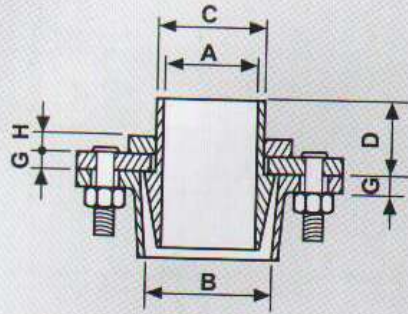

ALL DIMENSIONS ARE IN mm TOLERANCE (± 1 mm) MATERIAL : BRASS FINISH : NATURAL THREADS: BSC(ET)

SR No.	Max. O. D.	Cable Dimn. Overall Dia.		Nipple Entry Thread Inch.	mm	Cable Gland Dimensions				Dimensions				Jainson Cat. No.
		Over	Under			A	B	C	D	E	F	G	H	
44	16.5	16.0	10.0	5/8"	16	12.5	17.0	15.5	13.0	45.0	28.0	2.5	3.0	JF 5
45	19.0	19.0	10.5	3/4"	19	15.0	20.0	18.5	14.0	54.0	29.0	2.5	3.0	JF 4
46	20.5	20.0	13.5	3/4"	22	16.0	21.0	19.5	15.0	55.0	30.0	2.5	3.0	JF 3
47	25.5	25.0	20.0	1"	25	21.0	26.0	25.0	16.0	60.0	36.5	2.5	3.0	JF 2
48	29.5	28.0	23.0	1-1/8"	28	24.0	29.0	28.0	17.0	64.0	41.0	3.0	4.0	JF 1SP
49	31.5	31.0	26.0	1-1/4"	32	27.0	32.0	31.5	17.0	65.0	43.0	3.0	4.0	JF 1
50	35.0	34.0	30.0	1-3/8"	35	31.5	35.5	35.0	17.0	74.0	50.0	3.5	4.5	JF 11
51	36.0	35.0	30.0	1-1/2"	38	33.5	37.5	37.5	20.0	76.0	51.5	3.5	4.5	JF 0
52	39.0	37.0	30.0	1-1/2"	38	33.5	40.0	38.0	20.0	77.0	52.0	3.5	4.5	JF 00
53	42.0	41.0	35.0	1-3/4"	45	37.5	43.0	41.0	18.0	84.0	56.0	3.5	4.5	JF 38
54	49.0	48.0	40.0	1-3/4"	45	43.0	49.5	46.0	20.0	92.0	66.0	4.0	5.0	JF 001
55	53.0	52.0	47.0	2"	50	49.0	53.5	53.0	20.5	96.0	68.5	4.0	5.0	JF 002
56	60.0	59.0	54.0	2-1/4"	57	56.0	61.0	59.5	22.0	106.0	78.0	4.0	5.0	JF 003
57	65.0	64.0	58.0	2-1/2"	63	60.5	65.0	65.0	22.0	114.0	81.5	4.0	5.0	JF 0033
58	75.0	74.0	68.0	3"	75	69.5	75.5	75.0	22.0	135.0	95.5	4.5	5.5	JF 004
59	95.0	94.0	90.0	4"	100	92.5	96.5	98.5	25.0	158.0	114.0	5.5	6.5	JF 005

Jainson DOUBLE COMPRESSION FLAME PROOF TYPE BRASS CABLE GLAND (LIGHT DUTY)

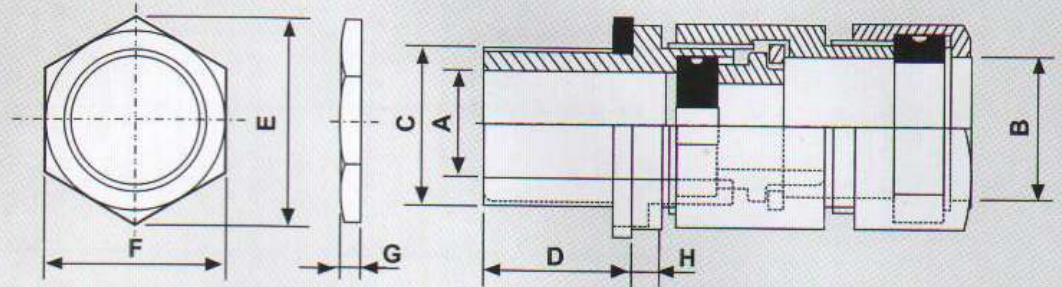

ALL DIMENSIONS ARE IN mm TOLERANCE (± 1 mm) MATERIAL : BRASS FINESH : NICKEL THREADS: BSC(ET)

SR No.	Max. O. D.	Cable Dimn. Overall Dia.		Nipple Entry Thread Inch.	mm	Cable Gland Dimensions								Jainson Cat. No.
		Over	Under			A	B	C	D	E	F	G	H	
60	12.0	12.0	9.0	3/8"	10	12.0	12.5	15.5	25.0	23.0	20.5	2.5	3.0	JPFL - 3/8"
61	15.0	14.0	10.0	1/2"	12	11.0	15.5	16.0	25.0	25.0	22.0	3.0	3.5	JPFL - 1/2 "
62	16.0	15.5	11.5	5/8"	16	14.0	17.0	19.0	25.0	27.0	23.5	3.0	3.5	JPFL - 5/8"
63	17.0	16.0	12.0	3/4"	19	14.5	17.5	19.0	25.0	27.5	24.0	3.0	3.5	JPFL - 3/4"
64	19.0	18.0	14.0	7/8"	22	15.0	20.0	19.0	25.0	31.0	27.0	3.0	3.5	JPFL - 7/8"
65	23.0	23.0	20.0	1"	25	20.5	24.0	25.0	25.0	36.0	31.5	3.5	4.0	JPFL - 1"
66	26.0	26.0	21.0	1-1/8"	28	22.5	27.5	28.0	25.0	39.0	34.0	4.0	5.0	JPFL - 1-1/8"
67	30.0	30.0	24.0	1-1/4"	32	26.0	31.5	32.0	25.0	46.0	40.0	4.5	5.5	JPFL - 1-1/4"
68	33.0	33.0	28.5	1-3/8"	35	29.0	34.0	35.0	25.0	50.0	43.0	4.5	5.5	JPFL - 1-3/8"
69	37.0	37.0	31.0	1-1/2"	38	32.0	38.0	38.0	25.0	54.0	47.0	4.5	5.5	JPFL - 1-1/2"
70	44.0	44.0	39.0	1-3/4"	45	42.5	45.0	50.0	25.0	64.0	56.0	5.0	6.0	JPFL - 1-3/4"
71	49.0	49.0	42.0	2"	50	43.0	50.0	50.0	25.0	67.0	59.0	5.0	6.0	JPFL - 2"
72	55.0	54.0	49.0	2-1/4"	57	50.5	56.0	57.0	25.0	76.5	66.5	5.0	6.0	JPFL - 2-1/4"
73	63.0	62.5	54.0	2-1/2"	63	55.0	63.5	63.0	25.0	88.0	78.0	5.5	6.5	JPFL - 2-1/2"
74	70.0	68.0	61.5	2-3/4"	70	62.0	71.0	69.0	25.0	94.0	82.0	5.5	6.5	JPFL - 2-3/4"
75	74.0	73.0	66.0	3"	75	66.5	75.0	74.0	25.0	100.0	87.5	5.5	6.5	JPFL - 3"
76	78.0	78.0	71.0	3-1/4"	82	73.0	79.0	82.0	25.0	105.0	91.5	6.5	7.5	JPFL - 3-1/4"
77	85.0	85.0	76.0	3-1/2"	88	78.0	86.0	88.0	26.0	120.0	103.5	6.5	7.5	JPFL - 3-1/2"
78	89.0	89.0	85.0	4"	100	89.0	90.0	100.0	26.0	130.0	114.0	7.0	8.0	JPFL - 4"

Jainson SINGLE COMPRESSION SIEMENS TYPE HEAVY DUTY (SIBG) BRASS CABLE GLAND

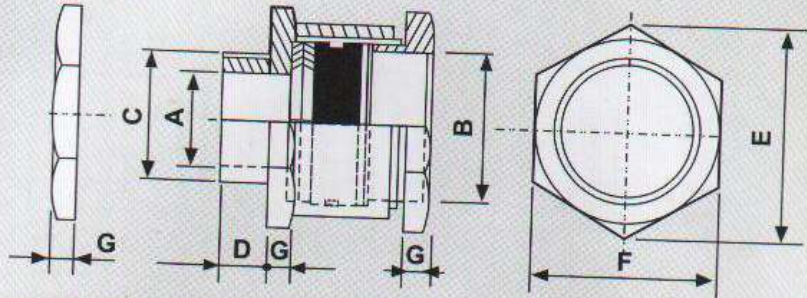

ALL DIMENSIONS ARE IN mm

TOLERANCE (± 1 mm)

MATERIAL : BRASS FINISH : NICKEL THREADS : BSC(ET)

SR No.	Max. O. D.	Cable Dimn. Overall Dia.		Nipple Entry Thread	Inch.	mm	Cable Gland Dimensions						Jainson Cat. No.
		Over	Under				A	B	C	D	E	F	
79	14.0	12.0	9.0	1/2"	12	9.5	15.0	12.0	9.0	23.0	20.5	3.0	1612
80	16.5	16.0	9.0	5/8"	16	12.0	18.5	16.0	9.0	29.0	25.0	3.0	1616
81	17.5	16.0	10.0	3/4"	19	14.5	18.5	19.0	9.0	29.0	25.0	3.0	1619
82	20.5	20.0	14.0	3/4"	19	15.0	24.0	19.0	9.5	34.5	30.0	3.5	2119
83	22.5	20.0	14.0	1"	25	20.5	24.0	25.0	9.5	35.5	31.0	3.5	2125
84	25.5	26.0	20.0	1"	25	20.5	33.0	25.0	10.0	46.0	40.0	4.0	2925
85	27.0	29.0	24.0	1-1/4"	32	27.0	33.0	32.0	10.0	46.0	40.0	4.0	2932
86	30.0	29.0	24.0	1-1/2"	38	32.0	33.0	38.0	10.0	46.0	40.0	4.0	2938
87	38.0	37.0	31.0	1-1/2"	38	32.0	41.0	38.0	11.0	57.0	51.0	4.5	3638
88	45.0	45.0	42.0	2"	50	44.5	47.0	50.5	11.5	68.0	60.0	5.0	4251
89	50.0	50.0	44.0	2"	50	44.5	55.5	50.5	12.0	77.5	67.5	6.0	5451
90	53.0	50.0	44.0	2-1/2"	63	54.5	56.0	63.0	12.0	78.0	68.0	6.0	5463
91	62.0	60.0	54.0	2-1/2"	63	55.0	64.0	63.0	12.0	89.0	78.0	6.0	6063
92	67.0	66.0	60.0	3"	75	65.5	67.5	75.0	13.0	96.0	84.0	7.0	6675
93	79.0	77.0	70.0	3-1/4"	82	72.5	82.5	82.0	14.5	112.0	99.0	7.0	7882
94	90.0	84.0	79.0	3-1/2"	90	81.0	91.0	90.0	19.0	124.0	108.0	8.0	8490

Jainson SINGLE COMPRESSION SIEMENS TYPE LONG NIPPLE BRASS CABLE GLAND

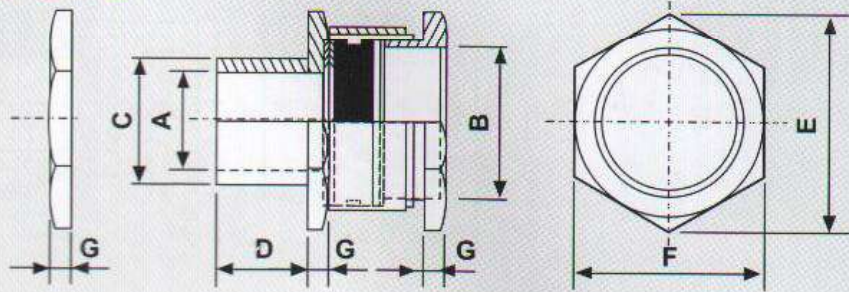

ALL DIMENSIONS ARE IN mm TOLERANCE ($\pm 1\text{mm}$) MATERIAL : BRASS FINISH : NICKEL THREADS: BSC(ET)

SR No.	Max. O. D.	Cable Dimn. Overall Dia.		Nipple Entry Thread Inch.	mm	Cable Gland Dimensions							Jainson Cat. No.
		Over	Under			A	B	C	D	E	F	G	
95	16.0	14.0	10.0	1/2"	12	12.5	15.5	15.5	12.0	23.5	20.5	2.5	JC 1/2" L.N.
96	16.0	14.0	10.0	5/8"	16	14.5	15.5	18.5	12.0	23.5	20.5	2.5	JC 5/8" L.N.
97	18.0	16.5	14.0	3/4"	19	14.5	17.5	19.0	13.0	26.0	23.0	2.5	JC 3/4" L.N.
98	20.0	18.0	16.5	7/8"	22	14.5	20.0	19.0	14.0	29.0	25.5	3.0	JC 7/8" L.N.
99	23.0	22.0	18.5	1"	25	20.5	23.0	25.0	15.0	33.0	29.0	3.0	JC 1" L.N.
100	25.0	22.0	18.5	1"	25	21.0	24.0	25.0	18.0	35.5	31.0	3.5	JC 1" SPL.N.
101	25.5	26.0	22.5	1-1/8"	28	24.0	28.0	28.0	20.0	40.5	35.0	3.5	JC 1-1/8" L.N.
102	30.0	29.0	26.5	1-1/4"	32	27.0	32.0	31.5	20.0	46.0	40.0	3.5	JC 1-1/4" L.N.
103	33.0	33.5	29.5	1-3/8"	35	29.5	35.5	34.5	20.0	49.0	43.0	4.0	JC 1-3/8" L.N.
104	38.0	37.0	33.5	1-1/2"	38	33.0	39.5	38.0	20.0	54.0	47.0	4.0	JC 1-1/2" L.N.
105	45.0	43.0	37.5	1-3/4"	45	40.0	44.5	44.5	20.0	61.0	53.0	4.5	JC 1-3/4" L.N.
106	49.0	49.0	43.5	2"	50	45.0	51.5	50.0	20.0	69.0	60.5	5.0	JC 2" L.N.

Jainson DOUBLE COMPRESSION WEATHER PROOF BRASS CABLE GLAND (HEAVY DUTY)

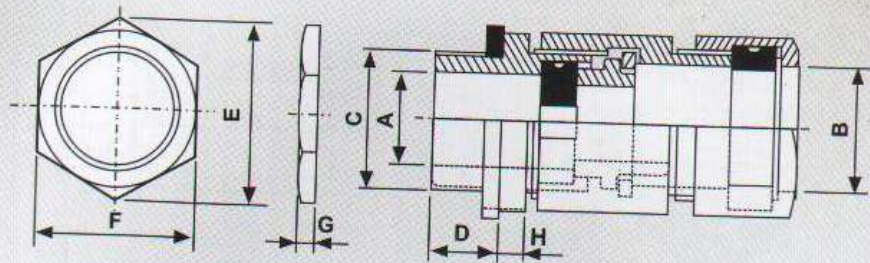

ALL DIMENSIONS ARE IN mm TOLERANCE (± 1 mm) MATERIAL : BRASS FINISH : NICKEL THREADS: BSC(ET)

SR No.	Max. O. D.	Cable Dimn. Overall Dia.		Nipple Entry Thread Inch.	mm	Cable Gland Dimensions								Jainson Cat. No.
		Over	Under			A	B	C	D	E	F	G	H	
107	14.0	14.0	8.0	3/4"	19.0	12.5	15.0	18.5	14.0	24.0	21.0	3.0	3.5	JPW - 001
108	15.5	15.0	10.5	3/4"	19.0	13.5	16.5	19.0	15.0	29.0	25.0	3.5	4.0	JPW - 01S
109	19.0	18.5	13.5	3/4"	19.0	13.5	20.0	19.0	15.0	31.5	27.5	3.5	4.0	JPW - 01
110	19.5	18.5	13.5	1"	25.0	14.0	20.5	25.0	15.0	32.0	28.0	3.5	4.0	JPW - 01A
111	20.0	20.0	14.0	1"	25.0	18.0	21.0	25.0	15.0	36.0	31.0	4.0	4.5	JPW - 02
112	20.0	20.0	14.0	3/4"	19.0	14.0	21.5	19.0	15.0	36.0	31.0	4.0	4.5	JPW - 02A
113	23.0	23.0	17.0	1"	25.0	19.0	24.0	25.0	15.0	36.5	37.5	4.0	4.5	JPW - 03
114	26.5	26.0	20.0	1"	25.0	20.0	27.5	25.0	15.0	43.0	37.5	4.5	5.0	JPW - 04
115	26.5	26.0	20.0	1-1/4"	32.0	20.5	27.5	32.0	15.0	44.0	38.0	4.5	5.0	JPW - 04A
116	30.0	30.0	24.0	1-1/4"	32.0	25.0	31.0	32.0	15.0	47.0	41.0	4.5	5.0	JPW - 05
117	30.0	30.0	24.0	1-1/2"	38.0	25.5	31.0	38.0	15.0	47.0	41.0	4.5	5.0	JPW - 05A
118	33.0	33.0	27.0	1-1/2"	38.0	31.0	34.0	38.0	15.0	54.0	47.0	5.0	6.0	JPW - 06
119	33.0	33.0	27.0	1-1/4"	32.0	25.0	34.0	32.0	15.0	54.0	47.0	5.0	6.0	JPW - 06A
120	37.0	37.0	30.0	1-1/2"	38.0	31.0	38.0	38.0	15.0	59.0	51.0	5.0	6.0	JPW - 07
121	41.0	41.0	35.0	2"	50.0	38.5	42.5	50.0	15.0	64.0	56.0	5.5	6.5	JPW - 08
122	46.0	46.0	40.0	2"	50.0	40.0	47.0	50.0	15.0	67.5	58.5	5.5	6.5	JPW - 09
123	52.0	52.0	46.0	2"	50.0	44.0	53.0	50.0	20.0	77.0	67.0	5.5	6.5	JPW - 010
124	52.0	52.0	46.0	2-1/2"	63.0	45.0	53.0	63.0	20.0	78.0	67.5	5.5	6.5	JPW - 010A
125	60.0	60.0	54.0	2-1/2"	63.0	56.0	61.0	63.0	20.0	92.0	80.0	6.0	7.0	JPW - 011
126	67.0	67.0	60.0	3"	75.0	63.0	68.0	75.0	20.0	98.0	85.0	7.0	8.0	JPW - 012
127	78.0	78.0	72.0	3-1/4"	82.0	74.0	79.0	82.0	20.0	113.0	98.0	7.5	8.5	JPW - 013
128	78.0	72.0	66.0	3"	75.0	68.0	79.0	75.0	20.0	113.0	98.0	7.5	8.5	JPW - 013A
129	84.0	84.0	78.0	3-1/2"	88.0	78.0	85.0	88.0	20.0	121.0	105.0	7.5	8.5	JPW - 014
130	95.0	94.0	88.0	4"	100.0	90.0	96.0	100.0	20.0	134.0	117.0	8.5	9.5	JPW - 015
131	106.0	105.0	98.0	4-1/2"	112.0	102.0	107.0	112.0	20.0	146.0	128.0	9.0	10.0	JPW - 016
132	106.0	105.0	88.0	4"	110.0	90.0	107.0	110.0	20.0	146.0	128.0	9.0	10.0	JPW - 017

Jainson DOUBLE COMPRESSION FLAME PROOF BRASS CABLE GLAND (HEAVY DUTY)

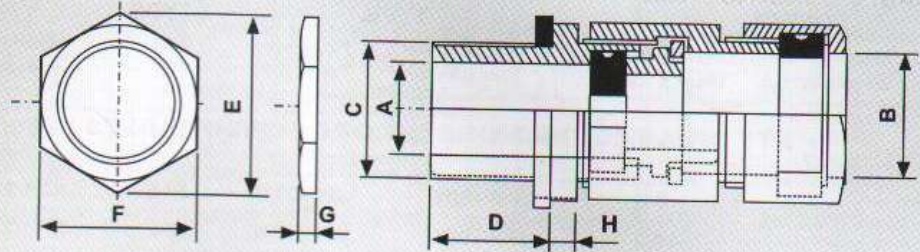

ALL DIMENSIONS ARE IN mm TOLERANCE (± 1 mm) MATERIAL : BRASS FINISH : NICKEL THREADS: BSC(ET)

SR No.	Max. O. D.	Cable Dimn. Overall Dia.		Nipple Entry Thread		A	Cable Gland Dimensions							Jainson Cat. No.
		Over	Under	Inch.	mm		B	C	D	E	F	G	H	
133	15.5	15.0	10.5	3/4"	19.0	13.5	16.5	19.0	25.0	29.0	25.0	3.5	4.0	JPF - 01S
134	19.0	18.5	13.5	3/4"	19.0	13.5	20.0	19.0	25.0	31.5	27.5	3.5	4.0	JPF - 01
135	19.5	18.5	13.5	1"	25.0	14.0	20.5	25.0	25.0	32.0	28.0	3.5	4.0	JPF - 01A
136	20.0	20.0	14.0	1"	25.0	18.0	21.0	25.0	25.0	36.0	31.0	4.0	4.5	JPF - 02
137	20.0	20.0	14.0	3/4"	19.0	14.0	21.5	19.0	25.0	36.0	31.0	4.0	4.5	JPF - 02A
138	23.0	23.0	17.0	1"	25.0	19.0	24.0	25.0	25.0	36.5	31.5	4.0	4.5	JPF - 03
139	26.5	26.0	20.0	1"	25.0	20.0	27.5	25.0	25.0	43.0	37.5	4.5	5.0	JPF - 04
140	26.5	26.0	20.0	1-1/4"	32.0	20.5	27.5	32.0	25.0	44.0	38.0	4.5	5.0	JPF - 04A
141	30.0	30.0	24.0	1-1/4"	32.0	25.0	31.0	32.0	25.0	47.0	41.0	4.5	5.0	JPF - 05
142	30.0	30.0	24.0	1-1/2"	38.0	25.5	31.0	38.0	25.0	47.0	41.0	4.5	5.0	JPF - 05A
143	33.0	33.0	27.0	1-1/2"	38.0	31.0	34.0	38.0	25.0	54.0	47.0	5.0	6.0	JPF - 06
144	33.0	33.0	27.0	1-1/4"	32.0	25.0	34.0	32.0	25.0	54.0	47.0	5.0	6.0	JPF - 06A
145	37.0	37.0	30.0	1-1/2"	38.0	31.0	38.0	38.0	25.0	59.0	51.0	5.0	6.0	JPF - 07
146	41.0	41.0	35.0	2"	50.0	38.5	42.5	50.0	25.0	64.0	56.0	5.5	6.5	JPF - 08
147	46.0	46.0	40.0	2"	50.0	40.0	47.0	50.0	25.0	67.5	58.5	5.5	6.5	JPF - 09
148	52.0	52.0	46.0	2"	50.0	44.0	53.0	50.0	25.0	77.0	67.0	5.5	6.5	JPF - 010
149	52.0	52.0	46.0	2-1/2"	63.0	45.0	53.0	63.0	25.0	78.0	67.5	5.5	6.5	JPF - 010A
150	60.0	60.0	54.0	2-1/2"	63.0	56.0	61.0	63.0	25.0	92.0	80.0	6.0	7.0	JPF - 011
151	67.0	67.0	60.0	3"	75.0	63.0	68.0	75.0	25.0	98.0	85.0	7.0	8.0	JPF - 012
152	78.0	78.0	72.0	3-1/4"	82.0	74.0	79.0	82.0	25.0	113.0	98.0	7.5	8.5	JPF - 013
153	78.0	72.0	66.0	3"	75.0	68.0	79.0	75.0	25.0	113.0	98.0	7.5	8.5	JPF - 013A
154	84.0	84.0	78.0	3-1/2"	88.0	78.0	85.0	88.0	25.0	121.0	105.0	7.5	8.5	JPF - 014
155	95.0	94.0	88.0	4"	100.0	90.0	96.0	100.0	25.0	134.0	117.0	8.5	9.5	JPF - 015
156	106.0	105.0	98.0	4-1/2"	112.0	102.0	107.0	112.0	25.0	146.0	128.0	9.0	10.0	JPF - 016

Jainson CABLE GLAND SELECTION CHART

CABLE CONSTRUCTION DETAIL			DOUBLE COMPRESSION TYPE		FLANGE TYPE	SINGLE COMPRESSION TYPE		
Core Size sq.mm	Armoured Overall Dia mm(Approx)	Unarmoured Overall Dia mm(Approx)	Weatherproof Type (JPW)	Flameproof Type (JPF)	Type (JF)	Siemens Type (JC)	Heavy Duty Type (SIBG)	Rubber Ref. No.

AYY (UNARMOURED SINGLE CORE POWER CABLES) 650/1100 V

1x4	--	9.5	JPW-001	JPF-01 S	JF-5	JC-1/2"	1616	1609
1x6	--	10.0	JPW-001	JPF-01 S	JF-5	JC-1/2"	1616	1611
1x10	--	11.0	JPW-001	JPF-01 S	JF-5	JC-5/8"	1619	1611
1x16	--	12.5	JPW-001	JPF-01 S	JF-5	JC-5/8"	1619	1613
1x25	--	14.0	JPW-001	JPF-01 S	JF-5	JC-3/4"	1619	1613
1x35	--	15.0	JPW-01 S	JPF-01 S	JF-5	JC-3/4"	1619	1615
1x50	--	16.5	JPW-01 S	JPF-01 S	JF-4	JC-3/4"	1619	1615
1x70	--	19.0	JPW-01	JPF-01	JF-3	JC-1"	2125	2118
1x95	--	21.0	JPW-02	JPF-02	JF-2	JC-1-1/8"	2125	2120
1x120	--	23.0	JPW-03	JPF-03	JF-2	JC-1-1/8"	2925	2923
1x150	--	24.5	JPW-04	JPF-04	JF-1	JC-1-1/4"	2925,2932	2925
1x185	--	27.0	JPW-04	JPF-04	JF-1	JC-1-1/4"	2925,2932	2927
1x225	--	29.5	JPW-05	JPF-05	JF-11	JC-1-3/8"	2932,2938	2929
1x240	--	32.0	JPW-06	JPF-06	JF-11	JC-1-1/2"	3638	3633
1x300	--	39.0	JPW-07	JPF-07	JF-00	JC-1-3/4"	3638	3637
1x400	--	39.0	JPW-08	JPF-08	JF-38	JC-2"	4251	4240
1x500	--	42.0	JPW-09	JPF-09	JF-001	JC-2"	4251	4242
1x625	--	47.0	JPW-09	JPF-09	JF-001	JC-2"	5451,5463	5448
1x800	--	52.0	JPW-010	JPF-010	JF-002	JC-2-1/4"	5463	5450
1x1000	--	57.0	JPW-011	JPF-011	JF-003	JC-2-1/2"	6063	6060

AYY (ARMOURED SINGLE CORE POWER CABLES) 650/1100 V

1x4	12.3	--	JPW-001	JPF-01 S	JF-5	JC-1/2"	1616	1613
1x6	12.8	--	JPW-001	JPF-01 S	JF-5	JC-5/8"	1616	1613
1x10	13.5	--	JPW-001	JPF-01 S	JF-5	JC-3/4"	1616,1619	1613
1x16	15.5	--	JPW-01 S	JPF-01 S	JF-5	JC-3/4"	1616,1619	1615
1x25	16.5	--	JPW-01 S	JPF-01 S	JF-5	JC-7/8"	2119	2116
1x35	17.0	--	JPW-01	JPF-01	JF-5	JC-7/8"	2119	2118
1x50	18.5	--	JPW-01	JPF-01	JF-4	JC-1"	2125	2118
1x70	21.0	--	JPW-02	JPF-02	JF-3	JC-1"	2125	2120
1x95	23.0	--	JPW-03	JPF-03	JF-2	JC-1-1/8"	2925,2932	2923
1x120	25.0	--	JPW-04	JPF-04	JF-2	JC-1-1/8"	2925,2932	2925
1x150	26.0	--	JPW-04	JPF-04	JF-1	JC-1-1/8"	2925,2932	2925
1x185	29.0	--	JPW-05	JPF-05	JF-1	JC-1-1/4"	2932	2929
1x225	31.5	--	JPW-06	JPF-06	JF-11	JC-1-3/8"	3636	3631
1x240	33.5	--	JPW-06	JPF-06	JF-11	JC-1-3/8"	3638	3633
1x300	36.0	--	JPW-07	JPF-07	JF-00	JC-1-1/2"	3638	3637
1x400	41.0	--	JPW-08	JPF-08	JF-38	JC-1-3/4"	4251	4240
1x500	43.0	--	JPW-09	JPF-09	JF-001	JC-2"	4251	4242
1x625	49.0	--	JPW-010	JPF-010	JF-002	JC-2-1/4"	5451	5448
1x800	54.0	--	JPW-011	JPF-011	JF-003	JC-2-1/4"	6063	6055
1x1000	59.0	--	JPW-011	JPF-011	JF-003	JC-2-1/2"	6063	6060

Selection Chart

CABLE CONSTRUCTION DETAIL			DOUBLE COMPRESSION TYPE		FLANGE TYPE	SINGLE COMPRESSION TYPE		
Core Size sq.mm	Armoured Overall Dia mm(Approx)	Unarmoured Overall Dia mm(Approx)	Weatherproof Type (JPW)	Flameproof Type (JPF)	Type (JF)	Siemens Type (JC)	Heavy Duty Type (SIBG)	Rubber Ref. No.
AYWY (ARMoured TWIN CORE POWER CABLES) 650/1100V								
2 x 1.5	15.0	8.0	JPW-001	JPF-01S	JF-5	JC-1/2"	1616	1615
2 x 2.5	16.0	9.0	JPW-01S	JPF-01S	JF-5	JC-5/8"	1616,1619	1615
2 x 4	17.5	10.5	JPW-01	JPF-01	JF-4	JC-3/4"	1616,1619	1615
2 x 6	18.5	11.5	JPW-01	JPF-01	JF-4	JC-7/8"	2119,2125	2120
2 x 10	20.5	14.0	JPW-02	JPF-02	JF-3	JC-1"	2119,2125	2118
2 x 16	22.5	16.5	JPW-03	JPF-03	JF-2	JC-1"	2125	2120
2 x 25	25.0	19.0	JPW-04	JPF-04	JF-1	JC-1-1/8"	2925,2932	2925
2 x 35	27.5	22.0	JPW-05	JPF-05	JF-1	JC-1-1/4"	2932,2938	2927
2 x 50	29.0	23.5	JPW-05	JPF-05	JF-11	JC-1-1/4"	2932,2938	2927
2 x 70	31.0	25.0	JPW-06	JPF-06	JF-11	JC-1-1/4"	2938	2929
2 x 95	33.0	27.0	JPW-06	JPF-06	JF-11	JC-1-3/8"	2938	2929
2 x 120	34.0	28.0	JPW-07	JPF-07	JF-11	JC-1-3/8"	3638	3633
2 x 150	38.0	32.0	JPW-08	JPF-08	JF-00	JC-1-1/2"	3638	3637
2 x 185	41.0	35.0	JPW-08	JPF-08	JF-001	JC-1-3/4"	4251	4242
2 x 240	46.0	40.0	JPW-09	JPF-09	JF-002	JC-2"	5451	5446
2 x 300	51.0	43.0	JPW-010	JPF-010	JF-003	JC-2-1/4"	5463	5050
2 x 400	57.0	50.0	JPW-011	JPF-011	JF-003	JC-2-1/2"	6063	6060

AYFY (ARMoured THREE CORE POWER CABLES) 650/1100V								
3 x 1.5	15.5	8.5	JPW-01S	JPF-01S	JF-5	JC-5/8"	1616,1619	1615
3 x 2.5	17.0	10.5	JPW-01S	JPF-01S	JF-4	JC-3/4"	1616,1619	1615
3 x 4	18.0	11.0	JPW-01	JPF-01	JF-4	JC-3/4"	2119,2125	2116
3 x 6	19.5	12.5	JPW-02	JPF-02	JF-3	JC-7/8"	2119,2125	2118
3 x 10	20.5	14.5	JPW-03	JPF-03	JF-3	JC-1"	2119,2125	2120
3 x 16	23.5	18.0	JPW-04	JPF-04	JF-2	JC-1-1/8"	2925,2932	2923
3 x 25	23.5	18.0	JPW-04	JPF-04	JF-2	JC-1-1/8"	2932,2938	2923
3 x 35	25.5	20.0	JPW-04	JPF-04	JF-1	JC-1-1/8"	2932,2938	2925
3 x 50	29.0	23.0	JPW-05	JPF-05	JF-1	JC-1-1/4"	2932,2938	2929
3 x 70	33.0	27.0	JPW-06	JPF-06	JF-0	JC-1-3/8"	3638	3633
3 x 95	37.0	31.0	JPW-07	JPF-07	JF-00	JC-1-1/2"	3638	3637
3 x 120	40.0	34.0	JPW-08	JPF-08	JF-38	JC-1-3/4"	4251	4240
3 x 150	44.0	38.0	JPW-09	JPF-09	JF-001	JC-1-3/4"	4251	4242
3 x 185	49.0	42.0	JPW-010	JPF-010	JF-002	JC-2"	5451	5448
3 x 225	54.0	47.0	JPW-011	JPF-011	JF-003	JC-2-1/4"	6063	6053
3 x 240	56.0	49.0	JPW-011	JPF-011	JF-003	JC-2-1/2"	6063	6055
3 x 300	62.0	54.0	JPW-012	JPF-012	JF-0033	JC-2-3/4"	6063	6060
3 x 400	68.0	60.0	JPW-012	JPF-012	JF-004	JC-3"	7882	7868
3 x 500	76.0	70.0	JPW-013	JPF-013	JF-004	JC-3-1/4"	7882	7874

Selection Chart

CABLE CONSTRUCTION DETAIL			DOUBLE COMPRESSION TYPE		FIANGE TYPE	SINGLE COMPRESSION TYPE		
Core Size sq.mm	Armoured Overall Dia mm(Approx)	Unarmoured Overall Dia mm(Approx)	Weatherproof Type (JPW)	Flameproof Type (JPF)	Type (JF)	Siemens Type (JC)	Heavy Duty Type (SIBG)	Rubber Ref. No.
AYFY (ARMoured MULTI CORE POWER CABLES) 650/1100V								
3.5 x 25/16	26.0	21.0	JPW-04	JPF-04	JF-1	JC-1-1/8"	2925,2932	2925
3.5 x 35/16	28.5	23.0	JPW-05	JPF-05	JF-1	JC-1-1/4"	2932,2938	2927
3.5 x 50/25	32.0	26.0	JPW-06	JPF-06	JF-11	JC-1-3/8"	3638	3631
3.5 x 70/35	35.0	29.0	JPW-07	JPF-07	JF-0	JC-1-1/2"	3638	3635
3.5 x 95/50	40.0	34.0	JPW-08	JPF-08	JF-38	JC-1-3/4"	4251	4240
3.5 x 120/70	43.0	37.0	JPW-09	JPF-09	JF-001	JC-1-3/4"	4251	4242
3.5 x 150/70	48.0	41.0	JPW-010	JPF-010	JF-002	JC-2"	5451	5446
3.5 x 185/95	52.0	45.0	JPW-010	JPF-010	JF-002	JC-2-1/4"	5463	5450
3.5 x 225/120	58.0	50.0	JPW-011	JPF-011	JF-003	JC-2-1/2"	6063	6058
3.5 x 240/120	61.0	53.0	JPW-012	JPF-012	JF-0033	JC-2-3/4"	6063	6060
3.5 x 300/150	66.0	58.0	JPW-012	JPF-012	JF-0033	JC-2-3/4"	6675	6664
3.5 x 400/185	74.0	65.0	JPW-013	JPF-013	JF-004	JC-3-1/4"	7882	7874
3.5 x 500/240	82.0	72.0	JPW-014	JPF-014	JF-005	JC-3-1/2"	SPL	-----
AYWY & AYFY (ARMoured FOUR CORE POWER CABLES) 650/1100V								
4 x 1.5	16.5	10.0	JPW- 01S	JPF-01S	JF-5	JC-3/4"	1616,1619	1615
4 x 2.5	17.5	11.0	JPW- 01	JPF-01	JF-4	JC-3/4"	1616,1619	1615
4 x 4	19.5	13.0	JPW- 02	JPF-02	JF-3	JC-7/8"	2119,2125	2118
4 x 6	20.0	14.0	JPW- 02	JPF-02	JF-3	JC-7/8"	2125	2120
4 x 10	21.5	16.0	JPW- 03	JPF-03	JF-2	JC-1"	2125	2120
4 x 16	25.5	20.0	JPW- 04	JPF-04	JF-1	JC-1-1/8"	2925,2932	2925
4 x 25	26.0	21.0	JPW- 04	JPF-04	JF-1	JC-1-1/4"	2932,2938	2925
4 x 35	28.5	23.0	JPW- 05	JPF-05	JF-1	JC-1-3/8"	2938	2927
4 x 50	33.0	26.0	JPW- 06	JPF-06	JF-11	JC-1-3/8"	2938	2929
4 x 70	37.0	30.0	JPW-07	JPF-07	JF-00	JC-1-1/2"	3638	3637
4 x 95	42.0	34.0	JPW-08	JPF-08	JF-38	JC-1-3/4"	4251	4242
4 x 120	45.0	36.0	JPW-09	JPF-09	JF-001	JC-1-3/4"	5451	5446
4 x 150	50.0	43.0	JPW-010	JPF-010	JF-002	JC-2"	5463	5450
4 x 185	55.0	48.0	JPW-011	JPF-011	JF-003	JC-2-1/4"	5463	5450
4 x 240	62.0	54.0	JPW-011	JPF-011	JF-0033	JC-2-1/2"	6063	6060
4 x 300	68.0	60.0	JPW-012	JPF-012	JF-004	JC-2-3/4"	6675	6664
4 x 400	76.0	70.0	JPW-013	JPF-013	JF-004	JC-3-1/4"	7882	7874
YWY & YFY (ARMoured MULTYCORE CABLES) 650/1100V								
2 x 1.5	15.0	8.0	JPW-001	JPF-01S	JF-5	JC-1/2"	1616	1613
3 x 1.5	15.5	8.5	JPW- 01S	JPF- 01S	JF-5	JC-5/8"	1616,1619	1615
4 x 1.5	16.5	9.5	JPW-01S	JPF-01S	JF-5	JC-3/4"	1616,1619	1615
5 x 1.5	17.0	10.0	JPW-01S	JPF-01S	JF-4	JC-3/4"	1616,1619	1615
6 x 1.5	18.0	11.0	JPW-01	JPF-01	JF-4	JC-3/4"	2119,2125	2118
7 x 1.5	18.0	11.0	JPW-01	JPF-01	JF-4	JC-3/4"	2119,2125	2118

Selection Chart

CABLE CONSTRUCTION DETAIL			DOUBLE COMPRESSION TYPE		FLANGE TYPE	SINGLE COMPRESSION TYPE		
Core Size sq.mm	Armoured Overall Dia mm(Approx)	Unarmoured Overall Dia mm(Approx)	Weatherproof Type (JPW)	Flameproof Type (JPF)	Type (JF)	Siemens Type (JC)	Heavy Duty Type (SIBG)	Rubber Ref. No.
YWY & YFY (ARMoured MULTYCORE CABLES)650/1100V								
10 x 1.5	20.5	13.5	JPW-03	JPF-03	JF-3	JC-1"	2119,2125	2118
12 x 1.5	20.5	14.0	JPW-03	JPF-03	JF-3	JC-1"	2119,2125	2118
14 x 1.5	21.0	15.0	JPW-03	JPF-03	JF-2	JC-1"	2125	2120
16 x 1.5	21.5	15.0	JPW-03	JPF-03	JF-2	JC-1"	2125	2120
19 x 1.5	22.5	16.0	JPW-03	JPF-03	JF-2	JC-1"	2125	2120
24 x 1.5	25.5	19.0	JPW-04	JPF-04	JF-1	JC-1-1/8"	2932,2938	2925
27 x 1.5	26.0	19.0	JPW-04	JPF-04	JF-1	JC-1-1/4"	2932,2938	2925
30 x 1.5	27.0	21.5	JPW-05	JPF-05	JF-1	JC-1-1/4"	2932,2938	2925
37 x 1.5	29.0	23.0	JPW-05	JPF-05	JF-1	JC-1-1/4"	2932,2938	2927
44 x 1.5	33.0	26.0	JPW-06	JPF-06	JF-11	JC-1-3/8"	3638	3631
52 x 1.5	34.0	27.0	JPW-07	JPF-07	JF-0	JC-1-1/2"	3638	3633
61 X 1.5	36.0	29.0	JPW-07	JPF-07	JF-00	JC-1-1/2"	3638	3635
YWY & YFY (ARMoured MULTYCORE CABLES)650/1100V								
2 x 2.5	16.0	10.0	JPW- 01S	JPF-01S	JF-5	JC-5/8"	1616,1619	1615
3 x 2.5	17.0	11.0	JPW- 01S	JPF-01S	JF-4	JC-3/4"	1616,1619	1615
4 x 2.5	17.5	11.5	JPW-01	JPF-01	JF-4	JC-3/4"	1616,1619	1615
5 x 2.5	19.0	12.5	JPW-02	JPF-02	JF-4	JC-7/8"	2119,2125	2118
6 x 2.5	20.5	13.5	JPW-03	JPF-03	JF-3	JC-1"	2119,2125	2118
7 x 2.5	20.5	13.5	JPW-03	JPF-03	JF-3	JC-1"	2119,2125	2118
10 x 2.5	22.0	16.5	JPW-03	JPF-03	JF-2	JC-1"	2125	2120
12 x 2.5	22.5	17.0	JPW-03	JPF-03	JF-2	JC-1"	2125	2120
14 x 2.5	23.5	17.0	JPW-04	JPF-04	JF-2	JC-1-1/8"	2925	2923
16 x 2.5	24.5	18.0	JPW-04	JPF-04	JF-2	JC-1-1/8"	2925,2932	2923
19 x 2.5	25.5	19.0	JPW-04	JPF-04	JF-1	JC-1-1/8"	2932,2938	2925
24 x 2.5	29.5	22.0	JPW-05	JPF-05	JF-1	JC-1-1/4"	2932,2938	2927
27 x 2.5	30.0	23.0	JPW-05	JPF-05	JF-1	JC-1-1/4"	2932,2938	2929
30 x 2.5	32.0	25.0	JPW-06	JPF-06	JF-11	JC-1-3/8"	3638	3631
37 x 2.5	34.0	28.0	JPW-07	JPF-07	JF-0	JC-1-1/2"	3638	3633
44 x 2.5	38.0	31.0	JPW-08	JPF-08	JF-00	JC-1-1/2"	3638	3637
52 x 2.5	39.0	32.0	JPW-08	JPF-08	JF-38	JC-1-3/4"	4251	4238
61 x 2.5	42.0	35.0	JPW-09	JPF-09	JF-38	JC-1-3/4"	4251	4240
AYFY (ARMoured THREE CORE POWER CABLES)1900/3300V								
3 x 25	29.0	21.0	JPW-05	JPF-05	JF-1	JC-1-1/4"	2932,2938	2927
3 x 35	31.0	24.0	JPW-06	JPF-06	JF-11	JC-1-3/8"	2932,2938	2929
3 x 50	34.0	26.0	JPW-07	JPF-07	JF-11	JC-1-1/2"	3638	3633
3 x 70	37.0	29.0	JPW-07	JPF-07	JF-00	JC-1-1/2"	3638	3635
3 x 95	41.0	33.0	JPW-08	JPF-08	JF-38	JC-1-3/4"	4251	4238
3 x 120	44.0	35.0	JPW-09	JPF-09	JF-001	JC-1-3/4"	4251	4242
3 x 150	47.0	38.0	JPW-010	JPF-010	JF-002	JC-2"	5451	5446

Selection Chart

CABLE CONSTRUCTION DETAIL			DOUBLE COMPRESSION TYPE		FLANGE TYPE	SINGLE COMPRESSION TYPE		
Core Size sq.mm	Armoured Overall Dia mm(Approx)	Unarmoured Overall Dia mm(Approx)	Weatherproof Type (JPW)	Flameproof Type (JPF)	Type (JF)	Siemens Type (JC)	Heavy Duty Type (SIBG)	Rubber Ref. No.
AYFY (ARMoured THREE CORE POWER CABLES)1900/3300V								
3 x 185	50.0	41.0	JPW-010	JPF-010	JF-002	JC-2-1/4"	5451,5463	5448
3 x 225	55.0	36.0	JPW-011	JPF-011	JF-003	JC-2-1/4"	6063	6053
3 x 240	56.0	45.0	JPW-011	JPF-011	JF-003	JC-2-1/2"	6063	6055
3 x 300	62.0	52.0	JPW-012	JPF-012	JF-0033	JC-2-3/4"	6063	6060
3 x 400	69.0	59.0	JPW-013	JPF-013	JF-004	JC-3"	7882	7868
3 X 500	77.0	66.0	JPW-013	JPF-013	JF-005	JC-3-1/4"	7882	7877
AYFY (ARMoured THREE CORE POWER CABLES)3800/6600V								
3 x 25	35.0	27.0	JPW-07	JPF-07	JF-0	JC-1-1/2"	3638	3635
3 x 35	37.0	29.0	JPW-07	JPF-07	JF-00	JC-1-1/2"	3638	3635
3 x 50	40.0	32.0	JPW-08	JPF-08	JF-38	JC-1-3/4"	4251	4240
3 x 70	44.0	35.0	JPW-09	JPF-09	JF-001	JC-1-3/4"	4251	4242
3 x 95	47.0	38.0	JPW-010	JPF-010	JF-002	JC-2"	5451	5446
3 x 120	50.0	41.0	JPW-010	JPF-010	JF-002	JC-2-1/4"	5451,5463	5448
3 x 150	54.0	45.0	JPW-011	JPF-011	JF-003	JC-2-1/4"	6063	6053
3 x 185	57.0	48.0	JPW-011	JPF-011	JF-003	JC-2-1/2"	6063	6058
3 x 225	61.0	51.0	JPW-012	JPF-012	JF-0033	JC-2-1/2"	6063	6060
3 x 240	63.0	53.0	JPW-012	JPF-012	JF-0033	JC-2-3/4"	6675	6662
3 x 300	67.0	57.0	JPW-012	JPF-012	JF-0033	JC-2-3/4"	7882	7870
3 x 400	73.0	63.0	JPW-013	JPF-013	JF-004	JC-3"	7882	7874
3 x 500	79.0	68.0	JPW-014	JPF-014	JF-005	JC-3-1/4"	7882	7877
AYFY (ARMoured THREE CORE POWER CABLES)6600V(UE GRADE)								
3 x 25	38.0	30.0	JPW-08	JPF-08	JF-00	JC-1-1/2"	3638	3637
3 x 35	40.0	32.0	JPW-08	JPF-08	JF-38	JC-1-3/4"	4251	4240
3 x 50	43.0	34.0	JPW-09	JPF-09	JF-001	JC-1-3/4"	4251	4240
3 x 70	47.0	38.0	JPW-010	JPF-010	JF-002	JC-2"	5451	5446
3 x 95	50.0	41.0	JPW-010	JPF-010	JF-002	JC-2-1/4"	5451,5463	5448
3 x 120	52.0	43.0	JPW-010	JPF-010	JF-002	JC-2-1/4"	6063	6053
3 x 150	57.0	48.0	JPW-011	JPF-011	JF-003	JC-2-1/2"	6063	6058
3 x 185	60.0	50.0	JPW-011	JPF-011	JF-0033	JC-2-1/2"	6063	6058
3 x 225	64.0	54.0	JPW-012	JPF-012	JF-0033	JC-2-3/4"	6675	6662
3 x 240	66.0	56.0	JPW-012	JPF-012	JF-0033	JC-2-3/4"	6675	6664
3 x 300	71.0	61.0	JPW-013	JPF-013	JF-004	JC-3"	7882	7870
3 x 400	76.0	65.0	JPW-013	JPF-013	JF-004	JC-3-1/4"	7882	7874
3 x 500	83.0	71.0	JPW-014	JPF-014	JF-005	JC-3-1/2"	SPL	-----

JAINSON CABLE GLANDS ARE AVAILABLE WITH
FOLLOWING THREADS AS PER REQUIREMENT ONLY

● NPT ● PG ● BSP ● METRIC (mm)

YASH TRADING CO.

JAIN ESTATE, JAKERIA ROAD, MALAD (W.),
MUMBAI - 400 064. (INDIA)
TEL.: 2880 23 15, 2880 75 81 FAX.: 022-2882 40 10 .
Web.: www.jainsongroup.com