



B-31 SERIES LIGHT DUTY



30-65 Kg.



Spec. Demonstration

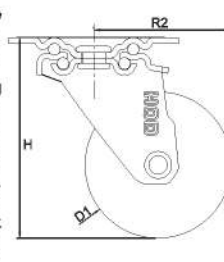

Conventional Plate

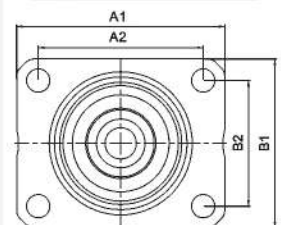

Materials Thickness

2"

:1.8MM

Top Plate Thickness



Fork Thickness :1.8MM

Materials Thickness

25 ~ 4"

:2MM

Top Plate Thickness



Fork Thickness :2MM



PCW-B31-FX-50-PU-O



PCW-B31-PL-75-PU-O



PCW-B31-PK-50-PU-O



PCW-B31-TH-50-PU-O



PCW-B31-TK-50-PU-O

WHEEL DIA (MM)	TREAD WIDTH (MM)	LOAD CAPACITY (Kg.) Per Pc.	WHEEL MATERIAL	LOAD HEIGHT (MM)	SWIVEL RADIUS (MM)	BRAKE RADIUS (MM)	BEARING	PLATE SIZE (MM) A1XB1 A2XB2	ITEM CODE	MRP/PCS
50	22	30 Kg.	POLY URTHENE (PU)	68.5	47	67.5	DERLIN BEARING	58.5X47 6.5 46X35	PCW-B31-FX-50-PU-O	100
									PCW-B31-PL-50-PU-O	130
									PCW-B31-PK-50-PU-O	165
									PCW-B31-TH-50-PU-O	150
									PCW-B31-TK-50-PU-O	185
75	22	50 Kg.	POLY URTHENE (PU)	95.5	64.5	69.5	DERLIN BEARING	70X52 8.5 54X36	PCW-B31-FX-75-PU-O	205
									PCW-B31-PL-75-PU-O	255
100	25	65 Kg.	POLY URTHENE (PU)	122	83	88	DERLIN BEARING	80X58 8.5 63X40	PCW-B31-FX-100-PU-O	290
									PCW-B31-PL-100-PU-O	360



B-31 SERIES LIGHT DUTY



12-40 Kg.

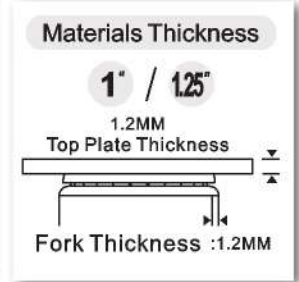
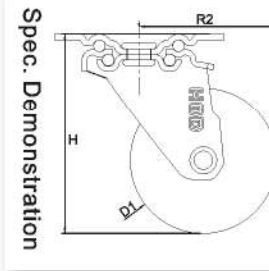

PCW-B31-FX-50-TPR-BR

PCW-B31-PL-25-TPR-BR

PCW-B31-PK-50-TPR-BR

PCW-B31-TH-50-TPR-BR

PCW-B31-TK-50-TPR-BR

WHEEL DIA (MM)	TREAD WIDTH (MM)	LOAD CAPACITY (Kg.) Per Pc.	WHEEL MATERIAL	LOAD HEIGHT (MM)	SWIVEL RADIUS (MM)	BRAKE RADIUS (MM)	BEARING	PLATE SIZE (MM) A1XB1 A2XB2	ITEM CODE	MRP/PCS
25	13	12 kg.	THERMO PLASTIC RUBBER (TPR)	37	28	48.5	DERLIN BEARING	38X30 4.2 29X21	PCW-B31-PL-25-TPR-BR	80
									PCW-B31-PK-25-TPR-BR	115
38	17	20 kg.	THERMO PLASTIC RUBBER (TPR)	52	37	57	DERLIN BEARING	46X38 5.2 36X28	PCW-B31-PL-38-TPR-BR	105
									PCW-B31-PK-38-TPR-BR	140
									PCW-B31-TH-38-TPR-BR	120
									PCW-B31-TK-38-TPR-BR	150
50	22	20 Kg.	THERMO PLASTIC RUBBER (TPR)	68.5	47	67.5	DERLIN BEARING	58.5X47 6.5 46X35	PCW-B31-FX-50-TPR-BR	105
									PCW-B31-PL-50-TPR-BR	130
									PCW-B31-PK-50-TPR-BR	165
									PCW-B31-TH-50-TPR-BR	155
									PCW-B31-TK-50-TPR-BR	190
75	22	35 Kg.	THERMO PLASTIC RUBBER (TPR)	95.5	64.5	69.5	DERLIN BEARING	70X52 8.5 54X36	PCW-B31-FX-75-TPR-BR	225
									PCW-B31-PL-75-TPR-BR	275
100	25	40 Kg.	THERMO PLASTIC RUBBER (TPR)	122	83	88	DERLIN BEARING	80X58 8.5 63X40	PCW-B31-FX-100-TPR-BR	310
									PCW-B31-PL-100-TPR-BR	385



B-51 SERIES MEDIUM DUTY



100-150 Kg.



European Plate Optional

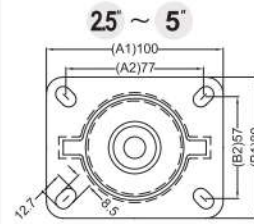

Conventional Plate

1.6"

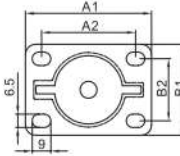

Conventional Plate

2"

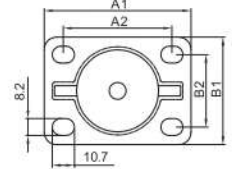

PCW-B51-FX-63-PU-B PCW-B51-HK-75-PU-B PCW-B51-PK-100-PU-B PCW-B51-TH-125-PU-B PCW-B51-TK-125-PU-B PCW-B51-HO-125-PU-B

WHEEL DIA (MM)	TREAD WIDTH (MM)	LOAD CAPACITY (Kg.) Per Pc.	WHEEL MATERIAL	LOAD HEIGHT (MM)	SWIVEL RADIUS (MM)	BRAKE RADIUS (MM)	BEARING	PLATE SIZE (MM) A1XB1 A2XB2	ITEM CODE	MRP/PCS
63	32	100 Kg.	POLY URTHENE (PU)	94	66.5	102	SINGLE BALL BEARING	95X66.5 8.5 74.5X45	PCW-B51-FX-63-PU-B	370
									PCW-B51-PL-63-PU-B	450
									PCW-B51-PK-63-PU-B	580
									PCW-B51-TH-63-PU-B	450
									PCW-B51-TK-63-PU-B	580
75	32	115 Kg.	POLY URTHENE (PU)	106	72.5	102	SINGLE BALL BEARING	95X66.5 8.5 74.5X45	PCW-B51-FX-75-PU-B	410
									PCW-B51-PL-75-PU-B	475
									PCW-B51-PK-75-PU-B	620
									PCW-B51-TH-75-PU-B	475
									PCW-B51-TK-75-PU-B	620
									PCW-B51-HO-75-PU-B	475
									PCW-B51-HK-75-PU-B	620
100	32	140 Kg.	POLY URTHENE (PU)	131	85	107	SINGLE BALL BEARING	95X66.5 8.5 74.5X45	PCW-B51-FX-100-PU-B	460
									PCW-B51-PL-100-PU-B	525
									PCW-B51-PK-100-PU-B	665
									PCW-B51-TH-100-PU-B	525
									PCW-B51-TK-100-PU-B	665
									PCW-B51-HO-100-PU-B	525
									PCW-B51-HK-100-PU-B	665
125	32	150 Kg.	POLY URTHENE (PU)	157	100.5		SINGLE BALL BEARING	95X66.5 8.5 74.5X45	PCW-B51-FX-125-PU-B	610
									PCW-B51-PL-125-PU-B	680
									PCW-B51-PK-125-PU-B	820
									PCW-B51-TH-125-PU-B	680
									PCW-B51-TK-125-PU-B	820
									PCW-B51-HO-125-PU-B	680
									PCW-B51-HK-125-PU-B	820



Z-51 SERIES MEDIUM DUTY



40-150 Kg.



Conventional Plate

1.6"

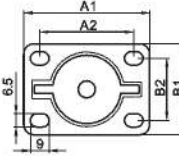

Conventional Plate

25" ~ 5"

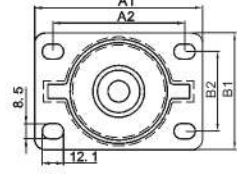

PCW-Z51-FX-40-PP-G

PCW-Z51-PL-40-PP-G

PCW-Z51-PK-50-PP-G

PCW-Z51-TH-75-PP-G

PCW-Z51-TK-125-PP-G

WHEEL DIA (MM)	TREAD WIDTH (MM)	LOAD CAPACITY (Kg.) Per Pc.	WHEEL MATERIAL	LOAD HEIGHT (MM)	SWIVEL RADIUS (MM)	BRAKE RADIUS (MM)	BEARING	PLATE SIZE (MM) A1XB1 A2XB2	ITEM CODE	MRP/PCS
40	22	40 Kg.	POLY PROPYLENE (PP)	61.5	45	67	SINGLE BALL BEARING	61X41 6.5 45.5X30	PCW-Z51-FX-40-PP-G	110
									PCW-Z51-PL-40-PP-G	160
									PCW-Z51-PK-40-PP-G	210
									PCW-Z51-TH-40-PP-G	160
									PCW-Z51-TK-40-PP-G	210
50	26	55 Kg.	POLY PROPYLENE (PP)	74.5	53	67	SINGLE BALL BEARING	71X52 8.2 53.5X35	PCW-Z51-FX-50-PP-G	130
									PCW-Z51-PL-50-PP-G	210
									PCW-Z51-PK-50-PP-G	255
									PCW-Z51-TH-50-PP-G	210
									PCW-Z51-TK-50-PP-G	255
63	32	100 Kg.	POLY PROPYLENE (PP)	94	66.5	102	SINGLE BALL BEARING	95X66.5 8.5 74.5X45	PCW-Z51-FX-63-PP-G	300
									PCW-Z51-PL-63-PP-G	370
									PCW-Z51-PK-63-PP-G	480
									PCW-Z51-TH-63-PP-G	370
									PCW-Z51-TK-63-PP-G	480
75	32	125 Kg.	POLY PROPYLENE (PP)	106	72.5	102	SINGLE BALL BEARING	95X66.5 8.5 74.5X45	PCW-Z51-FX-75-PP-G	320
									PCW-Z51-PL-75-PP-G	390
									PCW-Z51-PK-75-PP-G	505
									PCW-Z51-TH-75-PP-G	390
									PCW-Z51-TK-75-PP-G	505
100	32	140 Kg.	POLY PROPYLENE (PP)	131	85	107	SINGLE BALL BEARING	95X66.5 8.5 74.5X45	PCW-Z51-FX-100-PP-G	390
									PCW-Z51-PL-100-PP-G	470
									PCW-Z51-PK-100-PP-G	580
									PCW-Z51-TH-100-PP-G	470
									PCW-Z51-TK-100-PP-G	580
125	32	150 Kg.	POLY PROPYLENE (PP)	157	100.5	113	SINGLE BALL BEARING	95X66.5 8.5 74.5X45	PCW-Z51-FX-125-PP-G	470
									PCW-Z51-PL-125-PP-G	555
									PCW-Z51-PK-125-PP-G	665
									PCW-Z51-TH-125-PP-G	555
									PCW-Z51-TK-125-PP-G	665



B-62 SERIES MEDIUM / HEAVY DUTY



170-310 Kg.



Conventional Plate

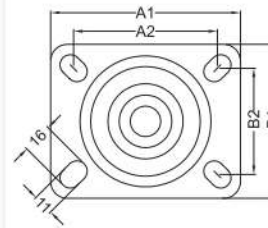

Upward independent bearing plate structure

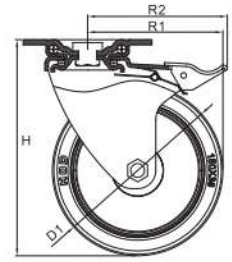

Materials Thickness

3" / 4"

:4.0MM

Top Plate Thickness



Fork Thickness :3.0MM

Materials Thickness

5" / 6"

:4.5MM

Top Plate Thickness



Fork Thickness :3.0MM



PCW-B62-FX-75-PP-G



PCW-B62-PL-100-PP-G



PCW-B62-PK-125-PP-G



PCW-B62-TH-75-PP-G



PCW-B62-TK-75-PP-G

WHEEL DIA (MM)	TREAD WIDTH (MM)	LOAD CAPACITY (Kg.) Per Pc.	WHEEL MATERIAL	LOAD HEIGHT (MM)	SWIVEL RADIUS (MM)	BRAKE RADIUS (MM)	BEARING	PLATE SIZE (MM) A1XB1 A2XB2	ITEM CODE	MRP/PCS
75	38	170 Kg.	POLY PROPYLENE (PP)	111	72.5	104.5	DOUBLE BALL BEARING	101.5 X 82.5 X 11	PCW-B62-FX-75-PP-G	555
									PCW-B62-PL-75-PP-G	640
									PCW-B62-PK-75-PP-G	765
									PCW-B62-TH-75-PP-G	770
									PCW-B62-TK-75-PP-G	860
100	38	210 Kg.	POLY PROPYLENE (PP)	136	85	109	DOUBLE BALL BEARING	101.5 X 82.5 X 11	PCW-B62-FX-100-PP-G	600
									PCW-B62-PL-100-PP-G	725
									PCW-B62-PK-100-PP-G	895
125	38	280 Kg.	POLY PROPYLENE (PP)	163	102.5	124.5	DOUBLE BALL BEARING	113 X 99 X 11	PCW-B62-FX-125-PP-G	850
									PCW-B62-PL-125-PP-G	980
									PCW-B62-PK-125-PP-G	1190
150	38	310 Kg.	POLY PROPYLENE (PP)	190	119	129.5	DOUBLE BALL BEARING	113 X 99 X 11	PCW-B62-FX-150-PP-G	980
									PCW-B62-PL-150-PP-G	1105
									PCW-B62-PK-150-PP-G	1320



B-62 SERIES MEDIUM / HEAVY DUTY



140-240 Kg.

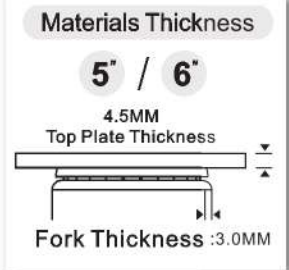
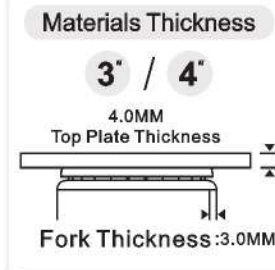
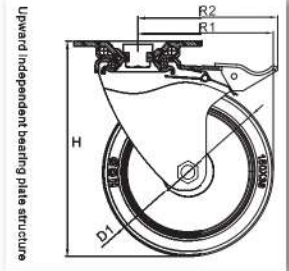
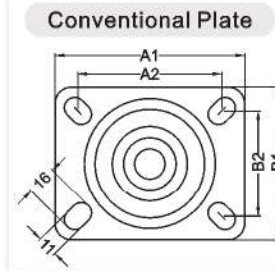

PCW-B62-FX-75-PU-B



PCW-B62-PL-75-PU-B



PCW-B62-PK-75-PU-B

WHEEL DIA (MM)	TREAD WIDTH (MM)	LOAD CAPACITY (Kg.) Per Pc.	WHEEL MATERIAL	LOAD HEIGHT (MM)	SWIVEL RADIUS (MM)	BRAKE RADIUS (MM)	BEARING	PLATE SIZE (MM) A1XB1 A2XB2	ITEM CODE	MRP/PCS
75	38	140 Kg.	POLY URTHENE (PU)	111	72.5	104.5	DOUBLE BALL BEARING	101.5 X 82.5-11 76.5 X 56.5	PCW-B62-FX-75-PU-B	640
									PCW-B62-PL-75-PU-B	720
									PCW-B62-PK-75-PU-B	860
100	38	170 Kg.	POLY URTHENE (PU)	136	85	109	DOUBLE BALL BEARING	101.5 X 82.5-11 76.5 X 56.5	PCW-B62-FX-100-PU-B	685
									PCW-B62-PL-100-PU-B	810
									PCW-B62-PK-100-PU-B	985
125	38	210 Kg.	POLY URTHENE (PU)	163	102.5	124.5	DOUBLE BALL BEARING	113 X 99-11 84.5 X 71.5	PCW-B62-FX-125-PU-B	985
									PCW-B62-PL-125-PU-B	1105
									PCW-B62-PK-125-PU-B	1315
150	38	240 Kg.	POLY URTHENE (PU)	190	119	129.5	DOUBLE BALL BEARING	113 X 99-11 84.5 X 71.5	PCW-B62-FX-150-PU-B	1110
									PCW-B62-PL-150-PU-B	1240
									PCW-B62-PK-150-PU-B	1445



Z-72 HEAVY DUTY



290-480 Kg.



Conventional Plate

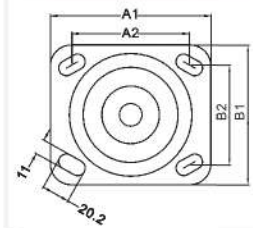

Spec. Demonstration

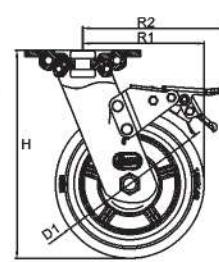

Materials Thickness

4" ~ 8"

5.0MM

Top Plate Thickness

Fork Thickness : 5.0MM



PCW-Z72-FX-100-PP-M



PCW-Z72-PL-150-PP-M



PCW-Z72-PK-200-PP-M

WHEEL DIA (MM)	TREAD WIDTH (MM)	LOAD CAPACITY (Kg.) Per Pc.	WHEEL MATERIAL	LOAD HEIGHT (MM)	SWIVEL RADIUS (MM)	BRAKE RADIUS (MM)	BEARING	PLATE SIZE (MM) A1XB1 A2XB2	ITEM CODE	MRP/PCS
100	45	290 Kg.	POLY PROPYLENE (PP)	144	82	125	DOUBLE BALL BEARING	115 X 100 X 11	PCW-Z72-FX-100-PP-M	810
									PCW-Z72-PL-100-PP-M	940
									PCW-Z72-PK-100-PP-M	1145
125	45	350 Kg.	POLY PROPYLENE (PP)	165	96.5	130	DOUBLE BALL BEARING	115 X 100 X 11	PCW-Z72-FX-125-PP-M	890
									PCW-Z72-PL-125-PP-M	1020
									PCW-Z72-PK-125-PP-M	1320
150	45	420 Kg.	POLY PROPYLENE (PP)	191	114	140	DOUBLE BALL BEARING	115 X 100 X 11	PCW-Z72-FX-150-PP-M	935
									PCW-Z72-PL-150-PP-M	1060
									PCW-Z72-PK-150-PP-M	1360
200	45	480 Kg.	POLY PROPYLENE (PP)	242	150	150	DOUBLE BALL BEARING	115 X 100 X 11	PCW-Z72-FX-200-PP-M	1145
									PCW-Z72-PL-200-PP-M	1275
									PCW-Z72-PK-200-PP-M	1530



B-73 HEAVY DUTY



240-385 Kg.

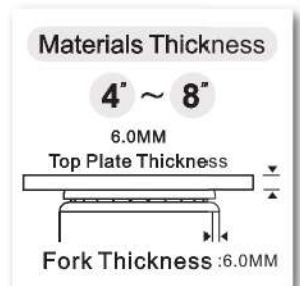
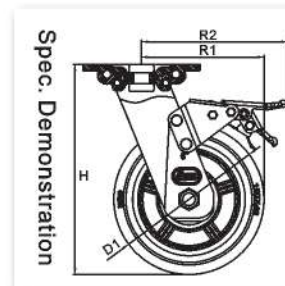
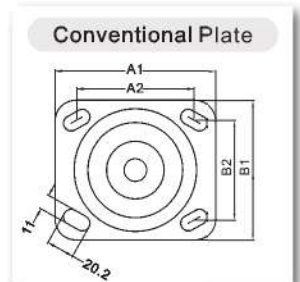
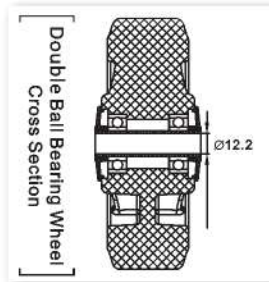

PCW-B73-FX-100-PU-O



PCW-B73-PL-125-PU-O



PCW-B73-PK-150-PU-O

WHEEL DIA (MM)	TREAD WIDTH (MM)	LOAD CAPACITY (Kg.) Per Pc.	WHEEL MATERIAL	LOAD HEIGHT (MM)	SWIVEL RADIUS (MM)	BRAKE RADIUS (MM)	BEARING	PLATE SIZE (MM) A1XB1 A2XB2	ITEM CODE	MRP/PCS
100	49	240 Kg.	POLY URTHENE (PU)	144	81	129	DERLIN BEARING	118 X 103-11 84 X 71.5	PCW-B73-FX-100-PU-O	1000
									PCW-B73-PL-100-PU-O	1250
									PCW-B73-PK-100-PU-O	1570
125	49	295 Kg.	POLY URTHENE (PU)	165	96	129	DERLIN BEARING	118 X 103-11 84 X 71.5	PCW-B73-FX-125-PU-O	1180
									PCW-B73-PL-125-PU-O	1440
									PCW-B73-PK-125-PU-O	1810
150	49	355 Kg.	POLY URTHENE (PU)	191	115	141	DERLIN BEARING	118 X 103-11 84 X 71.5	PCW-B73-FX-150-PU-O	1340
									PCW-B73-PL-150-PU-O	1585
									PCW-B73-PK-150-PU-O	2000
200	49	385 Kg.	POLY URTHENE (PU)	242	150	150	DERLIN BEARING	118 X 103-11 84 X 71.5	PCW-B73-FX-200-PU-O	1790
									PCW-B73-PL-200-PU-O	2080
									PCW-B73-PK-200-PU-O	2470



Z-73 SERIES HEAVY DUTY



290-505 Kg.

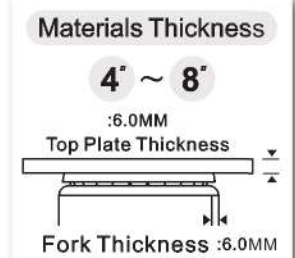
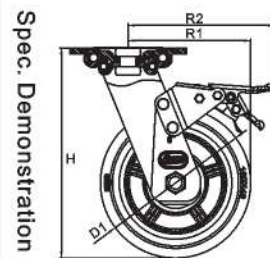
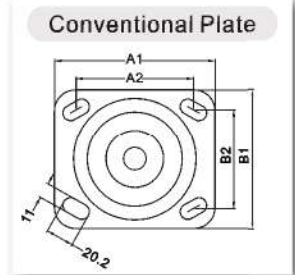
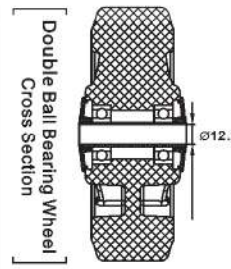

PCW-Z73-FX-100-PC.I.PU-Y



PCW-Z73-PL-150-PC.I.PU-Y



PCW-Z73-PK-200-PC.I.PU-Y

WHEEL DIA (MM)	TREAD WIDTH (MM)	LOAD CAPACITY (Kg.) Per Pc.	WHEEL MATERIAL	LOAD HEIGHT (MM)	SWIVEL RADIUS (MM)	BRAKE RADIUS (MM)	BEARING	PLATE SIZE (MM) A1XB1 A2XB2	ITEM CODE	MRP/PCS
100	48	290 Kg.	CORE IRON POLY URTHENE	144	81	129	DOUBLE BALL BEARING	118 X 103-11 84 X 71.5	PCW-Z73-FX-100-PC.I.PU-Y	1385
									PCW-Z73-PL-100-PC.I.PU-Y	1690
									PCW-Z73-PK-100-PC.I.PU-Y	1945
150	48	440 Kg.	CORE IRON POLY URTHENE	191	115	141	DOUBLE BALL BEARING	118 X 103-11 84 X 71.5	PCW-Z73-FX-150-PC.I.PU-Y	2075
									PCW-Z73-PL-150-PC.I.PU-Y	2360
									PCW-Z73-PK-150-PC.I.PU-Y	2745
200	48	505 Kg.	CORE IRON POLY URTHENE	242	150	150	DOUBLE BALL BEARING	118 X 103-11 84 X 71.5	PCW-Z73-FX-200-PC.I.PU-Y	2595
									PCW-Z73-PL-200-PC.I.PU-Y	2980
									PCW-Z73-PK-200-PC.I.PU-Y	3240



Z-73 SERIES HEAVY DUTY



280-450 Kg.

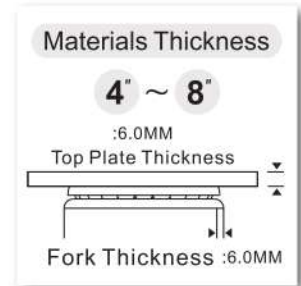
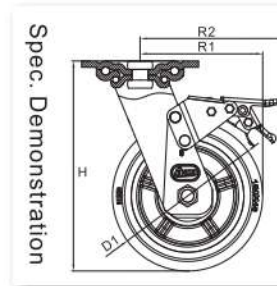
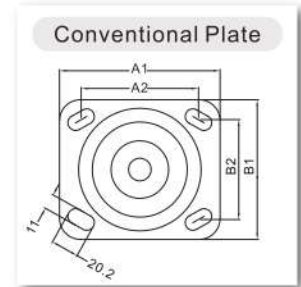

PCW-Z73-FX-100-PP-M



PCW-Z73-PL-150-PP-M



PCW-Z73-PK-200-PP-M

WHEEL DIA (MM)	TREAD WIDTH (MM)	LOAD CAPACITY (Kg.) Per Pc.	WHEEL MATERIAL	LOAD HEIGHT (MM)	SWIVEL RADIUS (MM)	BRAKE RADIUS (MM)	BEARING	PLATE SIZE (MM) A1XB1 A2XB2	ITEM CODE	MRP/PCS
100	50	280 Kg.	POLY PROPYLENE (PP)	144	81	129	DOUBLE BALL BEARING	118 X 103-11 84 X 71.5	PCW-Z73-FX-100-PP-M	890
									PCW-Z73-PL-100-PP-M	1090
									PCW-Z73-PK-100-PP-M	1490
150	50	420 Kg.	POLY PROPYLENE (PP)	191	115	141	DOUBLE BALL BEARING	118 X 103-11 84 X 71.5	PCW-Z73-FX-150-PP-M	1080
									PCW-Z73-PL-150-PP-M	1280
									PCW-Z73-PK-150-PP-M	1700
200	50	450 Kg.	POLY PROPYLENE (PP)	242	150	150	DOUBLE BALL BEARING	118 X 103-11 84 X 71.5	PCW-Z73-FX-200-PP-M	1400
									PCW-Z73-PL-200-PP-M	1590
									PCW-Z73-PK-200-PP-M	2200



BA1- SERIES HEAVY DUTY



130-250 Kg.



Trapezoidal Plate Optional

1.6" ~ 3"

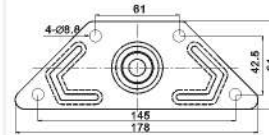

Materials Thickness

1.6" ~ 3"

3.0MM

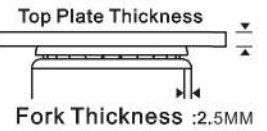

European Plate Optional

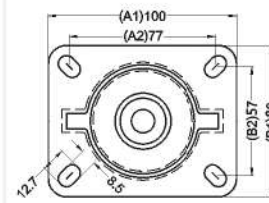

Conventional Plate

1.6" / 2"

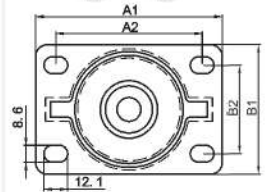

PCW-BA1-FX-40-PA-B



PCW-BA1-HO-50-PA-B



PCW-BA1-PL-75-PA-B

WHEEL DIA (MM)	TREAD WIDTH (MM)	LOAD CAPACITY (Kg.) Per Pc.	WHEEL MATERIAL	LOAD HEIGHT (MM)	SWIVEL RADIUS (MM)	BRAKE RADIUS (MM)	BEARING	PLATE SIZE (MM) A1XB1 A2XB2	ITEM CODE	MRP/PCS
40	45	130 Kg.	PLASTIC NYLON	62	44		DERLIN BEARING	95 X 66.5 X 8.5	PCW-BA1-FX-40-PA-B	270
									PCW-BA1-PL-40-PA-B	410
50	45	150 Kg.	PLASTIC NYLON	72	49		DERLIN BEARING	95 X 66.5 X 8.5	PCW-BA1-FX-50-PA-B	310
									PCW-BA1-PL-50-PA-B	420
									PCW-BA1-HO-50-PA-B	410
63	45	200 Kg.	PLASTIC NYLON	85	56.5		DERLIN BEARING	95 X 66.5 X 8.5	PCW-BA1-FX-63-PA-B	370
									PCW-BA1-PL-63-PA-B	480
75	45	250 Kg.	PLASTIC NYLON	98	63.5		DERLIN BEARING	95 X 66.5 X 8.5	PCW-BA1-FX-75-PA-B	440
									PCW-BA1-PL-75-PA-B	620



BA2- SERIES HEAVY DUTY



300-800 Kg.



Materials Thickness

2" ~ 4"

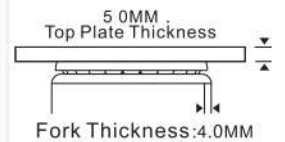

Conventional Plate

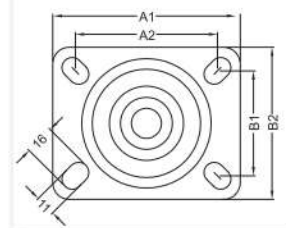

American Type Plate Optional

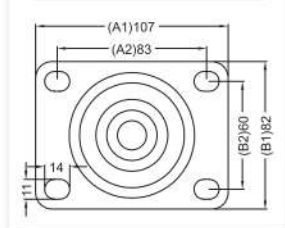

PCW-BA2-FX-50-PA-B



PCW-BA2-PL-63-PA-B



PCW-BA2-PK-75-PA-B

WHEEL DIA (MM)	TREAD WIDTH (MM)	LOAD CAPACITY (Kg.) Per Pc.	WHEEL MATERIAL	LOAD HEIGHT (MM)	SWIVEL RADIUS (MM)	BRAKE RADIUS (MM)	BEARING	PLATE SIZE (MM) A1XB1 A2XB2	ITEM CODE	MRP/PCS
50	50	300 Kg.	PLASTIC NYLON	83	52	94	DOUBLE BALL BEARING	101.5 X 82.5-11 76.5 X 56.5	PCW-BA2-FX-50-PA-B	580
									PCW-BA2-PL-50-PA-B	750
									PCW-BA2-PK-50-PA-B	880
63	50	400 Kg.	PLASTIC NYLON	96	58	98	DOUBLE BALL BEARING	101.5 X 82.5-11 76.5 X 56.5	PCW-BA2-FX-63-PA-B	850
									PCW-BA2-PL-63-PA-B	1010
									PCW-BA2-PK-63-PA-B	1180
75	50	500 Kg.	PLASTIC NYLON	108	68	108	DOUBLE BALL BEARING	101.5 X 82.5-11 76.5 X 56.5	PCW-BA2-FX-75-PA-B	950
									PCW-BA2-PL-75-PA-B	1160
									PCW-BA2-PK-75-PA-B	1320
100	50	800 Kg.	PLASTIC NYLON	136.5	86	-	DOUBLE BALL BEARING	101.5 X 82.5-11 76.5 X 56.5	PCW-BA2-FX-100-PA-B	1300
									PCW-BA2-PL-100-PA-B	1450



ZB1- SERIES



85-115 Kg.



CONDUCTIVE WHEELS

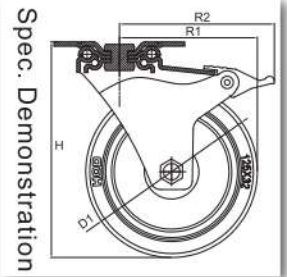

Trapezoidal Plate Optional

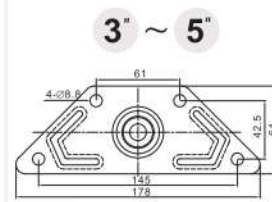

Conventional Plate

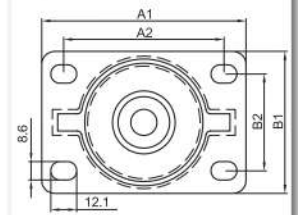

PCW-ZB1-FX-75-TPR-G

PCW-ZB1-PL-100-TPR-G

PCW-ZB1-PK-125-TPR-G

PCW-ZB1-TH-125-TPR-G

PCW-ZB1-TK-125-TPR-G

WHEEL DIA (MM)	TREAD WIDTH (MM)	LOAD CAPACITY (Kg.) Per Pc.	WHEEL MATERIAL	LOAD HEIGHT (MM)	SWIVEL RADIUS (MM)	BRAKE RADIUS (MM)	BEARING	PLATE SIZE (MM) A1XB1 A2XB2	ITEM CODE	MRP/PCS
75	32	85 Kg.	THERMO PLASTIC RUBBER (TPR)	106	72.5	102	ANNULAR BEARING	95 X 66.5 8.5	PCW-ZB1-FX-75-TPR-G	850
									PCW-ZB1-PL-75-TPR-G	980
									PCW-ZB1-PK-75-TPR-G	1070
									PCW-ZB1-TH-75-TPR-G	980
									PCW-ZB1-TK-75-TPR-G	1070
100	32	100 Kg.	THERMO PLASTIC RUBBER (TPR)	131	85	107	ANNULAR BEARING	95 X 66.5 8.5	PCW-ZB1-FX-100-TPR-G	1070
									PCW-ZB1-PL-100-TPR-G	1190
									PCW-ZB1-PK-100-TPR-G	1280
									PCW-ZB1-TH-100-TPR-G	1190
									PCW-ZB1-TK-100-TPR-G	1280
125	32	115 Kg.	THERMO PLASTIC RUBBER (TPR)	157	100.5	113	ANNULAR BEARING	95 X 66.5 8.5	PCW-ZB1-FX-125-TPR-G	1280
									PCW-ZB1-PL-125-TPR-G	1400
									PCW-ZB1-PK-125-TPR-G	1490
									PCW-ZB1-TH-125-TPR-G	1400
									PCW-ZB1-TK-125-TPR-G	1490



BC1- SERIES MEDIUM DUTY



100-150 Kg.



HIGH TEMP. WHEEL



Derlin Wheel Bearing



Spec. Demonstration

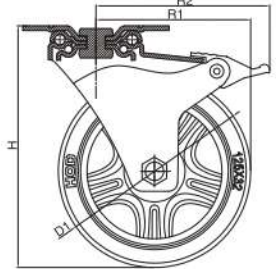

Conventional Plate

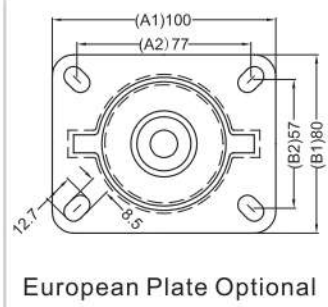
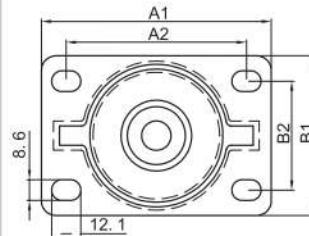

European Plate Optional



PCW-BC1-FX-75-HT-NY-B



PCW-BC1-PL-100-HT-NY-B



PCW-BC1-PK-125-HT-NY-B

WHEEL DIA (MM)	TREAD WIDTH (MM)	LOAD CAPACITY (Kg.) Per Pc.	WHEEL MATERIAL	LOAD HEIGHT (MM)	SWIVEL RADIUS (MM)	BRAKE RADIUS (MM)	BEARING	PLATE SIZE (MM) A1XB1 A2XB2	ITEM CODE	MRP/PCS
75	32	100 Kg.	NYLON	106	72.5	102	DERLIN BEARING	95 X 66.5-8.5 74.5 X 45	PCW-BC1-FX-75-HT-NY-B	470
									PCW-BC1-PL-75-HT-NY-B	600
									PCW-BC1-PK-75-HT-NY-B	680
100	32	115 Kg.	NYLON	131	85	107	DERLIN BEARING	95 X 66.5-8.5 74.5 X 45	PCW-BC1-FX-100-HT-NY-B	660
									PCW-BC1-PL-100-HT-NY-B	790
									PCW-BC1-PK-100-HT-NY-B	880
125	32	150 Kg.	NYLON	157	100.5	113	DERLIN BEARING	95 X 66.5-8.5 74.5 X 45	PCW-BC1-FX-125-HT-NY-B	915
									PCW-BC1-PL-125-HT-NY-B	1050
									PCW-BC1-PK-125-HT-NY-B	1130



GE-3- SERIES SRT



160-260 Kg.



716

Foaming ■+■

Spec. Demonstration

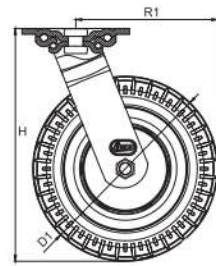

Conventional Plate

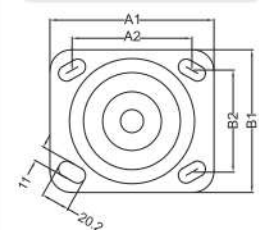

PCW-GE3-FX-150-SRT-BR



PCW-GE3-PL-200-SRT-BR



PCW-GE3-PK-250-SRT-BR

WHEEL DIA (MM)	TREAD WIDTH (MM)	LOAD CAPACITY (Kg.) Per Pc.	WHEEL MATERIAL	LOAD HEIGHT (MM)	SWIVEL RADIUS (MM)	BRAKE RADIUS (MM)	BEARING	PLATE SIZE (MM) A1XB1 A2XB2	ITEM CODE	MRP/PCS
150	57	160 Kg.	FOAMING RUBBER	190	116	163	DOUBLE BALL BEARING	115X100 11 84 X 71.5	PCW-GE3-FX-150-SRT-BR	1880
									PCW-GE3-PL-150-SRT-BR	2150
									PCW-GE3-PK-150-SRT-BR	2400
									PCW-E3-150X57-SRT-BR-WH	
200	64	210 Kg.	FOAMING RUBBER	250	153	189	DOUBLE BALL BEARING	115X100 11 84 X 71.5	PCW-GE3-FX-200-SRT-BR	2550
									PCW-GE3-PL-200-SRT-BR	2800
									PCW-GE3-PK-200-SRT-BR	3100
									PCW-E3-200X64-SRT-BR-WH	
250	70	260 Kg.	FOAMING RUBBER	295	186	202	DOUBLE BALL BEARING	115X100 11 84 X 71.5	PCW-GE3-FX-250-SRT-BR	3350
									PCW-GE3-PL-250-SRT-BR	3480
									PCW-GE3-PK-250-SRT-BR	3900
									PCW-E3-250X70-SRT-BR-WH	



GG-3- SERIES PRT



160-220 Kg.



726

Pneumatic ■

Double Ball Bearing Wheel
Cross Section

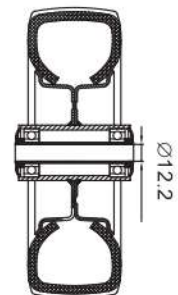

Spec. Demonstration

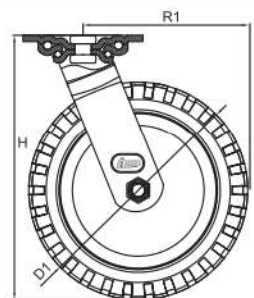

PCW-GG3-FX-200-PRT-BR



PCW-GG3-PL-250-PRT-BR

 WHEEL DIA (MM)	 TREAD WIDTH (MM)	 LOAD CAPACITY (Kg.) Per Pc.	 WHEEL MATERIAL	 LOAD HEIGHT (MM)	 SWIVEL RADIUS (MM)	 BRAKE RADIUS (MM)	 BEARING	 PLATE SIZE (MM) A1XB1 A2XB2	 ITEM CODE	 MRP/PCS
200	64	160 Kg.	PNEUMATIC RUBBER	258	156	-	DOUBLE BALL BEARING	115X100 11 84 X 71.5	PCW-GG3-FX-200-PRT-BR	2750
									PCW-GG3-PL-200-PRT-BR	2950
									PCW-G3-200X64-PRT-BR-WH	
250	88	220 Kg.	PNEUMATIC RUBBER	308	195	-	DOUBLE BALL BEARING	115X100 11 84 X 71.5	PCW-GG3-FX-250-PRT-BR	3700
									PCW-GG3-PL-250-PRT-BR	3900
									PCW-G3-250X88-PRT-BR-WH	



NH4- SERIES



70-90 Kg.

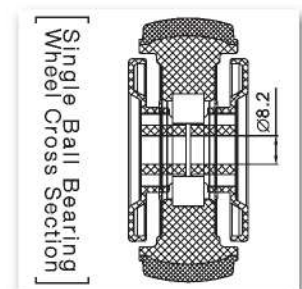
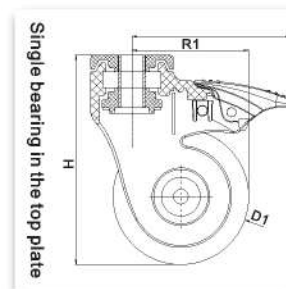
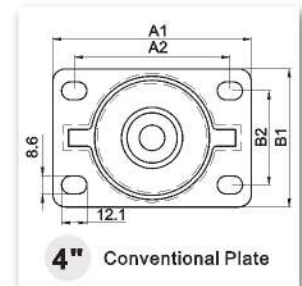
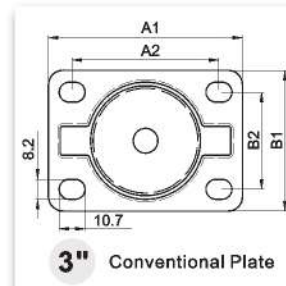

PCW-NH4-PL-75-TPR-G



PCW-NH4-PK-75-TPR-G



PCW-NH4-TH-100-TPR-G



PCW-NH4-TK-100-TPR-G

WHEEL DIA (MM)	TREAD WIDTH (MM)	LOAD CAPACITY (Kg.) Per Pc.	WHEEL MATERIAL	LOAD HEIGHT (MM)	SWIVEL RADIUS (MM)	BRAKE RADIUS (MM)	BEARING	PLATE SIZE (MM) A1XB1 A2XB2	ITEM CODE	MRP/PCS
75	28	70 Kg.	PLASTIC	130	74.5	87.5	SINGLE BALL BEARING	80 X 58 8.2	PCW-NH4-PL-75-TPR-G	660
									PCW-NH4-PK-75-TPR-G	710
									PCW-NH4-TH-75-TPR-G	660
									PCW-NH4-TK-75-TPR-G	710
100	28	90 Kg.	PLASTIC	161	92	108.5	SINGLE BALL BEARING	95 X 66.5 8.6	PCW-NH4-PL-100-TPR-G	840
									PCW-NH4-PK-100-TPR-G	880
									PCW-NH4-TH-100-TPR-G	840
									PCW-NH4-TK-100-TPR-G	880



H6 - TWIN WHEEL-MEDICAL CASTER (HEAVY DUTY)



70-110 Kg.

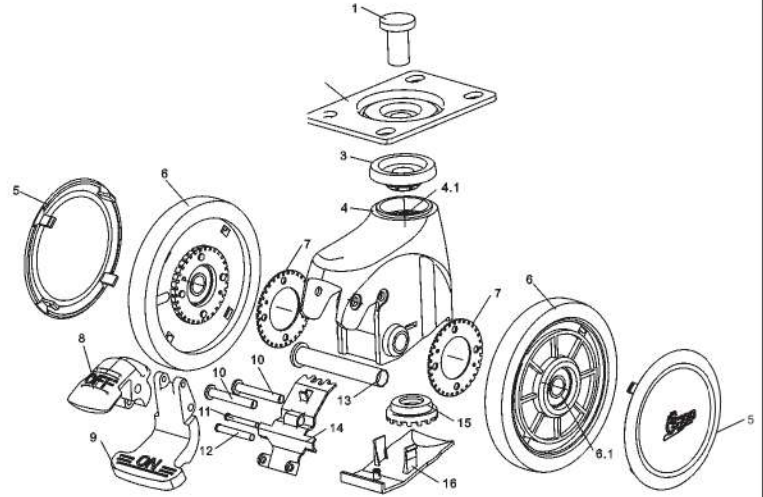

PCW-TW-H6-PL-75-PU-G



PCW-TW-H6-PK-75-PU-G



PCW-TW-H6-TH-100-PU-G



PCW-TW-H6-TK-125-PU-G

WHEEL DIA (MM)	TREAD WIDTH (MM)	LOAD CAPACITY (Kg.) Per Pc.	WHEEL MATERIAL	LOAD HEIGHT (MM)	SWIVEL RADIUS (MM)	BRAKE RADIUS (MM)	BEARING	PLATE SIZE (MM) A1XB1 A2XB2	ITEM CODE	MRP/PCS
75	57	70 Kg.	NYLON + POLY URTHENE	98	60	87	TRIPAL BALL BEARING	70 X 58 8.5	PCW-TW-H6-PL-75-PU-G	590
									PCW-TW-H6-PK-75-PU-G	650
									PCW-TW-H6-TH-75-PU-G	590
									PCW-TW-H6-TK-75-PU-G	650
100	63	90 Kg.	NYLON + POLY URTHENE	131	80	110	TRIPAL BALL BEARING	95 X 66 8.6	PCW-TW-H6-PL-100-PU-G	825
									PCW-TW-H6-PK-100-PU-G	910
									PCW-TW-H6-TH-100-PU-G	825
									PCW-TW-H6-TK-100-PU-G	910
125	68	110 Kg.	NYLON + POLY URTHENE	153	99	135.5	TRIPAL BALL BEARING	95 X 66 8.6	PCW-TW-H6-TH-125-PU-G	1030
									PCW-TW-H6-TK-125-PU-G	1100



Z-H7- MEDICAL CASTER



65-100 Kg.



PCW-Z-H7-TH-75-PU-G



PCW-Z-H7-TK-100-PU-G

WHEEL DIA (MM)	TREAD WIDTH (MM)	LOAD CAPACITY (Kg.) Per Pc.	WHEEL MATERIAL	LOAD HEIGHT (MM)	SWIVEL RADIUS (MM)	BRAKE RADIUS (MM)	BEARING	PLATE SIZE (MM) A1XB1 A2XB2	ITEM CODE	MRP/PCS
75	28	85 Kg.	POLY URTHENE	112	69.5	93	DOUBLE BALL BEARING	- -	PCW-Z-H7-TH-75-PU-G	500
									PCW-Z-H7-TK-75-PU-G	600
100	28	100 Kg.	POLY URTHENE	137	84	97	DOUBLE BALL BEARING	- -	PCW-Z-H7-TH-100-PU-G	560
									PCW-Z-H7-TK-100-PU-G	640



PCW-Z-H7-TH-75-TPR-BR



PCW-Z-H7-TK-100-TPR-BR

WHEEL DIA (MM)	TREAD WIDTH (MM)	LOAD CAPACITY (Kg.) Per Pc.	WHEEL MATERIAL	LOAD HEIGHT (MM)	SWIVEL RADIUS (MM)	BRAKE RADIUS (MM)	BEARING	PLATE SIZE (MM) A1XB1 A2XB2	ITEM CODE	MRP/PCS
75	28	65 Kg.	THERMO PLASTIC RUBBER (TPR)	112	69.5	93	DOUBLE BALL BEARING	- -	PCW-Z-H7-TH-75-TPR-BR	540
									PCW-Z-H7-TK-75-TPR-BR	640
100	28	70 Kg.	THERMO PLASTIC RUBBER (TPR)	137	84	97	DOUBLE BALL BEARING	- -	PCW-Z-H7-TH-100-TPR-BR	610
									PCW-Z-H7-TK-100-TPR-BR	680



H9 - TWIN WHEEL MEDICAL CASTER (LIGHT DUTY)



50-90 Kg.

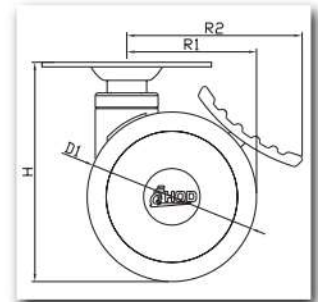

2.5"

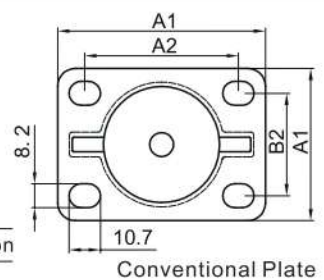
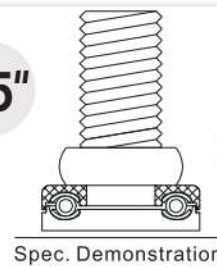

PCW-TW-H9-PL-63-PU-G



PCW-TW-H9-PK-75-PU-G



PCW-TW-H9-TH-100-PU-G



PCW-TW-H9-TK-100-PU-G

WHEEL DIA (MM)	TREAD WIDTH (MM)	LOAD CAPACITY (Kg.) Per Pc.	WHEEL MATERIAL	LOAD HEIGHT (MM)	SWIVEL RADIUS (MM)	BRAKE RADIUS (MM)	BEARING	PLATE SIZE (MM) A1XB1 A2XB2	ITEM CODE	MRP/PCS
63	50	50 Kg.	NYLON + POLY URTHENE	80	49	62	DOUBLE BALL BEARING	71 X 52 8.2	PCW-TW-H9-PL-63-PU-G	320
									PCW-TW-H9-PK-63-PU-G	385
									PCW-TW-H9-TH-63-PU-G	320
									PCW-TW-H9-TK-63-PU-G	385
75	60	70 Kg.	NYLON + POLY URTHENE	90	60	73	DOUBLE BALL BEARING	70 X 58 8.5	PCW-TW-H9-PL-75-PU-G	470
									PCW-TW-H9-PK-75-PU-G	510
									PCW-TW-H9-TH-75-PU-G	470
									PCW-TW-H9-TK-75-PU-G	510
100	63	90 Kg.	NYLON + POLY URTHENE	130	80	100	DOUBLE BALL BEARING	88 X 73 8.5	PCW-TW-H9-PL-100-PU-G	750
									PCW-TW-H9-PK-100-PU-G	830
									PCW-TW-H9-TH-100-PU-G	750
									PCW-TW-H9-TK-100-PU-G	830